

Please read this manual before assembly.

**Please save your Receipt for  
Warranty Registration and save this  
Manual for directions on assembly  
and operation.**

6-volt Rechargeable Battery Powered Ride-on Vehicle

**3-5  
Years Old**



**⚠ WARNING:**  
Assembly by an adult.

**⚠ WARNING:**  
CHOKING HAZARD- Small parts.  
Not for children under 36 months.

**easy 1·2·3  
ASSEMBLY**

Adult Assembly Required  
**(All required tools included!)**

For assistance with your assembly call:  
**1800 224 094** toll-free  
**03 9262 2900** Local

**1**





# Safety

## Warnings and Cautions

### **WARNING:Electrical Hazard**

RISK OF FIRE , DO NOT BYPASS. REPLACE ONLY WITH SAME 15A FUSE.

- Only use Hunter Products approved 6V lead acid battery.
- Only use Hunter Products approved Input 100-240V, 50-60Hz Output 8V, 500mA charger.
- Never modify the electrical system. Changes could cause a fire resulting in serious injury or death, and could also ruin the electrical system.
- Always secure that battery and cover. Failure to do this properly result in injury should the vehicle tip over.
- Never lift or carry the battery by the wires or connectors. This can damage the battery and possibly cause a fire resulting in serious injury or death, Always use the battery holder to carry it.
- The battery can be handled by adults only. The battery is heavy and contains sulfuric acid (electrolyte). Dropping the battery could cause serious injury.
- Children should never be allowed to charge the battery. Charging the battery must be done by adults only. The electricity involved in charging the battery could injure a child.
- The motors will get hot, handle carefully.
- Each time you charge the battery check the battery, charger, and their connectors for excessive wear or damage. Do not use the charger or the battery if damage or excessive wear is detected until you have replaced the worn or damaged parts.

### **WARNING:Riding Hazard**

- Prevent Injuries and Deaths
- Direct Adult Supervision Required At All Times
- Keep Children Within Safe Riding Areas.  
These areas must be:
  - away from swimming pools and other bodies of water to prevent drowning
  - away from steps, driveways, cars, roads and alleys
  - Generally level ground to prevent tip-overs

### **WARNING: Charger**

Changes or modifications to this unit not expressly approved by the party responsible for compliance could void the user's authority to operate the equipment.

**NOTE:** This equipment has been tested and found to comply with the limits for a Class B digital device, pursuant to Part 15 of the FCC Rules. These limits are designed to provide reasonable protection against harmful interference in a residential installation. This equipment generates, uses and can radiate radio frequency energy and, if not installed and used in accordance with the instructions, may cause harmful interference to radio communications.

However, there is no guarantee that interference will not occur in a particular installation. If this equipment does cause harmful interference to radio or television reception, which can be determined by turning the equipment off and on, the user is encouraged to try to correct the interference by one or more of the following measures:

- Reorient or relocate the receiving antenna.
- Increase the separation between the equipment and receiver.
- Connect the equipment into an outlet on a circuit different from that to which the receiver is connected.

Consult the dealer or an experienced radio/TV technician for help.

### **CAUTION:**

- When fully unassembled, this package contains small parts. Adult assembly is required.
- Use the charger in dry areas only.

For assistance with your assembly call:

**1800 224 094**

toll-free

**03 9262 2900**

Local

### **WARNING: Adult Supervision Required**

- Always Teach Safety First
- While most children can develop the physical skills necessary to operate this vehicle, it is important to remember that they do not yet have mature judgment skills. Children should never be allowed to ride this vehicle without adult supervision. Before any child rides this vehicle an adult must evaluate the child's skill levels and abilities to operate the vehicle safely. Even after instruction hazards are not always anticipated or recognized by children. So before any child operates the vehicle teach them appropriate safety rules.
- THERE IS NO SUBSTITUTE FOR DIRECT ADULT SUPERVISION.

### **WARNING: Safe Riding Rules**

- Not to be used in traffic.
- Always wear your helmet.
- Always wear shoes.
- Only one rider at a time.
- Do not operate on loose dirt, sand or gravel.
- Do not operate near drop-offs, bodies of water, or obstructions
- Do not operate in the street or near moving vehicles.
- Do operate on inclines. Use on generally level ground only.
- Do not operate in the dark as unexpected obstacles could cause an accident
- Do not operate on slopes.
- Do not place anything near moving parts such as motors, gears or wheels. Rotating parts can snag hair, fingers, etc. causing serious injury.
- Do not operate near flammable vapors ( such as gasoline, paint thinner, acetone, liquid wax, etc.).
- Do not sit on the rear end of seat, it could cause tip over, sit on the middle of seat when riding.
- Do not shift gears while the vehicle is in motion. Please come to a full stop before switching from Forward to Reverse or Reverse to Forward.

For assistance with your assembly call:

**1800 224 094** toll-free  
**03 9262 2900** Local

# Battery

## Charging and Installation

**⚠ CAUTION: The battery and charger are not toys.  
All battery charging must be done by an adult.**

**The battery is located under the seat. Use the provided screwdriver to remove the seat**

- The battery must be charged 18 hours before it's first use. The battery must be in the upright position before charging, and be very careful to avoid any contact to both terminals at the same time.
- To disconnect the battery, squeeze the tabs of the connector and pull. Hold the connectors firmly, and do not pull the wires.
- Connect the battery charging line with the charger connector, then plug the charger into the wall outlet.
- Make sure to only plug the charger into standard 240V wall outlets. Use only the charger supplied. The charger has the rating: Input 100-240V, 50-60Hz Output 8V, 500mA
- You must recharge the battery for 8-12 hours after each time you use the toy. Never charge for more than 16 hours.
- Disconnect the charger from the wall outlet and then the charger from the battery. If you are not going to use the toy for a long period of time, make sure you recharge the battery at least once a month.
- Never lift or carry the battery by the wires or connector, this can cause damage. Lift and carry the battery by the case only.
- Do not charge or store the battery upside down. Charging the battery produces explosive gasses. Make sure to charge the battery away from flames, sparks, and lit cigarettes. Always charge in a well ventilating area.

### CARE:

- Always charge the battery before storing the vehicle for a long period of time. Make sure to charge the battery at least once a month, even if the toy is not being used.
- Never let the battery run down completely before charging.
- Never leave the battery in a discharged condition. It may ruin it.
- Never store the battery in temperatures above 75 °F (28.8 °C) or below 10 °F (12.2 °C)
- Before each charge examine the battery, charger, and their connectors for excessive wear or damage. If you find damage, do not use the battery or charger until you have replaced the worn or damaged part.
- Make sure to return exhausted batteries to an approved lead-acid battery recycler or contact your local authority accordingly.

### DISPOSAL:

- Your vehicle's battery is a sealed lead-acid battery. You must recycle or dispose of it in an environmentally sound manner.
- Never dispose your battery in the regular, household trash. The incineration, land-filling, or mixing of a sealed lead-acid battery with your household trash is prohibited by law in most areas.
- Make sure to return exhausted batteries to an approved lead-acid battery recycler or contact your local authority. Always remove exhausted batteries from your toy. Dispose of dead batteries properly; never burn or bury them.
- To locate a service center, contact your local waste management company.
- Do not mix old and new batteries.
- Do not mix alkaline, standard (carbon-zinc) or rechargeable (nikel-cadmium) batteries.

**For assistance with your assembly call:**  
**1800 224 094** toll-free  
**03 9262 2900** Local

# Parts

# Parts Diagram

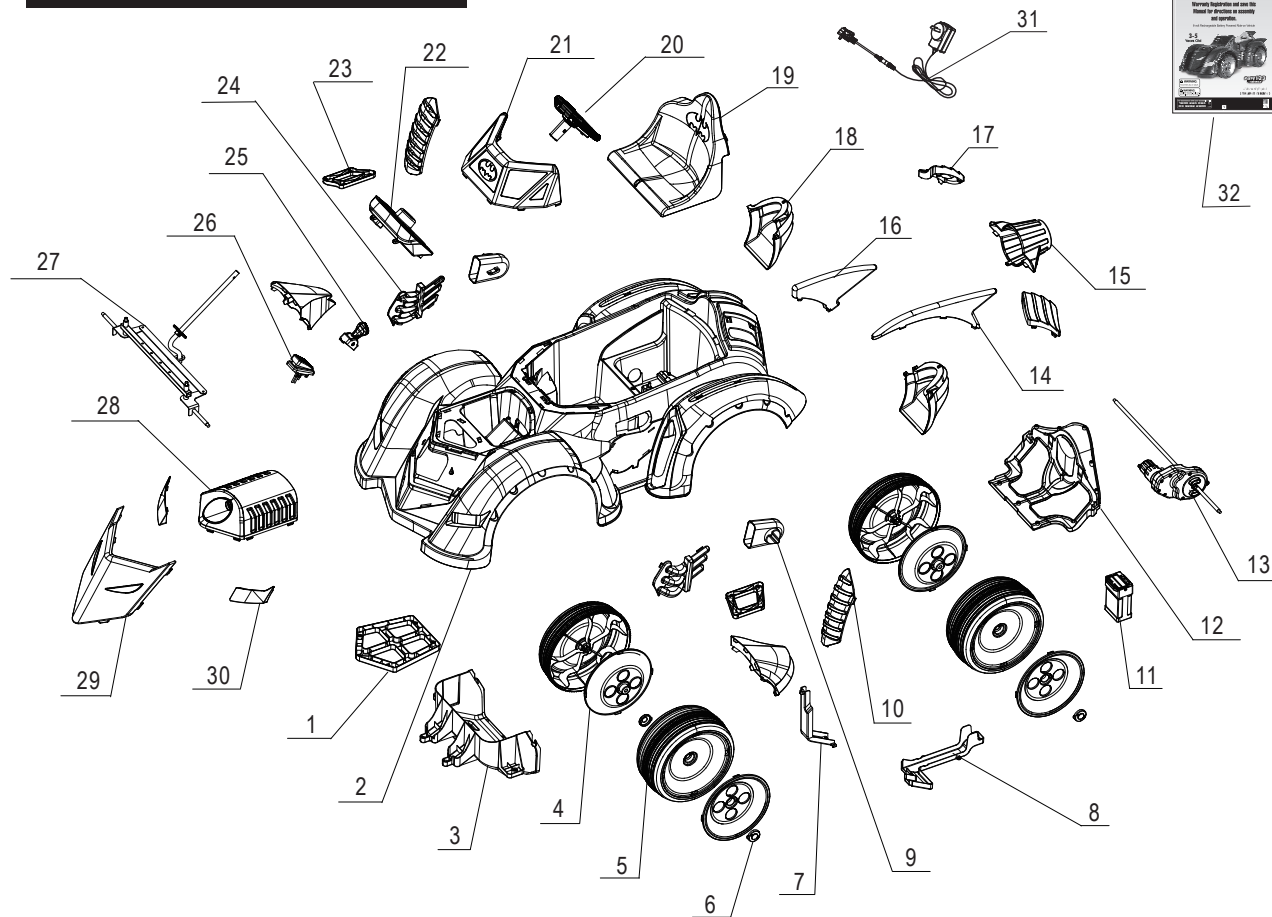

| No. | Description                 | Stock No. |
|-----|-----------------------------|-----------|
| 1   | Front holder                |           |
| 2   | Body                        |           |
| 3   | Pedal bottom cover          |           |
| 4   | Wheel cover                 |           |
| 5   | Front wheel                 |           |
| 6   | Dome                        |           |
| 7   | Wire cover II               |           |
| 8   | Wire cover I                |           |
| 9   | Side decoration II (L/R)    |           |
| 10  | Middle side decoration(L/R) |           |
| 11  | Battery                     |           |
| 12  | Rear holder                 |           |
| 13  | Gearbox                     |           |
| 14  | Rear wing side (L/R)        |           |
| 15  | Exhaust pipe                |           |
| 16  | Rear wing                   |           |
| 17  | Rear decoration cover (L/R) |           |
| 18  | Rear side decoration (L/R)  |           |
| 19  | Seat                        |           |
| 20  | Steering wheel cover        |           |
| 21  | Windshield                  |           |
| 22  | Dash board                  |           |
| 23  | Side holder                 |           |
| 24  | Side decoration I (L/R)     |           |
| 25  | Shifter switch              |           |
| 26  | Pedal switch                |           |
| 27  | Steering                    |           |
| 28  | Engine cover                |           |
| 29  | Front face                  |           |
| 30  | Eye I (L/R)                 |           |
| 31  | Charger                     |           |
| 32  | Service manual              |           |

For assistance with your assembly call:

**1800 224 094**

toll-free

**03 9262 2900**

Local



# Parts

## INSTALLMENT PARTS

- |                  |     |               |      |
|------------------|-----|---------------|------|
| • Body           | 1PC | • Front Wheel | 2PCS |
| • Product manual | 1PC | • Rear Wheel  | 2PCS |
| • Charger        | 1PC | • Left Wing   | 1PC  |
| • Rear Wing      | 1PC | • Right Wing  | 1PC  |
| • Wrench Tool    | 1PC |               |      |

## SPECIFICATION

|              |   |
|--------------|---|
| Battery      | 6V 5 AH   |
| Motor        | 6V 20W  |
| Charger      | Input 100-240V, 50-60Hz, Output 8V 500mA        |
| Maxmium load | 55lbs(25KG)                                     |
| Work Time    | Recharge 8-12h,Use for 1-2h                     |
| Speed        | Forward max speed 4kph. Reverse max speed 4kph. |
| Age          | 3 to 5 years old.                               |

For assistance with your assembly call:  
**1800 224 094** toll-free  
**03 9262 2900** Local



# Assembly Instructions

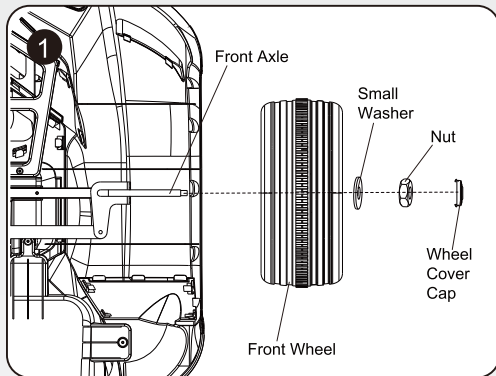

## Install Front Wheel

Remove the nut from the front axle using the wrench provided. Pull off the small washer. Place the front wheel on the axle. Replace the small washer and nut on the wheel and then tighten. Add the wheel cover cap over the nut as shown in Diagram 1. Repeat this on opposite side.

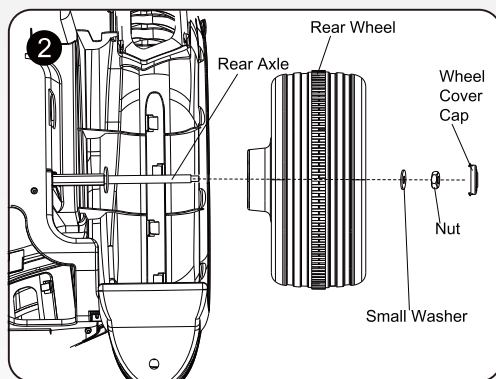

## Install Rear Wheel(Left)

Slide the rear wheel onto the axle. Replace the small washer and nut onto axle and tighten nut securely with the wrench provided. Align the wheel cover cap with wheel cover and apply pressure until snapped into place. Diagram 2.

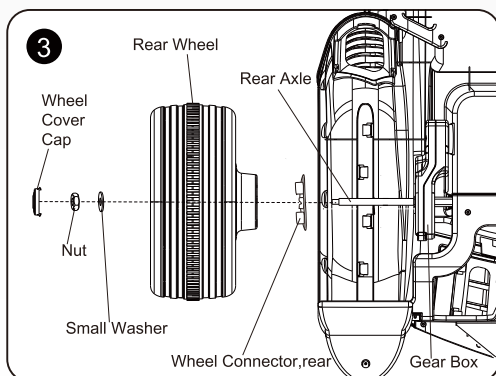

## Install Rear Wheel(Right)

Slide the wheel connector onto the axle first to make the indicated side outward as shown. Then slide the Wheel onto the axle and align Wheel with Gear Box. Replace the Washer and Nut onto axle and tighten Nut securely with the wrench provided. Align the Wheel Cover Cap with Wheel Cover and apply pressure until snapped into place. Diagram 3.

For assistance with your assembly call:  
**1800 224 094** toll-free  
**03 9262 2900** Local



# Assembly Instructions

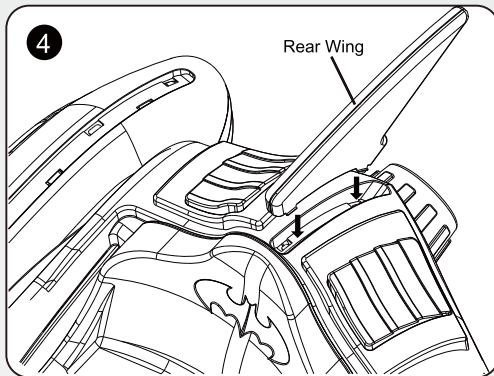

## Install Rear Wing

Make sure the hooks on the Rear Wing plate align with slots on the body and snap into place, you will hear a solid click when the Rear Wing plate is correctly fitted. Diagram 4.

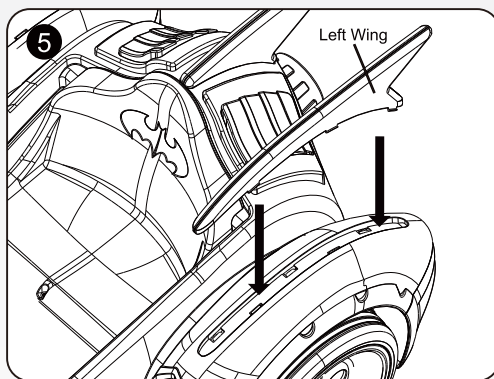

## Install Left Wing

Make sure the hooks on the Left Wing plate align with slots on the body and snap into place, you will hear a solid click when the Left Wing plate is correctly fitted. Diagram 5. Repeat this on right side.

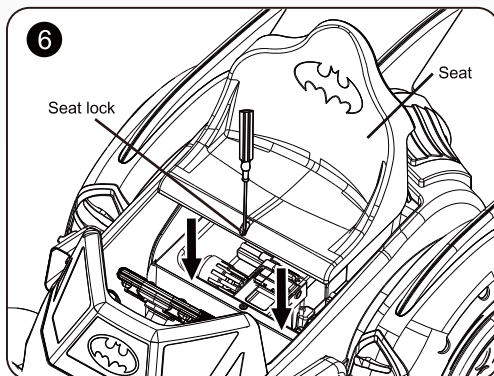

## Seat Cushion Mounting

To take down the seat. Use the equipped screwdriver to unscrew the screw on the seat, then the seat will be take down.

To install the seat. Put the snap joint of the seat direct to the slot cover on the body, confirm that the seat is firmly in the correct position and tighten the screw with the equipped screwdriver. Diagram 6.

For assistance with your assembly call:  
**1800 224 094** toll-free  
**03 9262 2900** Local

# Assembly Instructions

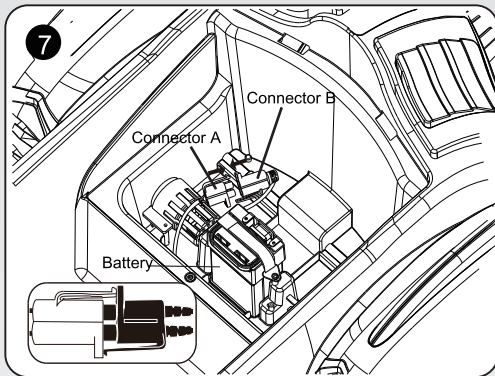

## Install Battery Connector

Identify the battery connector and power cable. Align them correctly so the positive and negative connections are lined up and press the connectors together. Do not force the connection, if they don't go together smoothly check your alignment assuring that positive is connecting to positive and negative is to negative. Diagram 7.

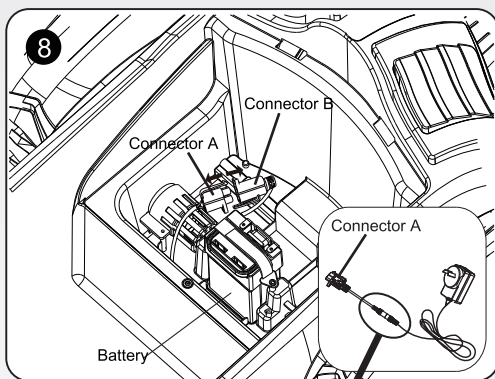

## Recharging the Battery

Remove the seat as shown in Diagram 6. Disconnect the battery connector from the power cable and then connect the battery connector to the charger. The red light on showing the battery is charging. The red light will show while battery is charging. Stop recharging after 8-12 hours. After recharging reconnect the battery connector to the cable line connector and reconnect the seat. Diagram 8.

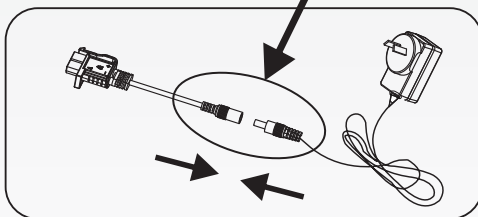

**Note:** Connect the cable to the charger as left diagram.

For assistance with your assembly call:  
**1800 224 094** toll-free  
**03 9262 2900** Local

# Battery Instructions

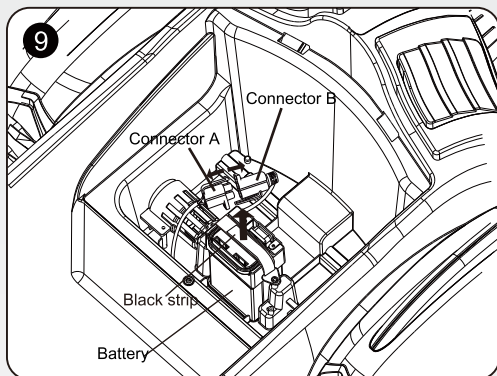

## Changing the Battery

Remove the seat as shown in Diagram 6. Disconnect the battery connections. Never lift the battery using the connectors. Then loosen the black stripe on battery and take out the battery. Place new battery inside and reconnect battery connections. Reinstall the seat as shown in Diagram 6.

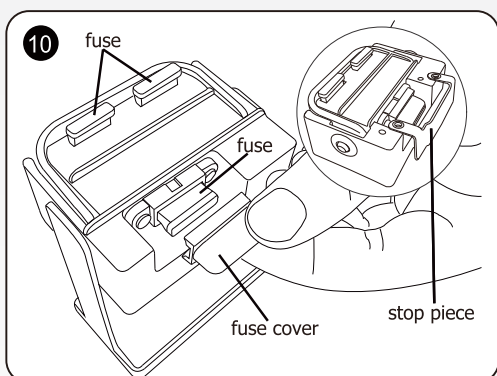

## Changing fuse

To change the fuse disconnect the battery connectors. Remove the fuse stop piece on battery with screwdriver. Then take off the fuse cover. Remove the bad or damaged fuse and replace with provided identical fuse. Finally close the fuse cover and install the stop piece as shown in Diagram 10.

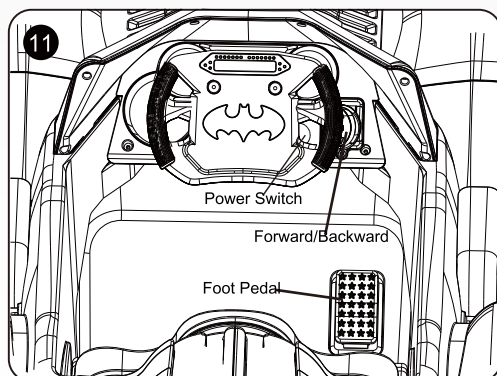

## Operation Controls

Make sure draver is correctly sitting in the seat. Press the power switch. Adjust the shifter into the Forward or reverse position and press the pedal with foot to move vehicle. Diagram 11.

For assistance with your assembly call:  
**1800 224 094** toll-free  
**03 9262 2900** Local

# Maintenance

# Vehicle Care

Check all screws, cap nuts and protective coverings regularly and tighten as required. Check plastic parts on a regular basis for cracks or broken pieces.

This product should be checked by adult before use and be used only under constant adult supervision.

During snow or rainy weather, the vehicle should be stored inside or under a protective cover. Remember to charge the battery at least once per month while your vehicle is not in regular use.

Avoid operating the vehicle in wet or snowy conditions and do not spray the vehicle with a hose. Do not wash the vehicle with soap and water. Water or moisture in the motors or electrical switches can cause them to corrode and could cause switch or motor failure.

Avoid operating the vehicle on sand, loose dirt or gravel. sand, loose dirt or gravel in the motors or electrical switches can cause them to jam and could cause switch or motor failure.

The vehicle can be wiped down with a soft, dry cloth. For a shiny finish, you can wipe plastic parts with a non-wax furniture polish applied to a soft-cloth. Do not use automotive wax. Do not use soap and water or spray the vehicle with a hose.

The car should have its power switched to off when not in use and it is advised that the battery should be disconnected if the unit will not be used for a long period of time.



For assistance with your assembly call:

**1800 224 094** toll-free  
**03 9262 2900** Local

# Problem & Solution

| PROBLEM                        | ANALYZE                              | SOLUTION   |
|--------------------------------|--------------------------------------|--|
| Car doesn't work               | • Low power                          | Recharge the battery   |
|                                | • Blown Fuse                         | Replace the blown fuse with the same type and value fuse   |
|                                | • Lost wheel nut                     | Replace the nut with the correct size and tighten  |
|                                | • Loose battery connection           | Re-fit and tighten the connector, or if damaged replace the connector  |
|                                | • Exhaust & bad battery              | Replace with a new battery from Hunter Products  |
|                                | • Damage on electrical parts         | Contact Hunter Products at <a href="mailto:enquiries@hunterproducts.com.au">enquiries@hunterproducts.com.au</a> or call 1800 224 094 |
|                                | • Damage on motor                    | Contact Hunter Products at <a href="mailto:enquiries@hunterproducts.com.au">enquiries@hunterproducts.com.au</a> or call 1800 224 094 |
| Battery can't be recharged     | • Loose battery connection           | Re-fit and tighten the connector, or if damaged replace the connector  |
|                                | • No power to charger                | Check if charger is plugged in and is properly connected to the battery connector  |
|                                | • Loose battery connection           | Replace the charger with a new unit from BallardPacific  |
| Short of run time              | • Battery charge is low              | Recharge the battery fully   |
|                                | • Battery is old                     | Replace with a new battery from Hunter Products  |
| Noise & Heat during recharge   | • Some heat and noise is normal      | No action needed   |
| Low Speed                      | • Old battery                        | Use new battery  |
|                                | • Low power                          | Recharge the battery fully   |
|                                | • Over burdened                      | Do not exceed max weight of 55lbs or (25Kg)  |
|                                | • Not used on flat surfaces          | The car is designed for relatively flat surfaces   |
| Gear box is noisy              | • Gear box is damaged                | Contact Hunter Products at <a href="mailto:enquiries@hunterproducts.com.au">enquiries@hunterproducts.com.au</a> or call 1800 224 094 |
|                                | • Motor is damaged                   | Contact Hunter Products at <a href="mailto:enquiries@hunterproducts.com.au">enquiries@hunterproducts.com.au</a> or call 1800 224 094 |
| Car vibrates or shakes         | • Problem with motor wire connection | Carefully check connections and tighten as needed  |
|                                | • Problem with motor                 | Contact Hunter Products at <a href="mailto:enquiries@hunterproducts.com.au">enquiries@hunterproducts.com.au</a> or call 1800 224 094 |
| No sound or light when running | • Loose sound & light wire           | Carefully check connections and tighten as needed  |
|                                | • Light control is damaged           | Contact Hunter Products at <a href="mailto:enquiries@hunterproducts.com.au">enquiries@hunterproducts.com.au</a> or call 1800 224 094 |
| Car wont stop while running    | • Electrical malfunction             | Contact Hunter Products at <a href="mailto:enquiries@hunterproducts.com.au">enquiries@hunterproducts.com.au</a> or call 1800 224 094 |

For assistance with your assembly call:  
**1800 224 094** toll-free  
**03 9262 2900** Local



# One-Year Limited Warranty

Hunter Products warrants that your 6V Batmobile will be free from defects in materials and workmanship for the vehicle (except for the 6-volt battery) for a period of 12 months, from the date of purchase. This warranty only applies where the product is completely and correctly assembled and used in accordance with all accompanying recommendations and user's instructions. This warranty is in addition to your rights under the Australia Consumer Law.

Hunter Products, at its option will provide you with a refund or replacement parts for this product if the 6V Batmobile becomes defective within the warranty period. Hunter Products will bear the reasonable expense of claiming the warranty. This warranty will no longer apply where the defect is a result of an accident, misuse, abuse, neglect or other causes not arising out of defects in materials or workmanship, nor does it cover damages arising out of damages arising out of service by other than an authorised service person.

Our goods come with guarantees that cannot be excluded under the Australian Consumer Law. You are entitled to a replacement or refund for a major failure and for compensation for any other reasonably foreseeable loss or damage. You are also entitled to have the goods repaired or replaced if the goods fail to be of acceptable quality and the failure does not amount to a major failure.

Where a failure does not amount to a major failure, we are entitled to choose between providing you with a repair, replacement or refund. To obtain compensation, you would need to provide documentary evidence of the loss or damage suffered, and documentary evidence that such loss or damage was a reasonably foreseeable consequence of a failure by us to comply with a consumer guarantee under the Australian Consumer Law. Such evidence may include photographs, statutory declarations, receipts or reports (e.g. from your doctor), depending on the loss or damage.

In addition to all rights and remedies to which you may be entitled under the Competition and Consumer Act 2010 (Commonwealth) and any other relevant legislation, the manufacturer warrants this product to be free from defects in materials or workmanship for a period as stated on the packaging from the date of purchase.

To claim under this warranty, you will need to bring the product to the store of purchase, along with proof of purchase (typically this will be a receipt). Any cost incurred by you in bringing the product to the service desk will be borne by you. We will then, at our option, either repair or replace the product or refund your money and take back the product.

Our liability under this manufacturer's warranty is subject to us being satisfied that a defect was caused by defective workmanship or materials, and was not caused by or substantially contributed to by other factors, or circumstances beyond our control, including (but not limited to) defective installation, maintenance or repair, alteration or modification of the product in any manner not recommended by the manufacturer or any neglect, misuse or excessive use.

The benefits conferred by this manufacturer's warranty are in addition to all rights and remedies conveyed by the Competition and Consumer Act 2010 (Commonwealth), and any other statutory rights to which you may already be entitled, and this warranty does not exclude, restrict or modify any such rights or remedies that are implied by law.

## HUNTER PRODUCTS

Level 2, 424 Warrigal Road Moorabbin, Victoria, 3189.

1800 224 094 Toll-Free

03 9262 2900 Local

Email: [enquiries@hunterproducts.com.au](mailto:enquiries@hunterproducts.com.au)

## For Service and Repairs

If your product requires service, repairs or replacement parts, please visit us online at [www.electricrideon.com.au](http://www.electricrideon.com.au)

Or contact us at: Toll Free Service Phone: 1800 224 094 e-mails: [enquiries@hunterproducts.com.au](mailto:enquiries@hunterproducts.com.au)

Hours: 9.00 AM - 5.00 PM (AEST), Monday - Friday

For assistance with your assembly call:

**1800 224 094** toll-free  
**03 9262 2900** Local

# Product Registration

## Note:

Activation of your warranty gives you FREE telephone and online technical service help. Please fill out registration below and mail with your sales receipt to:

**HUNTER PRODUCTS**

**Level 2, 424 Warrigal Road Moorabbin, Victoria, 3189.**



Hunter  
Products

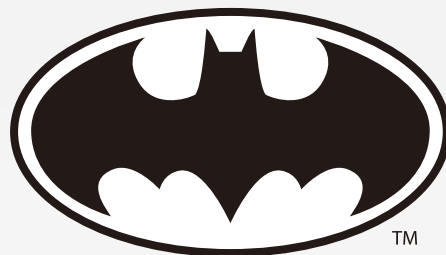

For a record of your purchase fill in immediately and send to:  
**HUNTER PRODUCTS**  
Level 2, 424 Warrigal Road Moorabbin, Victoria, 3189.



**Owners Name:** \_\_\_\_\_ (PLEASE PRINT)

**Address:** \_\_\_\_\_ (PLEASE PRINT)

**City:** \_\_\_\_\_ **State:** \_\_\_\_\_ **Postcode:** \_\_\_\_\_

**Tel:** \_\_\_\_\_ **E-mail:** \_\_\_\_\_

**Date Purchased:** \_\_\_\_\_ **Place of Purchase:** \_\_\_\_\_

**Model Name:** \_\_\_\_\_

**Serial Number:** \_\_\_\_\_

**For assistance with your assembly call:**  
**1800 224 094** toll-free  
**03 9262 2900** Local





**Call us Toll-Free at  
1800 224 094 or Local  
at 03 9262 2900 for  
assistance and information  
from our trained technical staff.**

**CAUTION-CHARGER IS ELECTRICALLY OPERATED PRODUCT:  
Not recommended for children under 3 years of age. As with  
all electric products, precautions should be observed during  
handling and use to prevent electric shock.**

**For assistance with your assembly call:**  
**1800 224 094** toll-free  
**03 9262 2900** Local

