

Troubleshooting - Continued

Problem	Possible Cause	Solution
Scooter makes loud noise when in use	1. Chain is dry (on chain drive models)	1. Lubricate chain with light oil.
Scooter will not run when Switch is pressed.	1. Poor contact of wires or connectors 2. "Dead Spot" on motor	1. Check that the battery connectors are firmly plugged into each other. 2. A dead spot means the electric power is not being delivered to the terminal connection and the scooter needs repair.
Loud grinding or clicking noises coming from motor or gear box	1. Drive Wheel is partially engaged	1. Check drive wheel - to motor engagement.
Battery will not recharge	1. Battery connector or adapter connector is loose 2. Charger not plugged in 3. Charger is not working 4. Battery is dead	1. Check that the battery connectors are firmly plugged into each other. 3. Check that the battery charger is plugged into a working wall outlet. 4. Replace battery
Charger feels warm when recharging	1. This is normal and not a cause for concern	1. If excessively hot, unplug and replace.

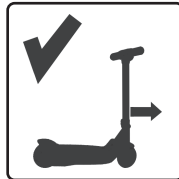

PEEWEE

WARNING:

Prior to first use, please charge the scooter for 14 hours. This step is critical for your scooter to operate correctly. Once the battery has been fully charged it is ready for use. For all other recharges, the battery should be charged for up to 9 hours or until LED light changes to green. The scooter should be recharged after each use. The scooter should be switched off using the on/off power switch after each use. The battery must be recharged at least once a month even when the scooter is not in use.

EN 14619:2019 CLASS A

8+

Imported by:
Hunter Products Pty Ltd
233 Bay Street, Brighton Victoria, 3186 Australia

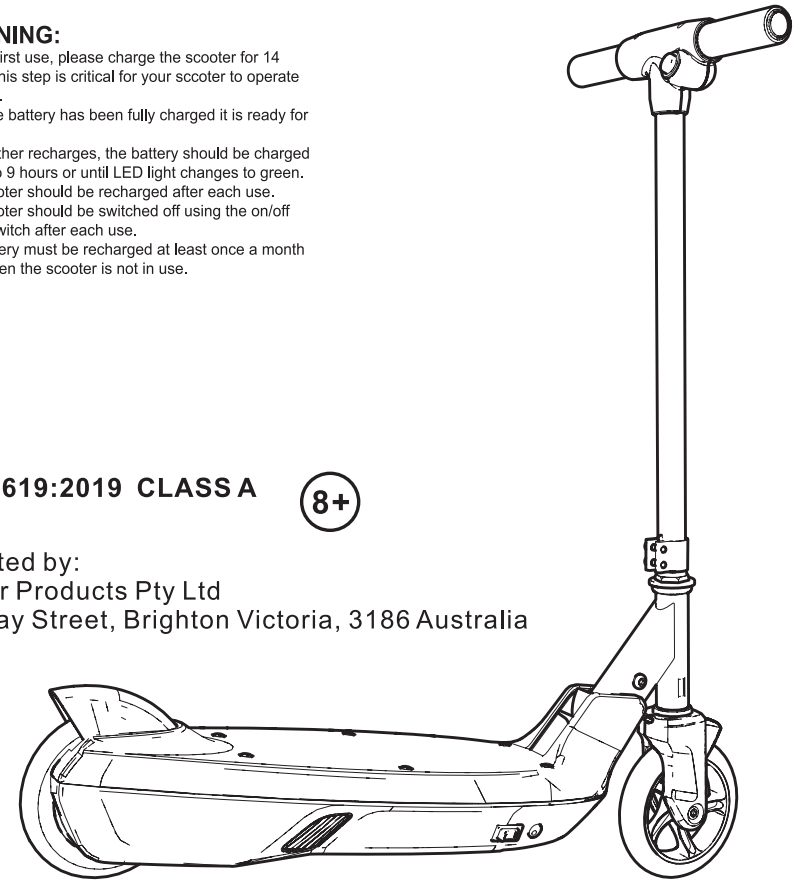

KEYCODE: 121441 PEE WEE 60E SCOOTER OWNER'S MANUAL



NOTE: Manual illustrations are for reference purposes only. Illustrations may not reflect the exact appearance of the actual product. Specifications are subject to change without notice.

FOR ANY PRODUCT ENQUIRIES OR ISSUES, PLEASE CONTACT HUNTER PRODUCTS AT:
www.electricrideon.com.au OR TOLL FREE HELPLINE 1800 224 094.

Table of Contents

Safety and Warnings	Page 3-4
Before Assembly	Page 5
Assembly	Page 6-8
Before You Ride	Page 9
Hardware Maintenance	Page 9
Scooter Parts	Page 10
Usage	Page 11
Repair and Maintenance	Page 12-14
Cleaning and Storage	Page 14
Troubleshooting Guide	Page 15-16
Warranty	Page 17

Troubleshooting

Problem	Possible Cause	Solution
Scooter will not run	<ol style="list-style-type: none"> 1. Battery is not charged 2. Wires or connectors are loose or unplugged 	<ol style="list-style-type: none"> 1. Fully charge the battery. First charge should be 14 hours and up to 9 hours for recharges. 2. Check to ensure that charger is tightly plugged into both the wall and the scooter.
Scooter run time is short	<ol style="list-style-type: none"> 1. Battery requires charging 2. Battery will not accept full charge 	<ol style="list-style-type: none"> 1. Fully charge the battery. First charge should be 14 hours and up to 9 hours for recharges. 2. Check to ensure that charger is tightly plugged into both the wall and the scooter. Make sure power flow to the wall outlet is on. Battery may need to be replaced. Even with proper care, rechargeable batteries do not last forever. The average rechargeable battery life is 1 to 2 years depending on scooter conditions and use.
Scooter suddenly stops working	Circuit breaker has tripped	<p>The reset button (on the left side of the battery box) will automatically trip and turn off the power if the motor is overloaded.</p> <p>An excessive overload (steep incline or too heavy of a rider) could have caused the motor to overheat and tripped the breaker. If this occurs (scooter suddenly stops running) wait a few seconds and then push the reset button in to reset the circuit. Avoid repeatedly tripping the breaker.</p> <p>Check all wires and connectors to make sure they are connected and tight.</p>
Scooter runs sluggishly	<ol style="list-style-type: none"> 1. Battery low on power 2. Scooter is overloaded 3. Unsuitable riding conditions 4. Battery will not accept full charge 	<ol style="list-style-type: none"> 1. Recharge battery 2. Make sure you do not overload the scooter by exceeding the 55kg maximum weight limit, going up to steep inclines or towing objects behind the scooter. Avoid overloading the scooter as this will prematurely wear out the batteries and components. 3. Ride only on solid, flat, clean and dry surfaces such as pavement or level ground. 4. Replace battery

FOR ANY PRODUCT ENQUIRIES OR ISSUES, PLEASE CONTACT HUNTER PRODUCTS AT:
www.electricrideon.com.au OR TOLL FREE HELPLINE 1800 224 094.

FOR ANY PRODUCT ENQUIRIES OR ISSUES, PLEASE CONTACT HUNTER PRODUCTS AT:
www.electricrideon.com.au OR TOLL FREE HELPLINE 1800 224 094.

Repair and Maintenance

Battery Care and Disposal

Do not store the battery in temperatures above 70 F (21 c) or below 32 F (0 c)

Disposal: This product contains sealed lead acid batteries which must be disposed or recycled in an environmentally safe manner. Do not dispose of the batteries in your household trash. Do not dispose of the batteries in a fire, this would cause the batteries to leak or explode. The incineration disposal in landfill and or placing sealed lead acid batteries with household trash is prohibited by law in most areas. Return exhausted batteries to a state or federal approved lead acid battery recycle or check with your local retailer of vehicle batteries.

WARNING: Do not mix old and new batteries. Do not mix alkaline standard (carbon-zinc), or rechargeable (nickel-cadmium) batteries.
Do not store the battery in temperatures above 70F (21 c) or below 32F (0 c).

Charger

Only use the supplied battery charger. If charger is damaged, discontinue using it.

Wheels

Wheels and drive system components are subjected to normal wear and tear. It is the responsibility of the user to regularly inspect wheels for excess wear and adjust and replace drive train components as required.

Wheel Bearings

Avoid going through water, oil or sand as this can damage wheel bearings.

To look after the wheel bearings, systematically check that the wheels turn properly by turning the scooter upside-down and using your hand to spin the wheels. If the wheels do not spin they must then be removed to check their condition. First unscrew the wheel axle, remove the axle and detach the wheel, then carefully push the two wheel bearings out of their housing. If they are chipped or dented, new ones should be bought. If there is no visible damage, they must then be oiled. To do this, remove all traces of grease, mud or dust with a kitchen towel or cloth, and re-oil them with a grease spray or by leaving them to soak overnight in oil [turn them several times in the oil first. Remove and reassemble the wheel bearings and axles, followed by the wheel, onto the scooter. Proceed in the same manner for the other wheel.

Cleaning and Storage

1. If product gets dirty, use a clean damp cloth and wipe gently on the plastic surface. Only use dry and clean cloth to clean surface on or near battery, electronic wires, plugs or any component related to electric parts.
2. Store after product is dried. Store the product in cool and dry place.

Safety and Warnings

WARNING: Riding an electric scooter can be a dangerous activity. Certain conditions may cause components to fail without fault of the manufacturer. Scooter can and is intended to move and it is therefore possible to lose control, fall off and/or get into dangerous situations . RIDE AT YOUR OWN RISK AND ALWAYS USE COMMON SENSE.

This manual contains many warnings and cautions concerning the consequences of failing to inspect or maintain your electric scooter. **If these warnings and cautions are ignored incidents may occur which can result in serious injury or even death.**

APPROPRIATE RIDING ATTIRE

Always wear proper protective gear such as:

Approved safety helmet.(Helmet may be legally required by local law or regulation in your area.)

Elbow pads and knees pads

Long sleeved shirt, long pants

Gloves

Lace up shoes with rubber soles, never ride barefooted or in sandals, and ensure that shoelaces are tied and kept out of the way of the wheels and drive system

RIDER USE AND PARENTAL SUPERVISION

RIDER MUST NOT EXCEED THE WEIGHT LIMIT OF 55 KG.. Rider weight does not always mean a person's size is appropriate to fit or maintain control of the scooter.

This manual contains extremely important safety information. It is your responsibility to completely review this information and make sure that all riders understand all warnings, cautions, instructions and safety topics and assure that all riders are responsible to use the electric scooters safely. It is advised that you periodically review and reinforce all information in this manual with all riders, and that you inspect and maintain your scooter to insure their safety. Any rider that is unable to fit comfortably on the scooter should never attempt to ride it. A parent's decision to allow their child to use scooter should be based on the child's maturity, skill and their ability to follow rules.

Do not touch the motor or brakes on the scooter when in use or directly after use as these parts can become extremely hot.

Keep this scooter away from small children and remember that it is intended for use only by persons who are, at a minimum, completely competent and comfortable while operating this product.

RIDING PRACTICES AND CONDITIONS

Check and obey any local laws or regulations which may affect the locations where the electric scooter may be used. Always ride defensively. Watch out for obstacles that could catch your wheel or force you to turn suddenly or lose control. Be careful to avoid pedestrians, other wheeled products (such as skaters, skateboards, scooters, bikes etc.), children or animals who may enter your path. Always respect the rights and property of others.

Do not activate the speed control on the hand grip unless you are on the scooter and in a safe, outdoor environment that is suitable for riding.

Do not attempt or perform stunts or tricks on this electric scooter. This product is not made to withstand abuse from jumping, curb grinding or any other type of misuse or stunts.

Maintain a hold with both hands on the handlebars at all times.

Warnings

The scooter shall not be modified from the manufacturer's original design and configuration.

The scooter shall not be operated to perform racing, stunt riding, or other maneuvers, which may cause loss of control, or may cause uncontrolled operator/passenger actions or reactions.

Owners shall be encouraged to highlight (for conspicuity) using lighting, reflectors, and for low-riding units, signal flags on flexible poles.

Persons with the following conditions shall be cautioned not to operate:

Those with heart conditions; Pregnant women; Persons with head, back, or neck ailments, or prior surgeries to those areas of the body; and Persons with any mental or physical conditions that may make them susceptible to injury or impair their physical dexterity or mental capabilities to recognize, understand, and perform all of the safety instructions and to be able to assume the hazards inherent in unit use.

Maximum operating speeds: 10KM/Hour

FOR ANY PRODUCT ENQUIRIES OR ISSUES, PLEASE CONTACT HUNTER PRODUCTS AT:
www.electricrideon.com.au OR TOLL FREE HELPLINE 1800 224 094.

FOR ANY PRODUCT ENQUIRIES OR ISSUES, PLEASE CONTACT HUNTER PRODUCTS AT:
www.electricrideon.com.au OR TOLL FREE HELPLINE 1800 224 094.

Safety and Warnings

Never allow more than one person ride the scooter at the same time.

Never use near steps, water or swimming pools.

Keep your fingers and other body parts away from the chain, motor, steering system, wheels and all other moving components.

Never ride while using a cell phone or wearing headphones.

Never hitch on to another vehicle or pull anyone or anything.

Never immerse the scooter in water, electric and drive components could be damaged by water or create other possible unsafe conditions.

Ride only on flat, dry surfaces such as pavement or level ground without loose debris, such as sand, leaves, rocks or gravel. Water, mud, ice, bumpy, uneven, slick, or rough surface could impair traction and contribute to possible loss of control. Avoid excessive speed that can occur from downhill rides which could cause loss of control.

Do not ride at night or in areas of limited visibility.

Do not ride indoors or on surfaces that could become damaged such as carpet or flooring.

Before each ride the following checks will need to be performed to the **scooter**:

Ensure that the brake system is functioning properly.

All components are properly secured and are functioning according to manufacturers' specifications.

Components shall be maintained and repaired in accordance with the manufacturers' authorized replacement parts with installation performed by dealers or other skilled individuals.

USING THE CHARGER

The charger should be regularly examined for damaged to the cord, plug, enclosure and other parts. In the event of such damage, if any is found, the scooter should not be charged until the charger has been repaired or replaced.

Use only with the supplied recommended charger:MODEL NO: HAW030-100SSNP120

Charge only the 12V sealed lead acid battery for PEE WEE 60E SCOOTER

WARNING: Never install non-rechargeable battery inside the Scooter. Never use provided battery charger (HAW030-100SSNP120) to charge non-rechargeable battery.

During charging, the battery must be placed in a well ventilated area.

This appliance is not intended for use by young children under 8 years old unless they have been adequately supervised by a responsible person to ensure that they can use the appliance safely.

Young children should be supervised to ensure that they don't play with the appliance.

Always use caution when charging.

The charger is not a toy and should be operated by an adult.

Never operate charger near flammable materials or liquids.

Disconnect the charger and unplug from scooter when not in use.

Do not exceed recommended charging time.

Always disconnect the charger from the scooter prior to wiping down and cleaning with any liquid.

Examine the battery charger regularly for damage, especially the cord, plug and enclosure.

If the battery charger is damaged, it must not be used until it has been repaired.

The supply cord cannot be replaced if the cord is damaged the appliance should be scrapped.

FAILURE TO HEED TO THE WARINGS LISTED ABOVE INCREASE RISK OF POTENTIAL SERIOUS INJURY. USE THE APPROPRIATE CAUTION WHEN RIDING AND ALWAYS WEAR PROTECTIVE GEAR.

Repair and Maintenance

Front Wheel Replacement

Tools required: **Two 5mm hex wrench (Not included)**

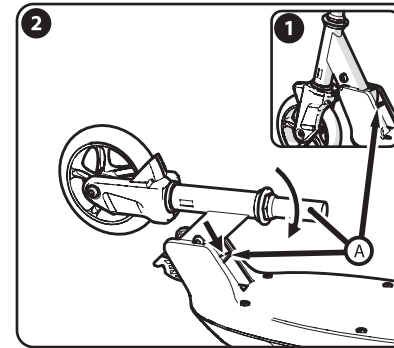

1. Fold Fork assembly by putting up Lock A and tilting Fork assembly forward until it can not be fold.

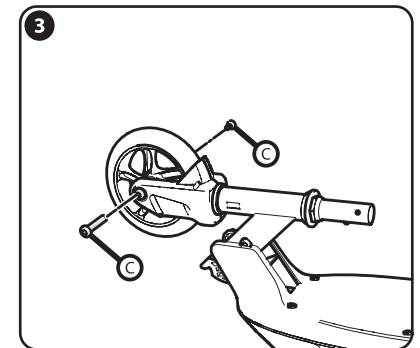

2. Using two 5mm hex wrench loosen and remove the front axle by turning the wrenched counter clockwise.

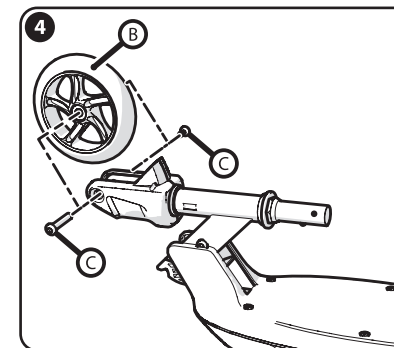

3. Reinstall new replacement wheel ensuring to note the order and location of all components.

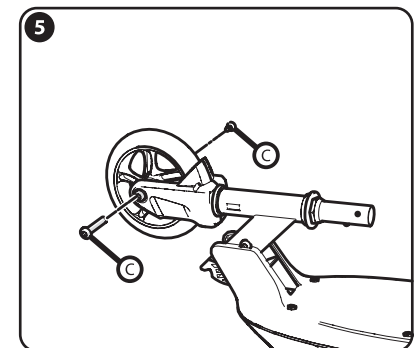

4. Reinstall hardware and tighten clockwise with a 5mm hex wrench.

**FOR ANY PRODUCT ENQUIRIES OR ISSUES, PLEASE CONTACT HUNTER PRODUCTS AT:
www.electricrideon.com.au OR TOLL FREE HELPLINE 1800 224 094.**

**FOR ANY PRODUCT ENQUIRIES OR ISSUES, PLEASE CONTACT HUNTER PRODUCTS AT:
www.electricrideon.com.au OR TOLL FREE HELPLINE 1800 224 094.**

Repair and Maintenance

Chain and Rear Wheel Replacement

Tools required: 5mm hex wrench with phillips screw head, 10mm/14mm wrench. (Excluded)

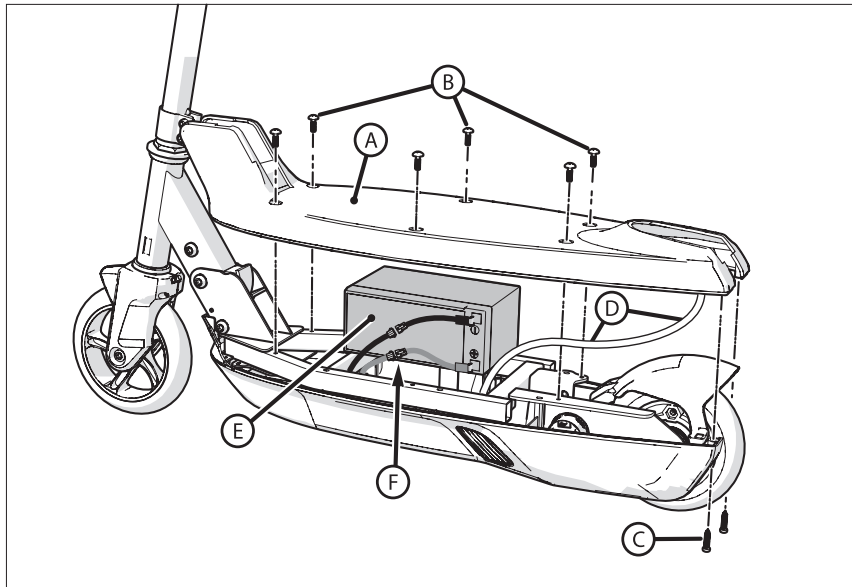

1. Remove Deck A by removing 6 Machine Screws B and 2 self-starting Screws C.

CAUTION: Brake Switch Harness D will remain attached to Deck.

2. Carefully lift out Battery E straight up.

3. Disconnect Negative and Positive Plugs F.

4. See Maintenance sections for Care and Disposal.

To replace Battery - Always replace with same type and size as original:

CAUTION: Make sure Brake Switch Harness D does not get pinched or bound up when re-installing Deck A.

5. Connect Negative and Positive Plugs F.

6. Carefully insert Battery into lower body - being careful not to pinch any wires or plugs.

7. Re-install upper Deck A by installing 6 Machine Screws B and 2 self-starting Screws C.

WARNING: Item to be assembled by adult only.

Before assembly

WARNING: Make sure you remove all components from the box prior to assembly. Make sure that the power switch is turned "OFF" before assembling the scooter.

Estimated Assembly Time

Allow up to 25 minutes for assembly, not including initial charge time.

Allow up to 14 hours for the initial charge (see page 8 for charging information)

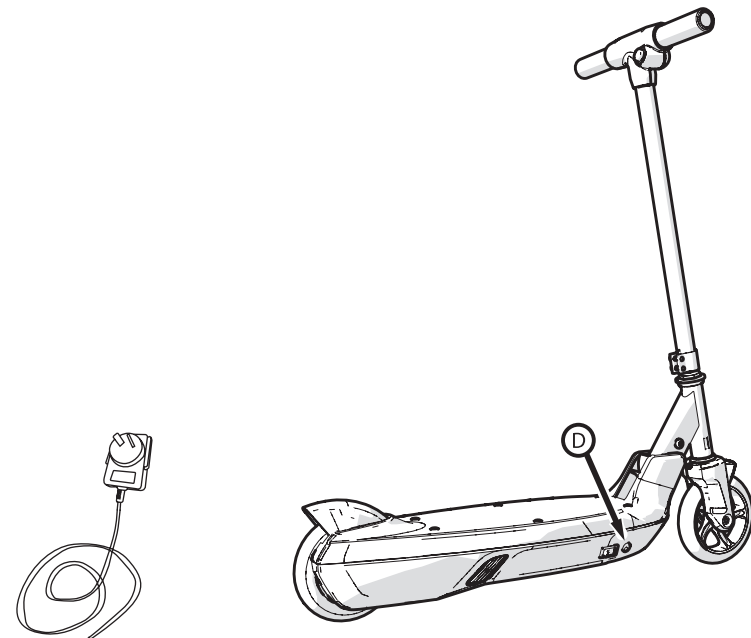

**CHARGER (Model No.:HAW030-100SSNP120)
(Included)**

FOR ANY PRODUCT ENQUIRIES OR ISSUES, PLEASE CONTACT HUNTER PRODUCTS AT:
www.electricrideon.com.au OR TOLL FREE HELPLINE 1800 224 094.

FOR ANY PRODUCT ENQUIRIES OR ISSUES, PLEASE CONTACT HUNTER PRODUCTS AT:
www.electricrideon.com.au OR TOLL FREE HELPLINE 1800 224 094.

Required Tools for assembly(included)

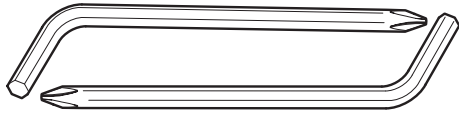

5mm allen wrench (included) x1

Assembly

Handlebar Steer Tube Assembly

Tools required: 5mm allen wrench

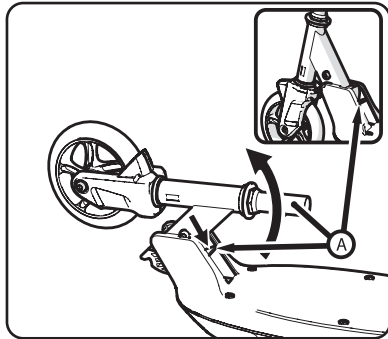

1. Unfold Fork assembly by releasing Lock A and tilting Fork assembly forward until it SNAPS into the upright LOCKED position.

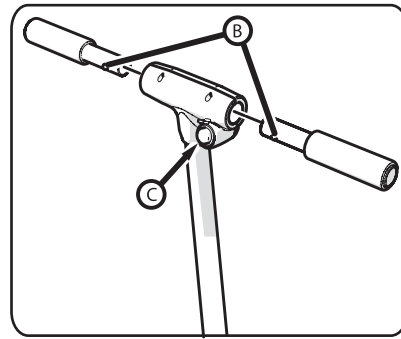

2. Insert each Hand Grip with Lock Ball B facing BACK (same side as Power Button C) Insert while twisting slightly until Lock Balls SNAP into LOCKED position.

Note: Left Handle Grip may already be assembled by factory.
Test Grips by trying to pull them out. They should remain locked into position.

Frame, Fork and Components

Always carefully inspect your scooter before you ride. Check for cracks, broken worn or loose components which should be repaired or replaced before you ride.

Battery

Always make sure the power switch is in the "OFF" position whenever the scooter is not in use. Never store the product in freezing or below freezing temperatures! These low temperatures will permanently damage the battery.

WARNING: Always ensure that you are in a safe open area to ride before you engage the throttle. Never twist the throttle without being on the scooter in a balanced, ready to ride position with both hands on the handlebar controls. Failure to follow these instructions may damage your scooter and void your warranty.

USAGE

Starting the Scooter

To start unit, turn on power switch A;
Engage Drive Motor by pushing Throttle Button B.
Scooter must accelerate to 3kph for motor to engage.

Stopping the Scooter

To stop unit, release the throttle Button B to turn off Drive Motor.
Apply foot to rear Fender/Brake C to stop.

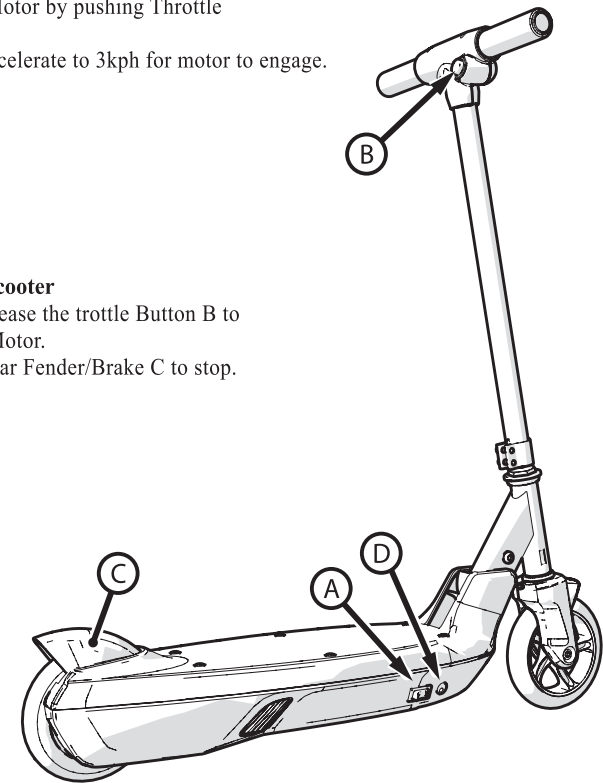

FOR ANY PRODUCT ENQUIRIES OR ISSUES, PLEASE CONTACT HUNTER PRODUCTS AT:
www.electricrideon.com.au OR TOLL FREE HELPLINE 1800 224 094.

FOR ANY PRODUCT ENQUIRIES OR ISSUES, PLEASE CONTACT HUNTER PRODUCTS AT:
www.electricrideon.com.au OR TOLL FREE HELPLINE 1800 224 094.

Scooter Parts

1. Steering Tube
2. Handlebar Cover (2 pieces)
3. Throttle Button
4. Grips (x2)
5. Snap-in Handlebar Grips and End Cap assembly (x2)
6. Steering Tube Clamp
7. Headset Bearings
8. Front Wheel
9. Axle - Shoulder Screw Set
10. Fork Assembly w/ Housing
11. Machine Screws (x6)
12. Self-Starting Screws (x2)
13. Brake/Fender w/ Spring
14. Brake Switch w/ Cable
15. Battery
16. Battery

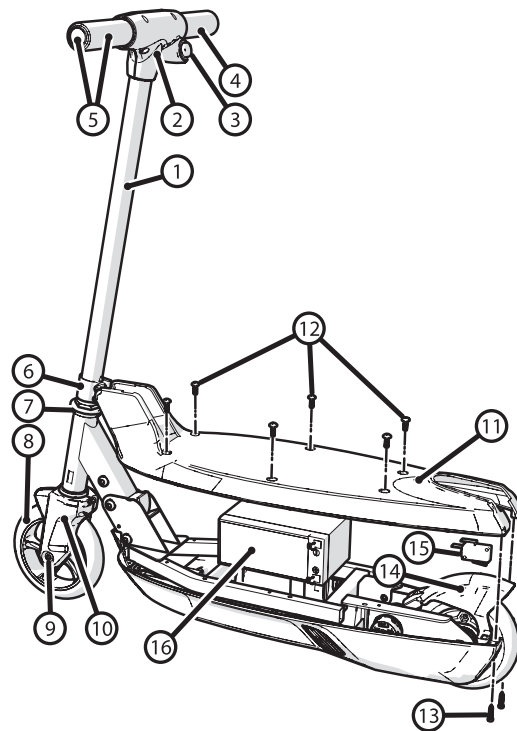

Power source: 12V Rechargeable, sealed lead acid battery

Charging time: Always charge the battery for 9 hours after first use and when recharging is needed, never charge for more than 20 hours

CHARGER (HAW030-100SSNP120)	INPUT:100-240V~50/60Hz 0.7A OUT PUT:12V--- 1A
The first charging time	>14hours

Assembly - Continued

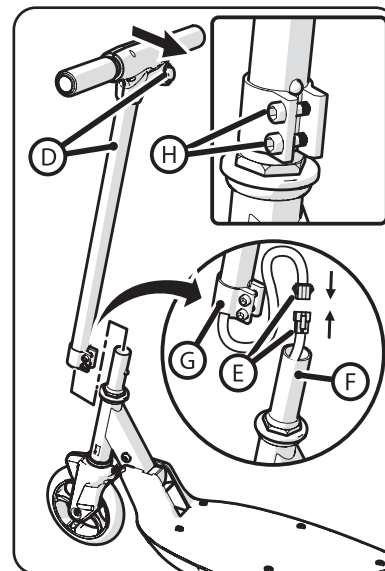

3.
 - (1) Ensure Handlebar Assembly *D* is facing toward the BACK.
 - (2) Connect Power Plugs *E* firmly and completely.
 - (3) Put excess wire inside steering tube.
 - (4) Slide Handlebar Assembly over Fork Tube *F* fully.
 - (5) With Clamp *G* facing BACK.
 - (6) Tighten Clamp Screws *H* evenly and securely.

WARNING: Make sure Handlebar and Fork turn easily and completely from left to right without binding Wiring Harness.

FOR ANY PRODUCT ENQUIRIES OR ISSUES, PLEASE CONTACT HUNTER PRODUCTS AT:
www.electricrideon.com.au OR TOLL FREE HELPLINE 1800 224 094.

FOR ANY PRODUCT ENQUIRIES OR ISSUES, PLEASE CONTACT HUNTER PRODUCTS AT:
www.electricrideon.com.au OR TOLL FREE HELPLINE 1800 224 094.

Assembly

Charge the Battery

Required components: Charger

Initial battery charge time: **14 hours**

Recharges after initial charge- up to **9 hours**

When scooter is not in regular use battery needs to be charged on a monthly basis to maximize performance.

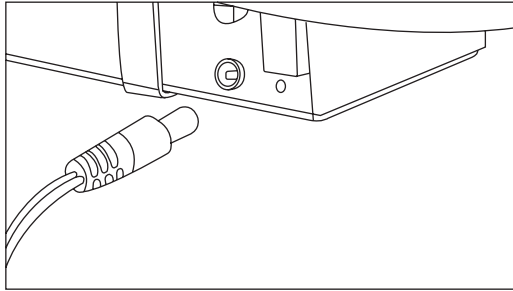

1. Make sure power switch is in the OFF position before plugging in the charger. Insert charger into charging port on the right side of the battery box.

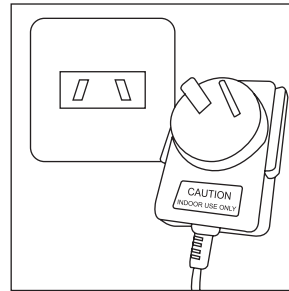

2. Plug the charger into a wall power outlet. The light on the charger housing should illuminate. **Green LED light** indicates battery is fully charged.

WARNING: When you first use your scooter you have charged the battery for at least **14 hours**. Failure to follow these instructions may damage your product and void your warranty.

Note: The charger has a small window with one LED light that indicates the charge status. Refer to the illustration on the charger unit for the actual “charging” and “charged” status indication. Your charger may get warm during use; this is normal and has no cause for concern.

For all other recharges, the battery should be charged for up to 9 hours or until LED light changes to green. The scooter should be recharged after each use. The scooter should be switched off using the on/off power switch after each use.

Note: Battery must be recharged at least once a month even when the scooter is not in use. Failure to do so may result in battery that will no longer charge.

Before You Ride

Before you ride always check and for the following:

Safety Gear

Always wear proper protective gear such as:

Approved safety helmet. (Helmet may be legally required by local law or regulation in your area).

Elbow pads and knees pads

Long sleeved shirt, long pants

Gloves

Lace up shoes with rubber soles.

Brake

Check the brakes for proper function. When lever is squeezed it should slow/stop the rear wheel without excessive effort. When you apply the brake with the throttle on, the brake cut off switch should stop the motor. Make sure that the brakes are not rubbing when the lever is not being squeezed. Do not ride the scooter if the brakes are not functioning properly.

Throttle

Turn the power switch to “ON” position, then kick the scooter to 3kph for motor to engage, the scooter will move when the throttle is twisted.

Make sure that before throttle is twisted that you are in an open and safe area to ride, you are balanced on the scooter and have both hands on the handlebar controls.

Tyres

Inspect the wheels for excess wear and replace if necessary.

Hardware Maintenance

Brake:

Check the brakes for proper function. When you squeeze the lever, the brake should provide positive braking action. When you apply the brake with the speed control on, the brake cut off switch should stop the motor. Make sure that the brakes are not rubbing when the lever is not being squeezed.

Frame, Fork and Handlebars

Check for cracks or broken connections. Although broken frames are rare, it is possible for aggressive rider to run into a curb or wall and bend or break the frame. Get in the habit of inspecting your scooter on a regular basis.

Tyres

Periodically inspect the wheels for excess wear.

Safety Gear

Always wear proper protective gear such as an approved safety helmet. Elbow pads and knee pads are recommended. Always wear athletic shoes (lace up shoes with rubber soles), never ride barefooted or in sandals, and keep shoelaces tied and out of the way of the wheels, motor and drive system.

Battery

Make sure the power switch is turned off whenever the scooter is not in use. Never store the product in freezing or below freezing temperatures! Freezing will permanently damage the battery.

FOR ANY PRODUCT ENQUIRIES OR ISSUES, PLEASE CONTACT HUNTER PRODUCTS AT:
www.electricrideon.com.au OR TOLL FREE HELPLINE 1800 224 094.

FOR ANY PRODUCT ENQUIRIES OR ISSUES, PLEASE CONTACT HUNTER PRODUCTS AT:
www.electricrideon.com.au OR TOLL FREE HELPLINE 1800 224 094.