



# Audi R8 Spyder



## Owner's Manual and Assembly Instructions

Model #: W458AC-F

Read and understand the entire manual before assembly and operation. The vehicle must be assembled by an adult who has read and understands the instructions.

Made in China.

Styles and colours may vary. Enquiries or Questions please call 1800 224 094 for assistance and replacement parts.

**IMPORTANT:**

**Save this manual with your sales receipt.**



# Introduction

Thank you for purchasing this vehicle from Hunter Products. We hope the rider enjoys it for miles to come. Please read this instruction guide carefully before assembling and operating the vehicle. Please have your model number and serial number ready before calling. Please have proof of purchase. Keep your sales.

Please contact Hunter Products Customer Service with any questions.

Hours: 9 AM - 5 PM, Monday - Friday

Phone: 1800 224 094

Email: [enquiries@hunterproducts.com.au](mailto:enquiries@hunterproducts.com.au)

Web: [www.electricrideon.com.au](http://www.electricrideon.com.au)

## Specifications:

BATTERY	6V 7AH
MOTOR	6V 20W
AGE	3 Years and Up
MAX WEIGHT	35 kg (77 lbs)
PRODUCT SIZE	47.2 x 24.4 x 19.7 in. (1.2 m x 62 x 50 cm)
SPEED	4 kPH
RECHARGE TIME	8-12 Hours
TYPICAL RUN TIME	1-2 Hours
CHARGER OUTPUT	DC 7.0V

# **IMPORTANT!**

## **YOU MUST CHARGE THE BATTERY FOR 24 HOURS BEFORE FIRST USE!**

Charge the battery after each use.

Charge the battery at least once a month, even if the vehicle is not in use.

Call Customer Service if you need assistance or replacement parts. Please have your model number and serial number ready before calling. Please have proof of purchase. Keep your sales receipt.

Phone: 1800 224 094 or Email: [enquiries@hunterproducts.com.au](mailto:enquiries@hunterproducts.com.au)

**Read this entire manual to ensure proper assembly and safe operation of the vehicle.**

# **WARNING!**

## **PREVENT INJURIES AND DEATHS:**

- **NEVER LEAVE CHILD UNATTENDED. ALWAYS** keep child in view when child is in vehicle. Direct adult supervision is **REQUIRED**.
- **NEVER** use on roadways, near cars, on or near steep inclines or steps, swimming pools or other bodies of water.
- **ALWAYS** wear shoes.
- **ALWAYS** sit on the seat.
- **NEVER** allow more than one (1) rider in the vehicle.

<b>Safety</b> .....	6
<b>Parts</b> .....	8
<b>Charging Instructions</b> .....	9
<b>Assemble the Front Wheels</b> .....	10
<b>Assemble the Rear Wheels</b> .....	11
<b>Dashboard/Windshield Assembly</b> .....	12
<b>Assemble the Steering Wheel</b> .....	13
<b>Attach the Mirrors</b> .....	14
<b>Attach the Seat</b> .....	15
<b>Operation Instructions</b> .....	16
<b>Battery Removal</b> .....	17
<b>Maintenance</b> .....	18
<b>General Care</b> .....	19
<b>Troubleshooting Guide</b> .....	20
<b>Service and Repairs</b> .....	22
<b>Warranty</b> .....	23

## 6 Safety



### **WARNING: SAFETY RIDING RULES**

The user must follow all safety rules and guidelines, or serious injury or death may occur to the user.

- Always use common sense and safe practices when using the vehicle. The user must be at least 3 years old and weigh no more than 35 kg (77 lbs).
- This product contains small parts that are for adult assembly only. Keep small children away when assembling. Remove and dispose of all protective material and plastic bags before assembly.
- Riders must always wear a fitted helmet that complies with AUS Standard AS 2063
  
- Only sit on the seat in the vehicle.
- Do not allow more than one rider.
- Do not overload the vehicle. Do not remove the weight restriction decals.
- Do not pull the vehicle with another vehicle or similar device.
- Keep body parts such as hands, legs, hair and clothing away from moving parts. Moving parts can cause serious injury.
- Always wear shoes in the vehicle.
- Do not operate near streets or motor vehicles.
- Do not operate near drop-offs such as steps, steep inclines or hills. Operate on relatively level ground.
- Do not operate near water, swimming pools or other fluids.
- Do not operate in dangerous weather conditions such as rain or snow.
- Do not operate near loose dirt, mud, sand or fine gravel.
- Do not operate near flammable vapors (gasoline, paint thinner, acetone, etc.).
- Always use the vehicle in a safe, secure environment with adult supervision.



## **WARNING: BATTERY SAFETY**

- Battery posts, terminals and related accessories contain lead and lead compound (acid) chemicals known to the state of California to cause cancer, reproductive harm, and are toxic and corrosive. DO NOT open the battery.



- Contact exposure to battery leakage (lead acid) may cause serious injury. Immediately contact your doctor if exposure occurs. If the chemical is on the skin, flush immediately with cool water for 15 minutes. If the chemical is swallowed, immediately give the person water or milk. Do not give water or milk if the person is vomiting or has decreased alertness. Do not induce vomiting.

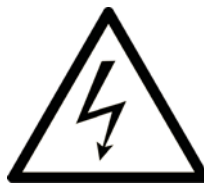

- Tampering with or modifying the electric circuit system may cause shock, fire or explosion. It could permanently damage the system. Keep the charger housing closed to prevent exposed wiring, which may cause electric shock.

**IMPORTANT:** Before using the vehicle for the first time, the battery must be charged for a full 24 hours (no more than 30 hours).



## **WARNING: ADULT SUPERVISION REQUIRED**

- Before using the vehicle, the rider must understand the vehicle controls and safety issues.
- It is the responsibility of the adult to educate the child and to determine if the child is capable of understanding the vehicle controls.
- An adult must ALWAYS directly supervise the use of this vehicle.
- NEVER leave a child unsupervised in the vehicle.

# 8 Parts

1. Car Body
2. Seat
3. Steering Wheel
4. Dashboard
5. Windshield
6. Left and Right Mirrors
7. Front Wheel (2)
8. Rear Wheel (2)
9. Hubcap (4)
10. Battery Charger (1)
11. Steering Wheel Screw (1)
12. Steering Wheel Nut (1)
13. Dashboard Screw (2)
14. Snap pin (4)
15. Large Washer (2)
16. Flat Washer (4)
17. Inner Wheel Spacer

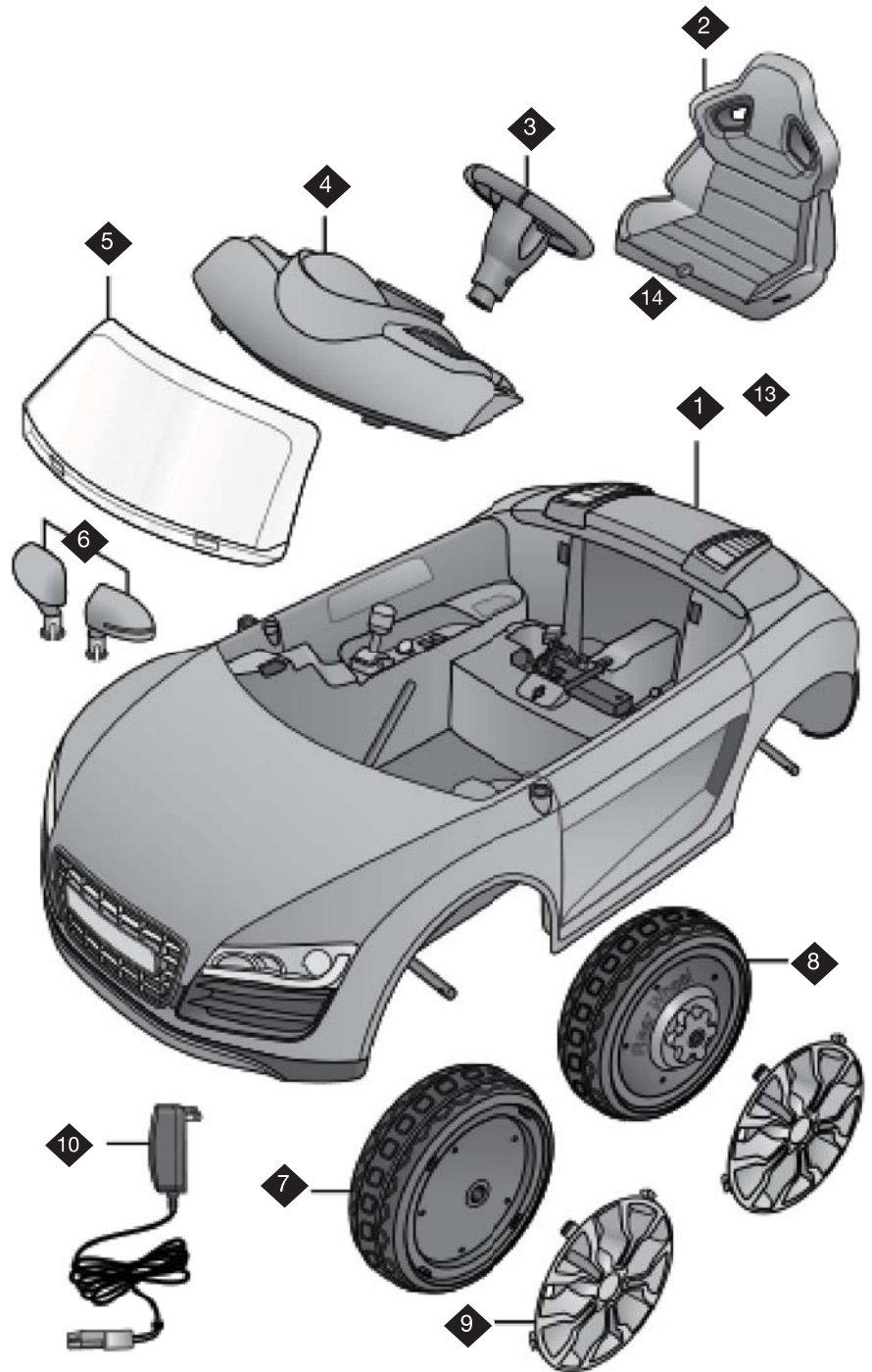

**Not Included:**

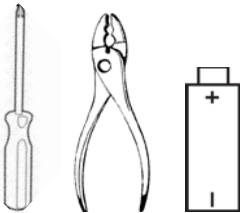

- Phillips screwdriver
- Pliers
- 2 AAA Batteries

**Helpful Tip:**

1. Parts 11 & 12 are attached to the base of the steering wheel
2. Parts 14 - 17 are taped on the end of each wheel axle

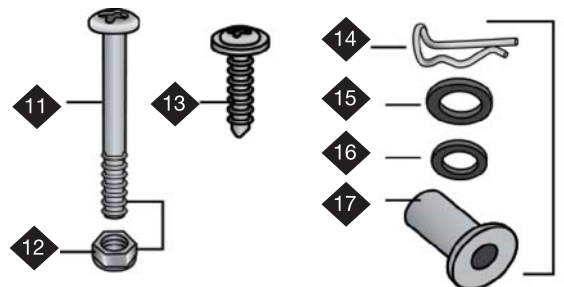



## YOU MUST CHARGE THE BATTERY FOR 24 HOURS BEFORE THE FIRST USE!

**ONLY AN ADULT SHOULD HANDLE THE BATTERY AND CHARGER.**

### To Charge the Battery:

1. Ensure the vehicle is stopped and turned off.
2. Unlock and remove the seat.
3. Unplug the red battery connector from the red engine connector.
4. Connect the red battery connector to the red battery charger connector
5. Plug into a 240 V outlet.

### To Unplug the Battery:

6. Unplug the battery charger from the outlet.
7. Unplug the red battery connector.
8. Reconnect the red battery connector to the red engine connector.
9. Replace the seat and tighten lock.

Note: It is not necessary to remove the battery for charging. However, if the battery does not reach the outlet, it can be removed for charging. For Battery Removal instructions, see Page 17.

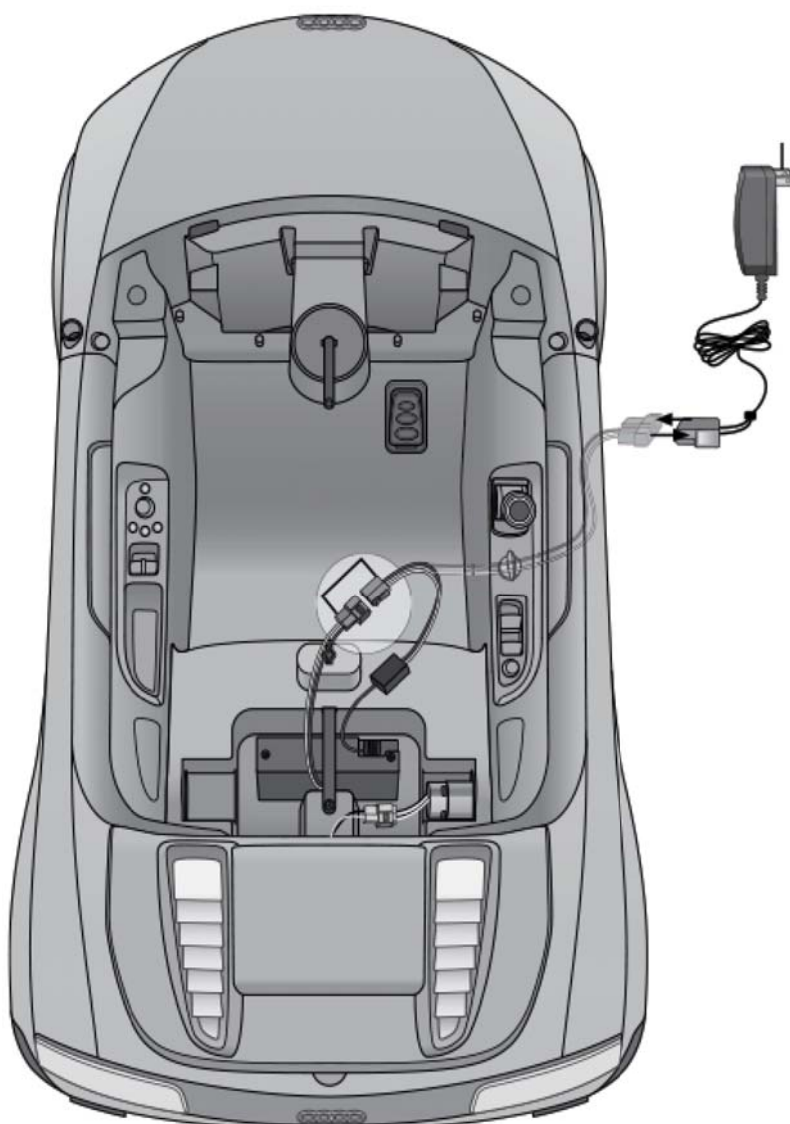

# 10 Assemble the Front Wheels

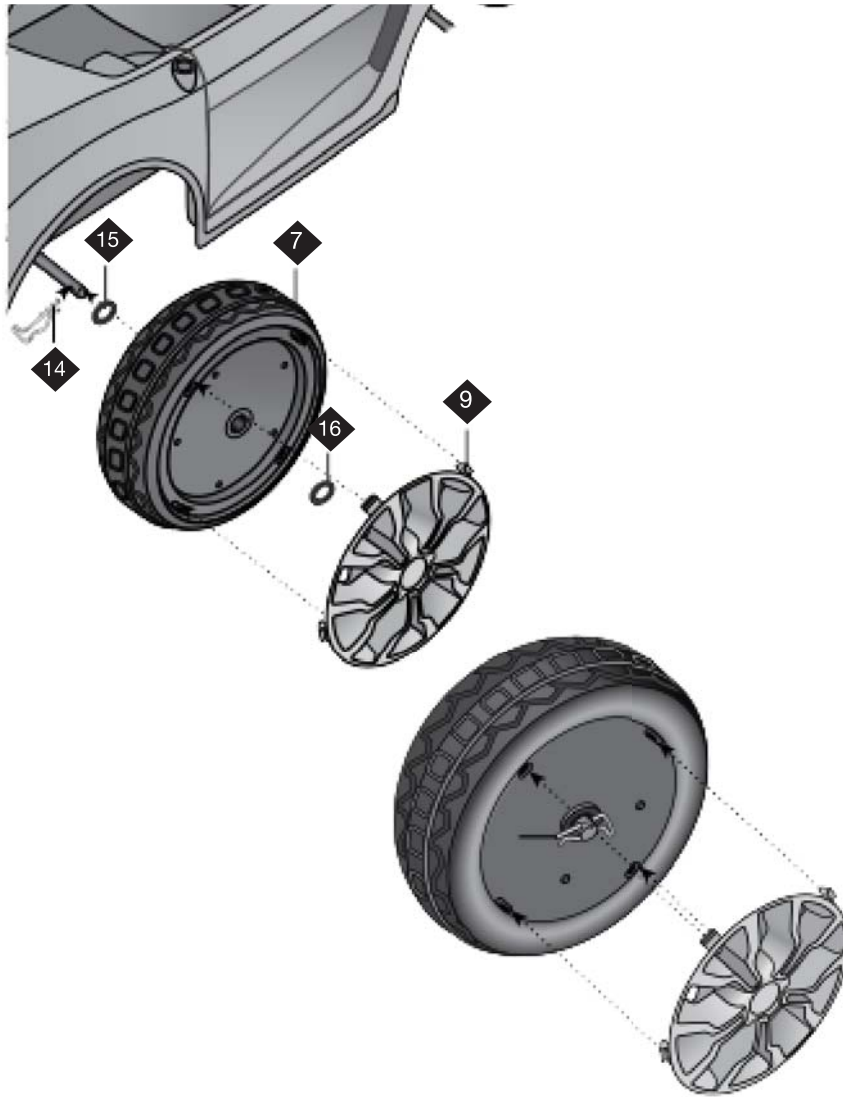

## Helpful Tip:

1. Using pliers will make it easier to remove the snap pin from the wheel axle

1. Remove the tape from both sides of the front axle to access washers and snap pins
2. Slide the large washer (15) onto the axle
3. Slide the front wheel (7) onto the axle. Ensure that the side of the wheel with the slots is facing out
4. Slide the flat washer (16) onto the axle
5. Insert the straight side of the snap pin (14) through the hole at the end of the axle to keep the wheel in place
6. Position the hubcap (4) over the holes on the wheel, and snap the hubcap into place
7. Repeat sets 1-6 for the other front wheel

# Assemble the Rear Wheels 11

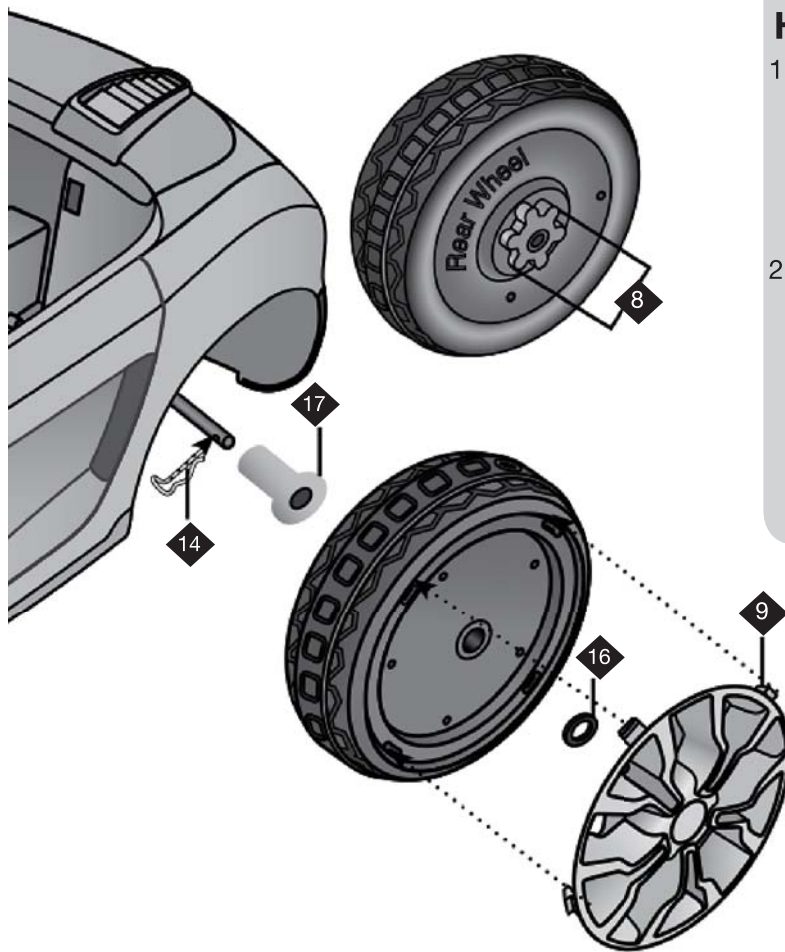

## Helpful Tip:

1. If you encounter trouble fitting both wheels onto the rear axle, then your rear wheel axle may need to be realigned.
2. Remove both wheels from the rear wheel axle. Using two hands, push down on the rear wheel axle and slide it gently toward the side of the vehicle that needs more room.

1. Remove tape from both sides of the rear axle to access washers and snap pins.  
Note: The right side of the vehicle will only have 1 washer

### Left Rear Wheel

2. Slide the inner wheel spacer (17) onto the axle with the wide end facing out
3. Slide the left rear wheel (8) onto the axle with the gear teeth facing inward
4. Slide the flat washer (16) onto the axle
5. Insert the straight side of the snap pin (14) through the hole at the end of the axle to keep the wheel in place
6. Position the hubcap over the holes on the wheel, and snap the hubcap into place

### Right Rear Wheel

7. Slide the right rear wheel (8) onto the axle with the gear teeth facing inward. Ensure that the gear teeth connect with the gear box that is pre-installed on the axle
8. Repeat steps 4-6

## 12 Dashboard/Windshield Assembly

1. Position the two front tabs on the dashboard above the slots on the windshield
2. Snap the windshield onto the dashboard

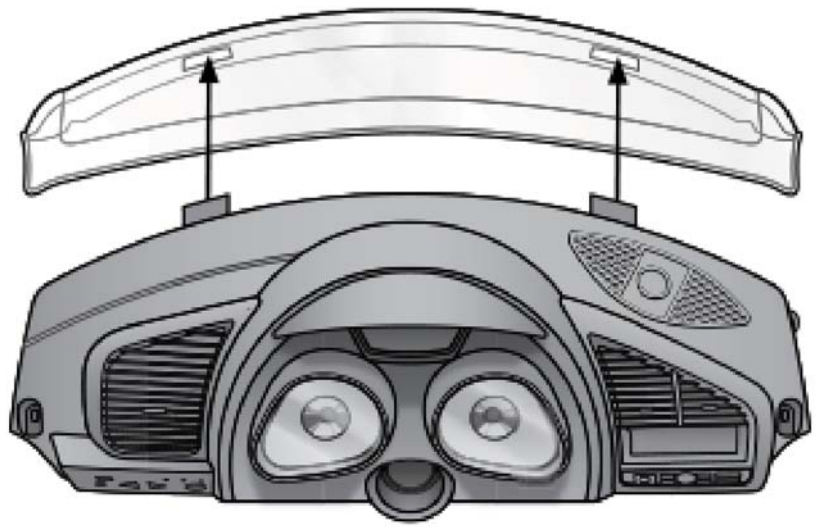

1. Holding the dashboard/windshield assembly together, insert steering rod on the car body through the hole of the dashboard
2. Align the dashboard with the slots on the car, and slide the dashboard into place
3. Use a Phillips-head screwdriver to fasten the dashboard screw (13) into the two screw hole locations on either side of the dashboard

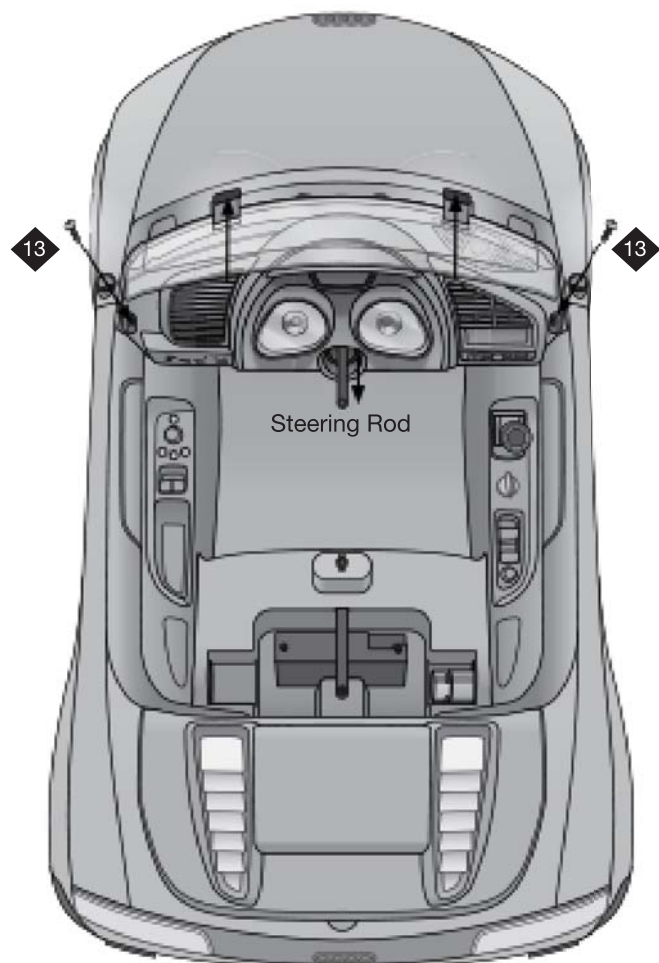

# Assemble the Steering Wheel

1. Use a Phillips head screwdriver to remove the screw on the battery compartment of the steering wheel
2. Insert two AAA batteries into the battery compartment
3. Replace cover and use the screwdriver to fasten

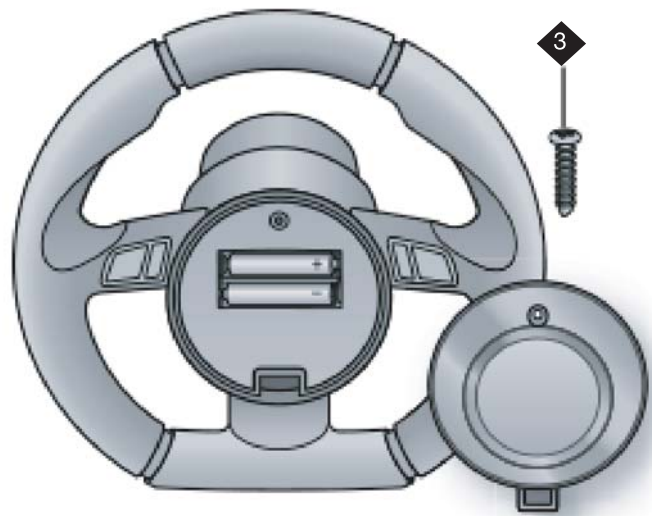

## **WARNING!**

**DO NOT** mix old and new batteries.

**DO NOT** mix alkaline, standard (carbon-zinc) or rechargeable (nickle-cadmium) batteries.

1. Slide the steering wheel (3) onto the steering rod
2. Align the holes on the steering wheel with the holes on the steering rod
3. Slide the steering wheel screw (11) through the steering wheel and steering rod
4. Fasten the nut (12) to the end of the screw and tighten the screw with a screwdriver

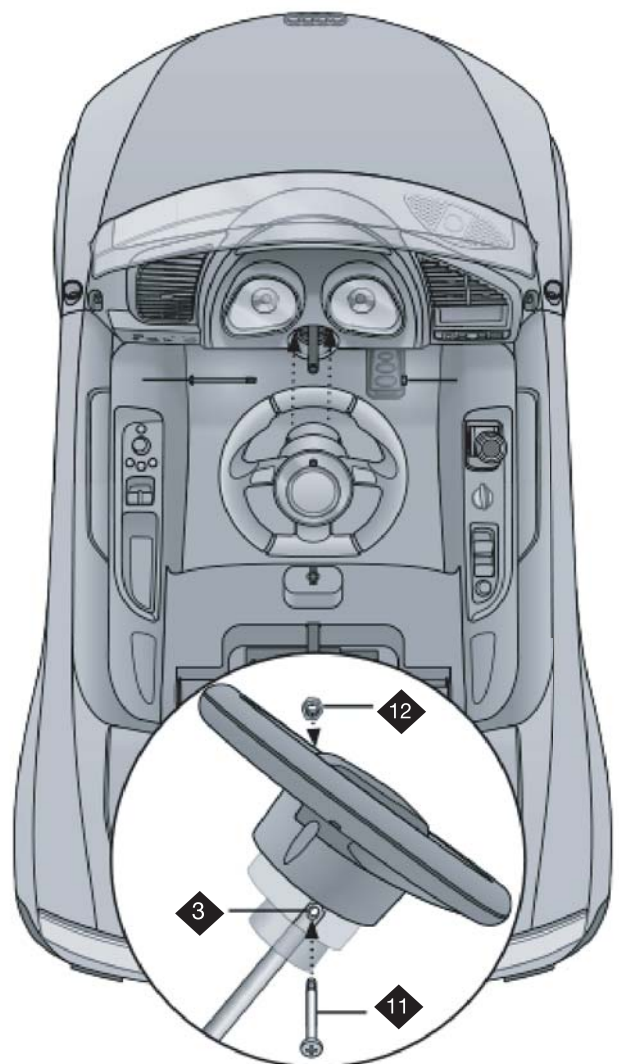

## 14 Attach the Mirrors

1. Align the bottom of the mirror with the hole on the car body near the dashboard
2. Gently press the mirror down into place
3. Repeat for the other mirror

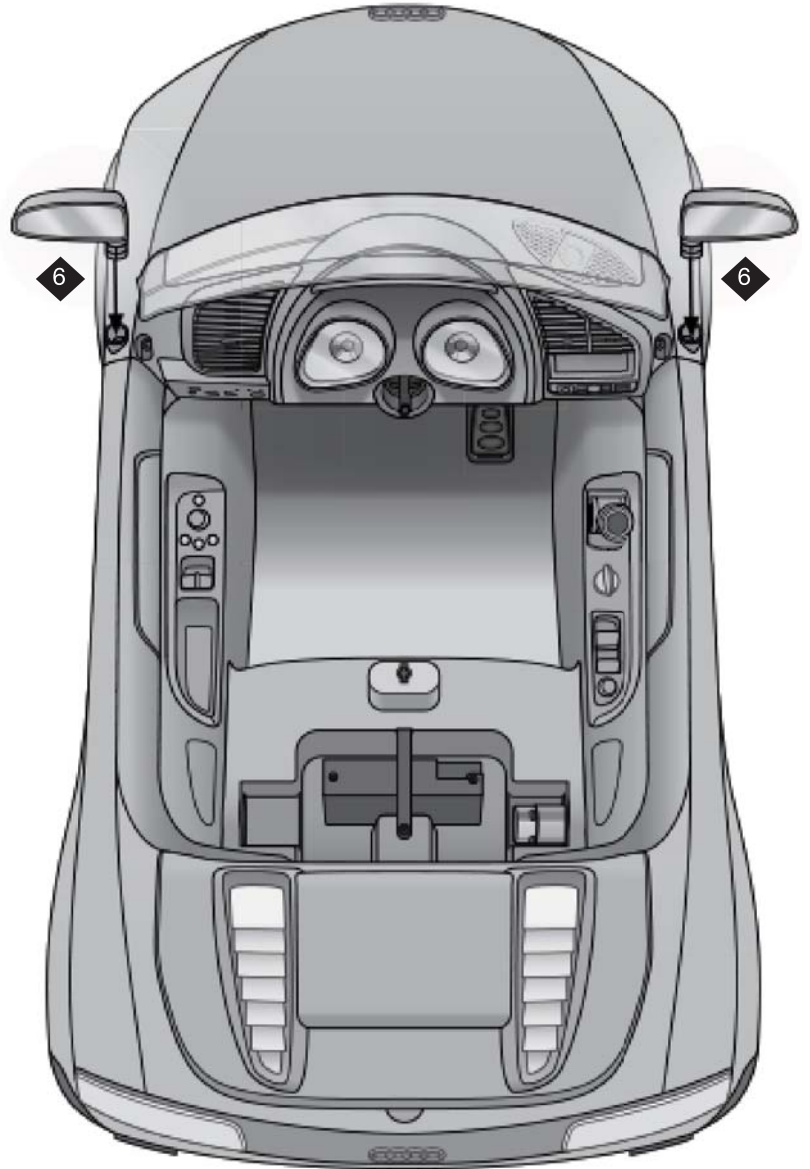

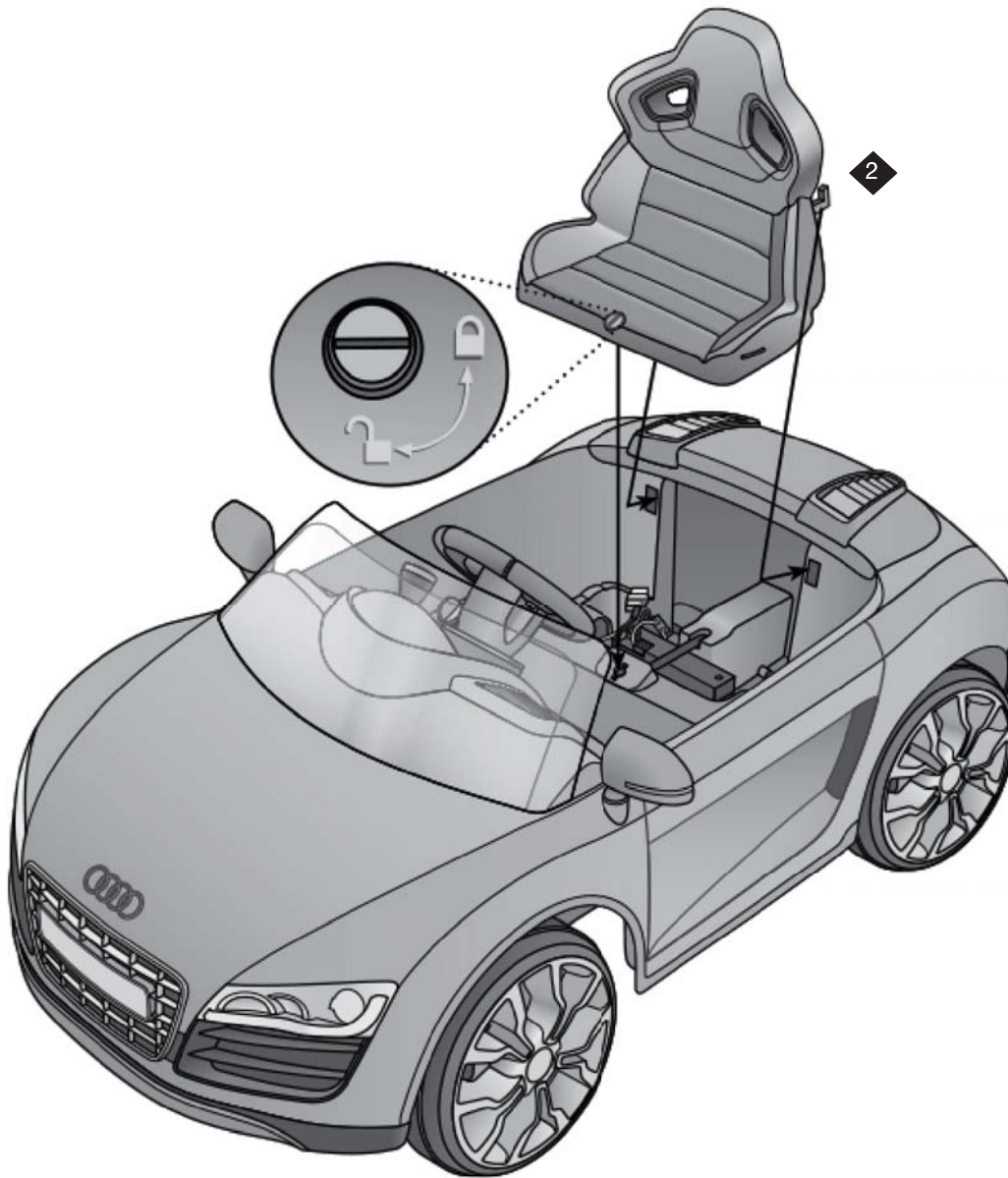

1. Ensure the lock on the car seat (2) is in the unlock position
2. Align the two hooks on the back of the car seat (2) with the holes on the back of the battery compartment
3. Insert the hooks into the holes and rotate the seat down into place
4. Use a flat head screwdriver or a coin to turn the seat to the locked position

# 16 Operation Instructions

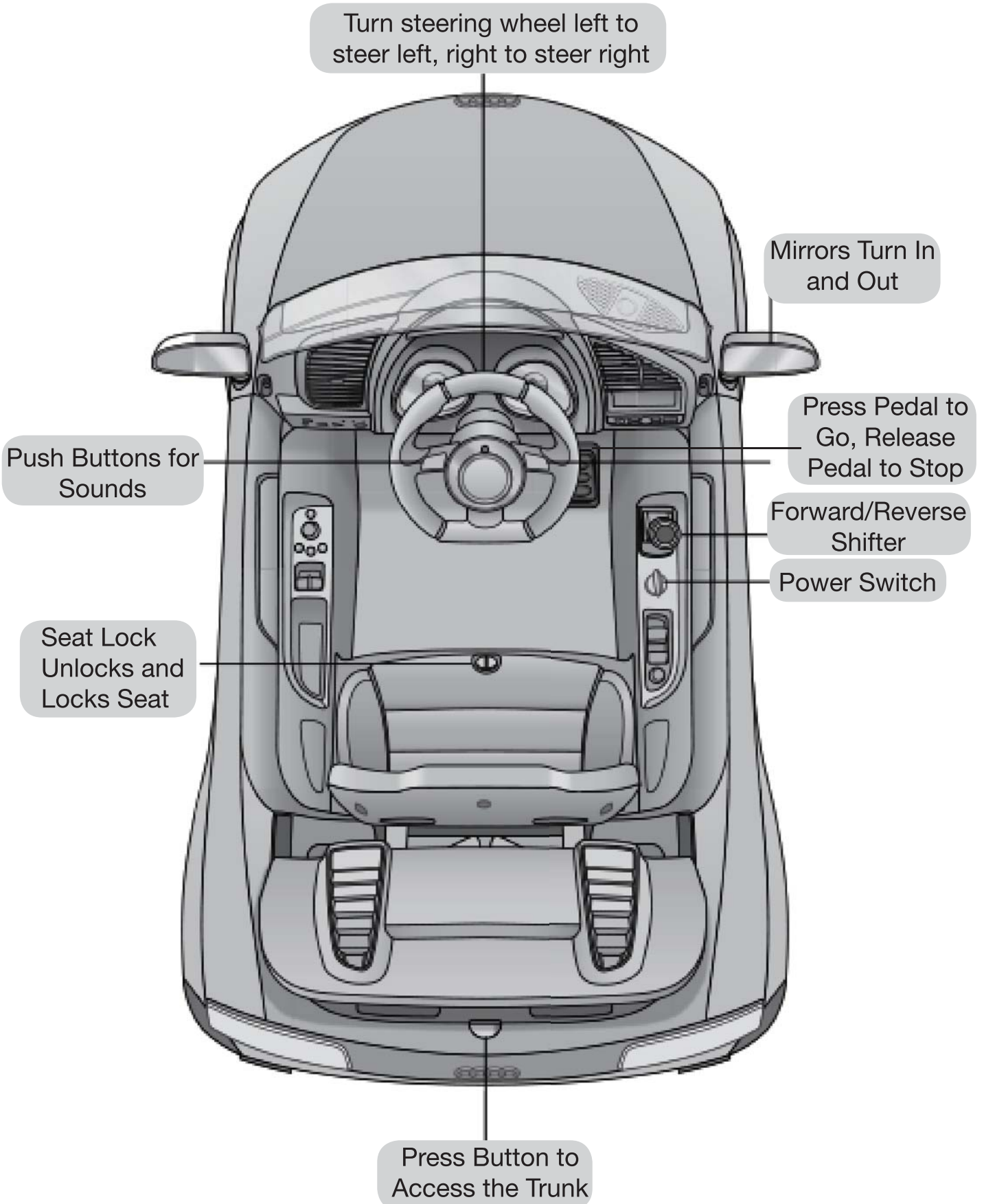



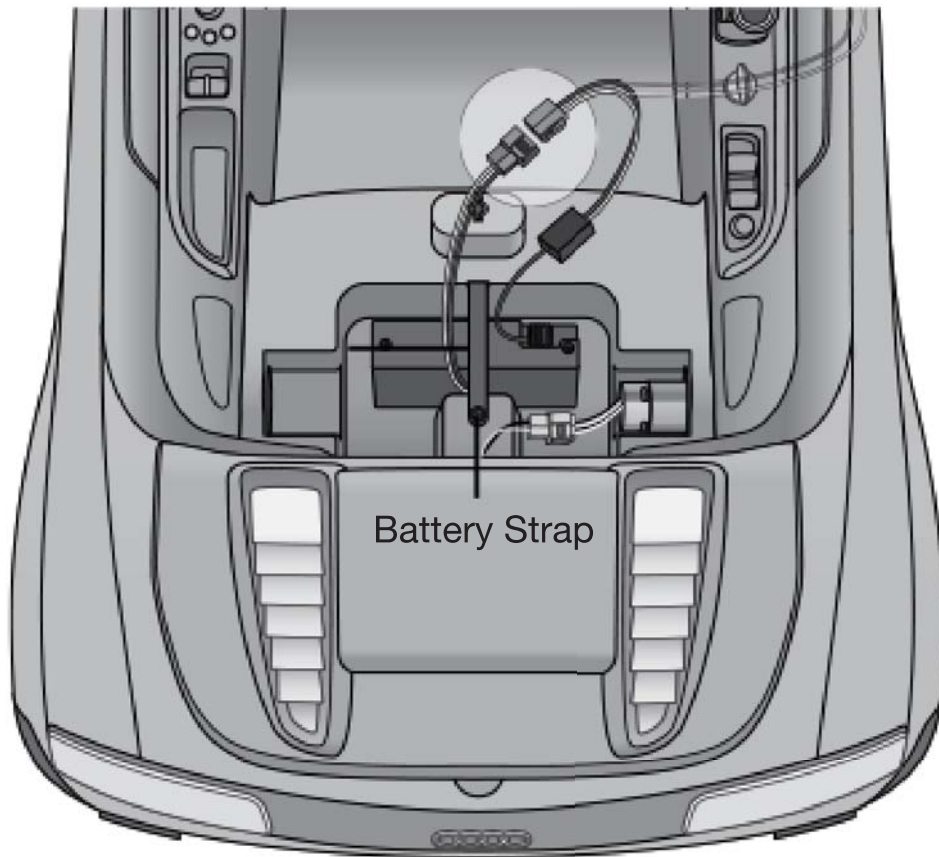

1. Unlock and remove the seat
2. Disconnect the red battery connector from the red engine connector
3. Loosen and remove the screw from the battery strap using a Phillips screwdriver
4. Slide the battery strap out from the battery strap slot
5. Remove the battery

Note: It is not necessary to remove the battery for charging. However, if the battery does not reach the outlet, then it can be removed for charging.

# 18 Maintenance

## Important Battery and Charger Information

- Only an adult who has read and understands the safety warnings may handle and operate the battery and battery charger. Keep away from children.
- Charge the battery for 24 hours before using the vehicle for the first time.
- Recharge the battery immediately after each use. Charge for at least 8-12 hours, but no more than 20 hours.
- Charge the battery at least once a month, even if the vehicle is not used or stored.
- Never leave the battery in a discharged condition.
- Connect the terminal of the battery and charger, then plug the charger into a 240V AC outlet.
- It is normal for the charger to heat slightly. If the charger rises above 71°C / 160°F, disconnect the charger and call Customer Service for assistance.
- Keep the charger away from water or excessive moisture to prevent short-circuiting.
- Only use the charger specified with the original item. **Do not charge the battery with any other charger.**
- Do not attempt to recharge non-rechargeable batteries with the original charger.
- **Do not replace the battery with any other battery, or the warranty will be voided.** If you need a replacement battery, see Page 23 for replacement information.
- Remove damaged batteries from the car immediately. Recycle or dispose of the used batteries responsibly.
- Do not short circuit the supply terminals.
- Do not leave the battery connected in the vehicle for extended periods of time when the vehicle is not being used. Disconnect the battery connector from the engine connector before storing.
- The vehicle is equipped with a thermal fuse to protect the electric circuit. If the vehicle cuts out, turn the vehicle off and on to reset.

- Regularly inspect all vehicle parts to ensure they are in good working condition.
- Regularly inspect the charger, cord, plug, and other related parts for damage.
- Remove any damaged parts and immediately contact Customer Service for replacement parts. See Service and Repairs on Page 23 for more information.
- DO NOT operate the vehicle if there are any damaged parts.
- Carefully clean the vehicle with a damp cloth and mild soap. Do not get water in or near any electrical parts. Do not wash the vehicle with a hose.
- Store the vehicle indoors or use a tarp to cover it. Keep away from stoves, heaters, or other sources of heat.

## 20 Troubleshooting Guide

Completely read through the manual and troubleshooting guide before contacting Customer Service.

Problem	Potential Cause	Solution
Vehicle does not run	Battery is low	Recharge the battery
	Thermal fuse tripped	Reset fuse
	Snap pins are loose	Tighten snap pins
	Loose wires or loose connectors	Ensure the battery connectors are securely attached. If wires are loose, contact Customer Service for repairs
	Battery is dead	Call Customer Service for replacement battery
	Electrical system is damaged	Call Customer Service for repairs
	Motor is damaged	Call Customer Service for repairs
Vehicle only runs for a short time	Undercharged battery	Ensure a secure connection when the battery is recharging. Recharge for at least 8-12 hours
	Overcharged battery	Never charge the battery for more than 30 hours
	Battery is old	Replace battery
Vehicle runs slowly	Battery is not fully charged	Ensure a secure connection when the battery is recharging
	Battery is old	Call Customer Service to order replacement battery
	Too much weight on vehicle	Reduce weight on vehicle 35kg (77lbs max)
	Harsh conditions	Operate the vehicle on level ground and safe surfaces

Problem	Potential Cause	Solution
Vehicle needs a push to start	Loose wires or loose connectors	Ensure the battery connectors are securely attached. If wires are loose, contact Consumer Service for repairs
	“Dead spot” on motor	A “dead spot” means electricity is not being delivered to the terminal. Contact Consumer Service for repairs
Difficulty shifting	Attempting to shift while vehicle is moving	Stop the vehicle before shifting
Motor or gear box making grinding noises	Motor or gear damage	Contact Consumer Service for repairs
Battery will not recharge	Charger is not plugged in	Plug in the charger to a functional wall outlet
	Charger is not working	Call Consumer Service for a replacement
	Loose connector or loose adapter	Check that the connectors are securely plugged in to each other
Battery makes bubbling noise while recharging	This is normal	No action required
Charger is warm	This is normal	No action required

If your product requires service, repairs or replacement parts, please contact Hunter Products Customer Service.

Hours: 9 AM - 5 PM, Monday - Friday

Phone: 1800 224 094

Email: [enquiries@hunterproducts.com.au](mailto:enquiries@hunterproducts.com.au)

Web: [www.electricrideon.com.au](http://www.electricrideon.com.au)

**WE WILL REQUIRE PROOF OF PURCHASE.** Please save your sales receipt.

## Hunter Products Warranty Against Defects:

Hunter Products  
Level 2, 424 Warrigal Rd | Moorabbin VIC 3189  
1800 224 094  
enquiries@hunterproducts.com.au  
www.hunterproducts.com.au

Hunter Products warrants this item against defects in material and workmanship from original date of purchase for a period of One (1) Year. A proof of purchase must be given when claiming this warranty; the original Sales Receipt is considered such proof.

Hunter Products' warranty covers new products if a defect arises and a valid claim is received within the One (1) Year warranty period. At its own discretion, Hunter Products will either:

- Repair the product at no charge, using new or refurbished replacement parts,
- Replace the product with a product that is new; or has been manufactured from new or serviceable used parts and is equivalent to the original product,
- Refund the original purchase price of the product.

Our goods come with guarantees that cannot be excluded under the Australian Consumer Law. You are entitled to a replacement or refund for a major failure and for compensation for any other reasonably foreseeable loss or damage. You are also entitled to have the goods repaired or replaced if the goods fail to be of acceptable quality and the failure does not amount to a major failure.

For all warranty enquiries please contact Hunter Products Customer Service at enquiries@hunterproducts.com.au or free-call 1800 224 094.

### EXCLUSIONS:

This warranty does not apply to:

- Damage caused by misuse, accident or abuse.
- Damage caused by service performed by anyone other than Hunter Products.
- A product or part that has been modified without the written permission of Hunter Products.

### WARRANTY DOES NOT COVER:

- Product repair and/or part replacement because of improper installation, connections to improper voltage supply abuse, neglect, accident, unauthorized repair or other cause not within control of Hunter Products.
- Damage or claims for products not being available for use, or for lost data or lost software.
- Damage occurring to product during shipping.
- A product that requires modification or adaptation to enable it to operate in any country other than the country it was designed, manufactured, approved and/or authorised for; or repair of products damaged by the modifications.
- Product lost in shipment and no signature verification receipt can be provided.
- Failure to operate per Owner's Manual.