

OWNER'S MANUAL

READ AND UNDERSTAND THIS ENTIRE MANUAL BEFORE USING!

Monster Jam Grave Digger 6V Replica Quads

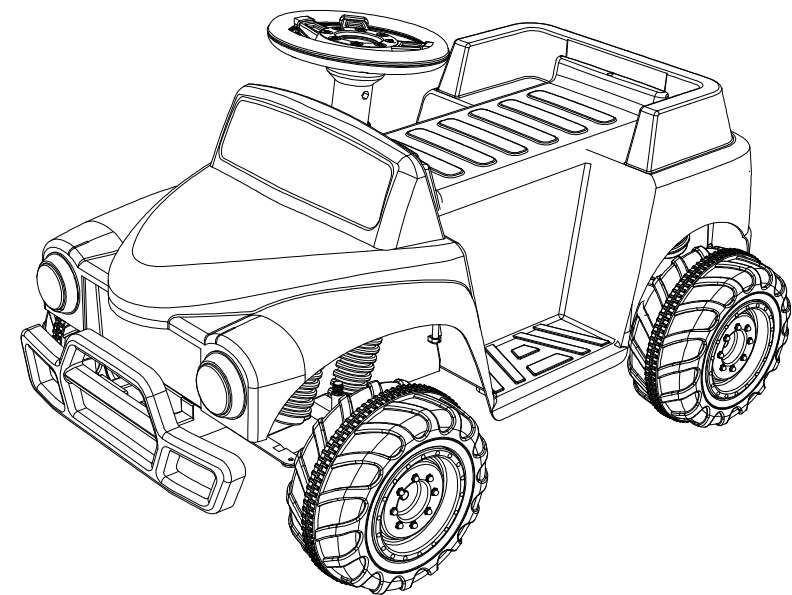

BOX CONTENTS:

TOY QUAD WITH BATTERY
DECAL
CHARGER
SPANNER
OWNER'S MANUAL

SUITABLE FOR 3 YEARS+
MAXIMUM USER WEIGHT: 30KG(66.14LBS)



WARNING:

ADULT ASSEMBLY AND SUPERVISION REQUIRED.
BEFORE FIRST TIME USE, CHARGE THE BATTERY FOR AT LEAST 12 HOURS.
PLEASE KEEP THIS MANUAL FOR FUTURE REFERENCE AS IT CONTAINS
IMPORTANT INFORMATION.



Hunter
Products

MANUFACTURED UNDER LICENSE BY HUNTER PRODUCTS PTY LTD.

DIRECTORY

(A) BEFORE USE - - - - -	P1
(B) SPECIFICATION - - - - -	P1
(C) PRECAUTIONS - - - - -	P2
(D) EXPLODED DIAGRAM - - - - -	P3
(E) PARTS - - - - -	P4
(F) ASSEMBLY DIAGRAM - - - - -	P5-P6
(G) FUSE - - - - -	P7
(H) CHARGING AND BATTERY SAFETY - - - - -	P7-8
(I) CARE AND MAINTENANCE - - - - -	P9
(J) TROUBLESHOOTING GUIDE - - - - -	P9
(K) OPERATION AND FUNCTION - - - - -	P10
(L) HOW TO INSTALL THE AA BATTERY - - - - -	P11
(M) SERVICE & WARRANTY - - - - -	P12

(A) BEFORE USE

Please read this manual carefully for important safety information and operating instructions before using your vehicle.

(B) SPECIFICATION

Product size	89*58*54cm
User's proper age	suitable for children around 3+ years old
Loading limitation	30 kgs
Speed	2.5-3.5 km/hr
Battery Spec	6V 7AH

Power Mode	Rechargeable
Charging Spec	6V 1000mA
Charging Time	8-12 hours
Fuse Spec	Self-resetting fuse
Power life	280 times charging

(C) PRECAUTIONS



WARNING: ASSEMBLY

YOUR NEW VEHICLE REQUIRES ADULT ASSEMBLY.

Read entire instructions carefully before assembling this product. Children can be harmed by small parts, sharp edges and sharp points in the vehicle's unassembled state, or by electrical items. Care should be taken in the unpacking and assembly of the vehicle. Children should not handle parts, including the battery, or help in assembly of the vehicle.



WARNING: RIDING HAZARD

- Not to be used in traffic.
- Never ride at night.
- Keep children within safe riding areas.
- These areas must be:
 - Away from swimming pools and other bodies of water to prevent drowning.
 - Generally level to prevent tipovers.
 - To reduce the risk of injury, adult supervision is required. Never use in roadways, near motor vehicles, on or near steep inclines or steps, swimming pools or other bodies of water. Do not use on gravel surfaces. Only use on smooth surfaces.
 - Always wear protective clothing and shoes. Never allow more than 1 rider at a time.
- Riding Rules:
 - Make sure children know and follow these rules for safe driving and riding.
 - Always sit on the seat.
- It is recommended that the rider always wears safety equipment such as fitted helmet when riding the vehicle.
- Use this vehicle **ONLY** outdoors. Most interior flooring can be damaged by riding this vehicle indoor



WARNING: SAFE DRIVING

Before children use this vehicle, an adult should carefully evaluate the driving area as well as the child's skill level and ability to drive the vehicle safely.

Teach appropriate safety rules to your child before allowing operation of this vehicle. These rules should also be reviewed with other playmates who want to drive the vehicle.

- A child who is not sitting on the seat could fall off, cause a tip over or block the driver's view.
- Only operate the vehicle in the daytime in a well-lit area.
- Driving near steep inclines can cause:
 - The vehicle to gain unsafe speed, even if the pedal is released to stop.
 - The vehicle to tilt and tip over.
 - The wheels to lose traction, causing the vehicle to slip.
 - The vehicle could roll backwards at an unsafe speed.
- Never put anything near any moving parts, rotating parts, such as motors, gear boxes and wheels, as these can snag fingers, hair, etc., and cause serious injury.
- Do not allow operation of the vehicle when it is on its side or in an upside-down position.
- Do not operate the vehicle near flammable vapors (gasoline, paint thinner, acetone, liquid wax, etc.). The vehicle's electrical switches, like most electrical switches, emit an internal spark when first turned on or turned off, which could cause an explosion or fire.
- To prevent unsupervised use of the vehicle, disconnect the motor harness from the battery when the vehicle is not in use.
- The toy should be used with caution since skill is required to avoid falls or collisions causing injury to the user or third parties.

(D) EXPLODED DIAGRAM

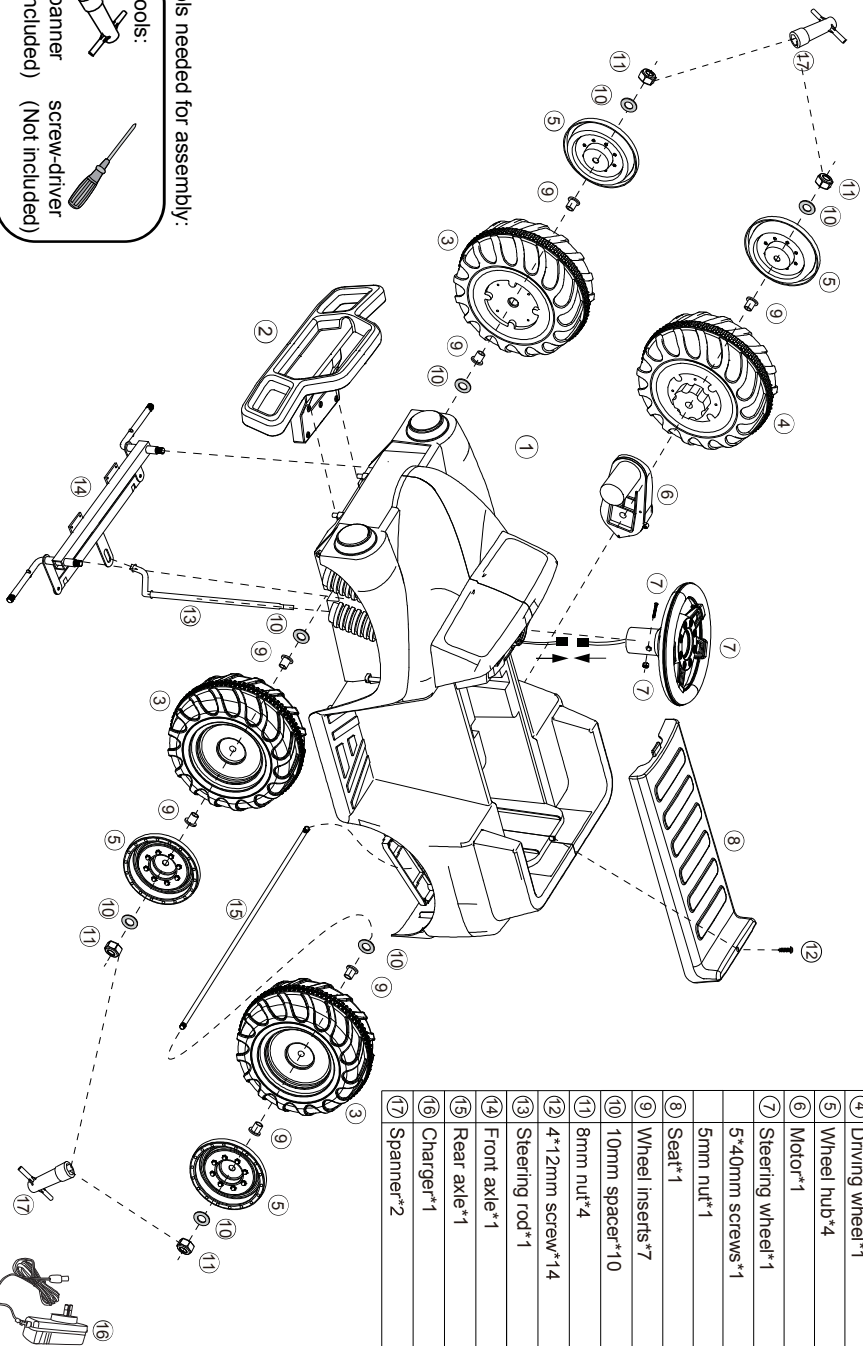









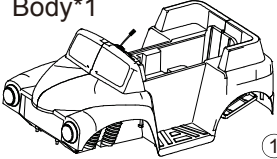
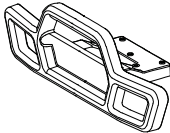

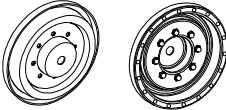
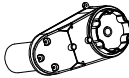

①	Body*1
②	Front bumper*1
③	Wheel*3(not gear attachment)
④	Driving wheel*1
⑤	Wheel hub*4
⑥	Motor*1
⑦	Steering wheel*1
⑧	5*40mm screws*1
⑨	5mm nut*1
⑩	Seat*1
⑪	Wheel inserts*7
⑫	10mm spacer*10
⑬	8mm nut*4
⑭	4*12mm screw*14
⑮	Steering rod*1
⑯	Front axle*1
⑰	Rear axle*1
⑱	Charger*1
⑳	Spanner*2

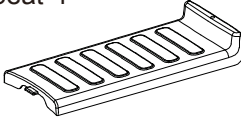
Tools needed for assembly:

- Tools:
 spanner (Included)
 screw-driver (Not included)

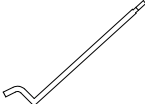
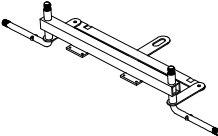
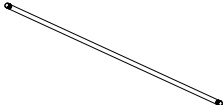
(E) PARTS

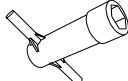
<p>Body*1</p>  <p>①</p>	<p>Front bumper*1</p>  <p>②</p>	<p>Wheel*3(not gear attachment)</p>  <p>③</p>
<p>Driving wheel*1</p>  <p>④</p>	<p>Wheel hub*4</p>  <p>⑤</p>	<p>Motor*1</p>  <p>⑥</p>
<p>Steering wheel*1</p>  <p>5*40mm screws*1</p>  <p>⑦</p>		<p>5mm nut*1</p>  <p>⑦</p> <p>Seat*1</p>  <p>⑧</p>
<p>Wheel inserts*7</p>  <p>⑨</p>	<p>10mm spacer*10</p>  <p>⑩</p>	<p>8mm nut*4</p>  <p>⑪</p>
<p>4*12mm screw*14</p>  <p>⑫</p>	<p>Steering rod*1</p>  <p>⑬</p>	<p>Front axle*1</p>  <p>⑭</p>
<p>Rear axle*1</p>  <p>⑮</p>	<p>Charger*1</p>  <p>⑯</p>	<p>Spanner*2</p>  <p>⑰</p>

(F) ASSEMBLY DIAGRAM

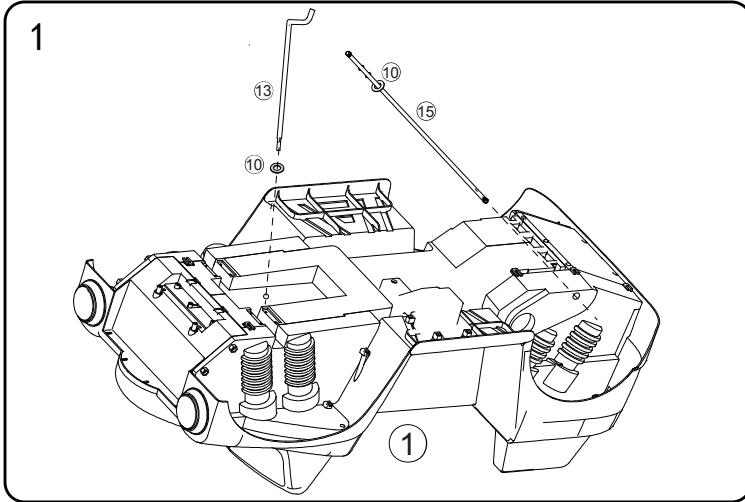

1. Remove all the parts from the rear axle.
 - (a) Slide a $\text{Ø}10$ spacer onto the rear axle from the longer end.
 - (b) Insert the rear axle with a $\text{Ø}10$ spacer into the smaller hole on the rear of the vehicle from Right Hand Side (standing at back of vehicle).

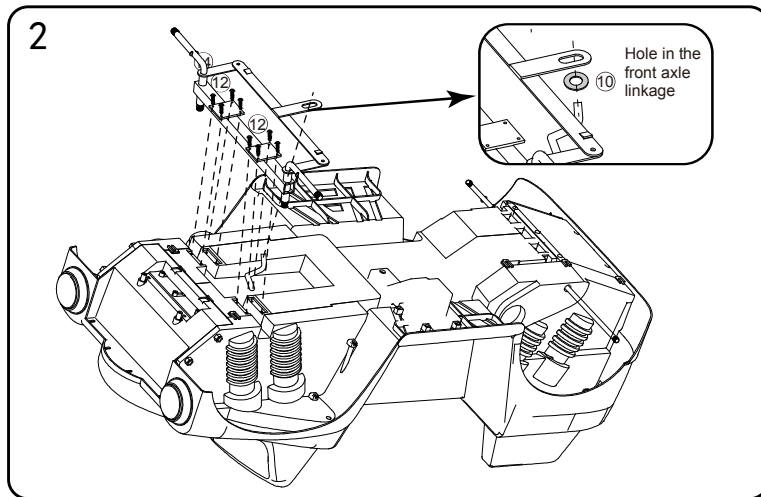

2. The Front Axle was factory assembled, but it need to be reset when you begun assembling. Turn the vehicle body over fit the front axle onto the front side of vehicle. If the side support does not seem to fit, change the other one and try again! Then tighten eight $\text{Ø}4 \times 12\text{MM}$ round head screws to secure it with a screwdriver.

(F) ASSEMBLY DIAGRAM

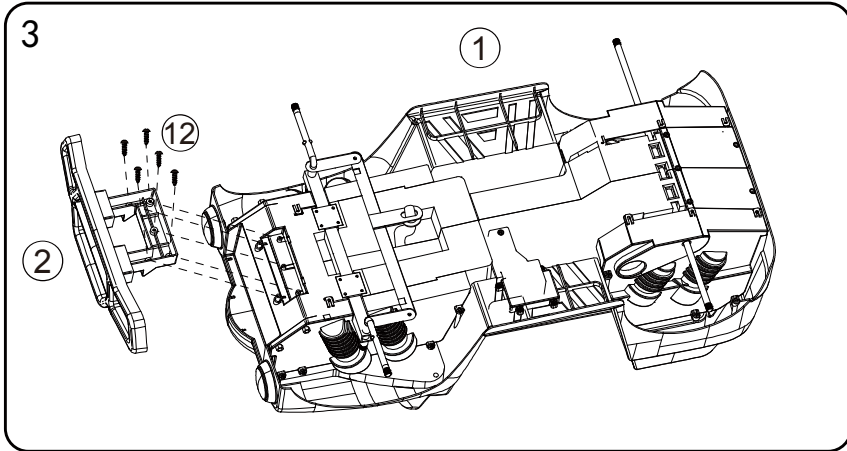

3. First put the front bumper in the direction shown in the corresponding position of the body, and then fix it with five screws.

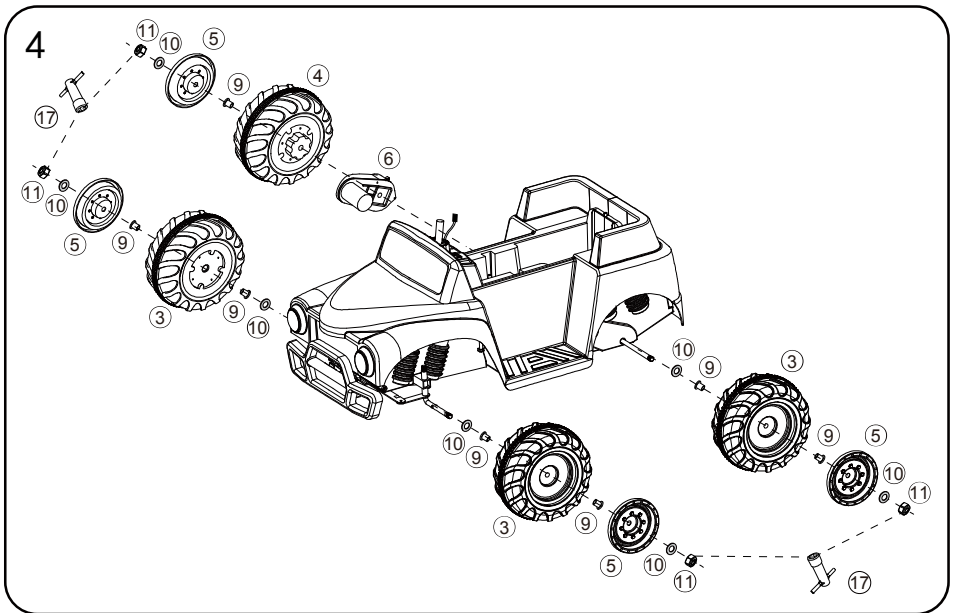

4. Each component is arranged in the front and rear shafts in sequence according to the instruction of the drawing, and then tighten the nut with a wrench

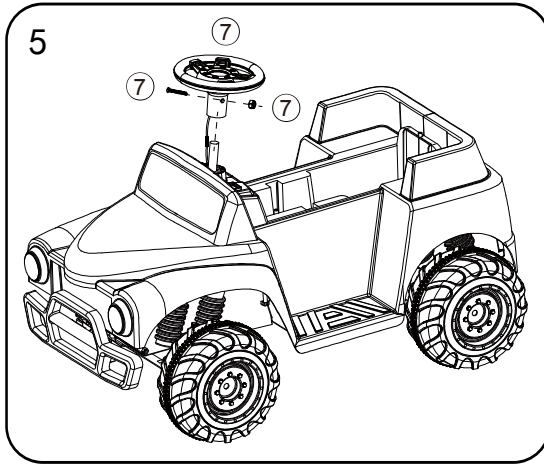

5. First, screw down *7 screw from the the steering wheel and then aim the hold on the steering wheel to the steering rod, the steering wheel of the hole in the direction of the hole on the rod, and then fixed with *7 screw.

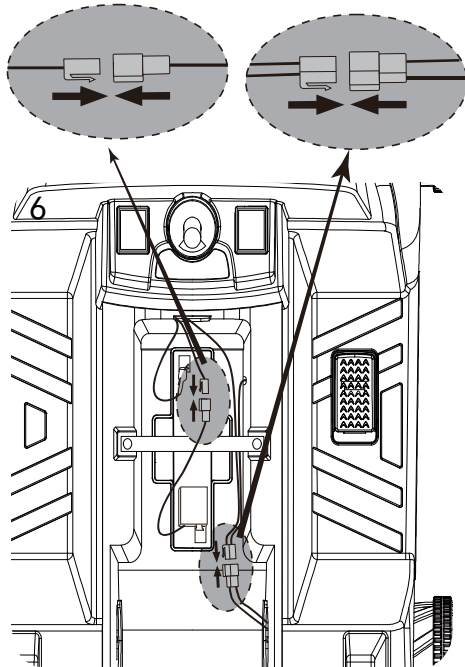

6. Plug the body's two core motor plugs each other, and then put the battery's red plug into the battery.

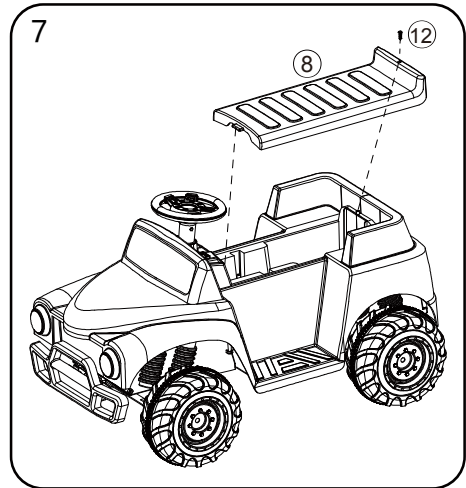

7. Insert the card in the front of the seat into the hole of the body and screw it up with one screw.

(G) FUSE

The vehicle uses a self-tapping fuse.

When overloading or improper use, the fuse will automatically be “triggered” and shut down operation of the vehicle, wait approximately 10~20 seconds before trying to operate the vehicle again.

To avoid the shut down, please pay attention to:

- (1) The maximum weight limit of the vehicle is 30KG.
- (2) Do not tow anything behind the vehicle.
- (3) Do not immerse in liquid, it may cause the short circuit.
- (4) Do not revise the vehicle’s circuit or the structure.
- (5) Do not use a different specification fuse.

(H) CHARGING AND BATTERY SAFETY

As shown in below diagram, put the charger into the vehicle’s charging hole, and the power plug into the matched stable AC power.

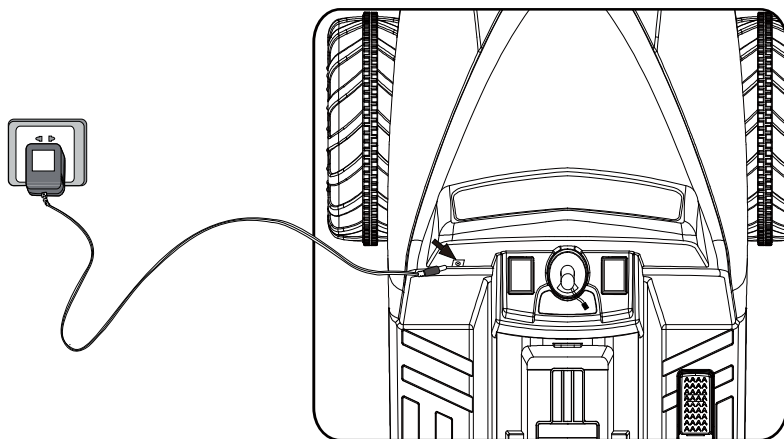

! WARNING: ELECTRICAL HAZARD

- The battery must be handled by adults only. The battery is heavy and contains sulfuric acid (electrolyte). Dropping the battery could result in serious injury.
- Battery can fall out and injure a child if vehicle tips over. Always use battery retainer.
- Never modify the electrical system. Alterations could cause a fire resulting in serious injury and also ruin the electrical system.
- Use of the wrong type of battery or charger may cause a fire or explosion resulting in serious injury.
- Never allow children to charge the battery. Battery charging must be done by adults only.
- Examine the battery, charger and their connectors for excessive wear or damage each time you charge the battery. If damage or excessive wear is detected, do not use the charger or the battery until you have replaced the worn or damaged part.
- Read the safety instructions on the battery.



CAUTION: BATTERY CHARGING

- Use the charger in dry locations only.
- Make sure you charge the battery for 12 hours using the enclosed 15 volt charger before operating your vehicle for the first time. Charge the battery about 8 hours after each use of the vehicle. Never charge the battery longer than 16 hours. Failure to follow these instructions may damage your battery.
- Before charging the battery, examine the battery case for cracks and other damage which may cause sulfuric acid (electrolyte) to leak during the charging process. If damage is detected, do not charge the battery or use it in your vehicle. Battery acid is very corrosive and can cause severe damage to surfaces it contacts, including skin. Always use caution when charging.
- Do not place the battery on a surface (such as kitchen counter tops) which could be damaged by the acid contained inside the battery. Take precautions to protect the surface on which you place your battery.
- Charge the battery in a well ventilated area.

BATTERY SAFETY INFORMATION

In exceptional circumstances, batteries may leak fluids that can cause a chemical burn or injury, or ruin your product. To avoid battery leakage:

- Do not mix old and new batteries or batteries of different types.
- Insert batteries as indicated inside the battery compartment.
- Remove batteries during long periods of non-use. Always remove exhausted batteries from the product. Dispose of batteries safely. Do not dispose of this product in a fire. The batteries inside may explode or leak.
- Never short-circuit the battery terminals.
- Use only batteries of the same or equivalent type as recommended.
- Do not charge non-rechargeable batteries.
- If removable, rechargeable batteries are used, they are only to be charged under adult supervision.

BATTERY CARE

- If a battery leak happens, avoid contact with the leaking acid and place the damaged battery in a plastic bag.
- If acid comes in contact with skin or eyes, flush with cool water for at least 15 minutes and call a physician.
- Do not allow the battery to run down completely before charging.
- Charge the battery before storing the vehicle, and at least once per month, even if the vehicle has not been used.
- Always remove an exhausted battery from the vehicle. Battery leakage and corrosion can damage the vehicle.

BATTERY DISPOSAL



- This battery is a non-spillable sealed lead-acid battery. It must be recycled or disposed of in an environmentally sound manner.
- Do not dispose of a lead-acid battery in a fire. The battery may explode or leak.
- Do not dispose of a lead-acid battery in your regular, household trash. The incineration, landfilling or mixing of sealed lead-acid batteries with household trash is prohibited by law in most areas.
- Return an exhausted battery to a federal or state approved lead-acid battery recycler, such as a local seller of automotive batteries. Contact your local waste management officials for other information regarding the environmentally sound collection, recycling and disposal of lead-acid batteries.



- Protect the environment by not disposing of this lead-acid battery with household waste. Check your local authority for recycling advice and facilities.

(I) CARE AND MAINTENANCE

- Audits should check all screws, cap nuts and their protective coverings regularly and tighten as required. Check plastic parts on a regular basis for cracks or broken pieces.
- When vehicle is not used on a regular basis, the vehicle should be stored inside or under a protective cover. With the switch in the "off" position, pull out the battery to ensure circuit safety. Remember to charge the battery at least once per month while your vehicle is not in regular use.
- Avoid operating the vehicle in wet, rainy or snowy conditions.
- Avoid operating the vehicle on sand, loose dirt or gravel. Sand, loose dirt or gravel in the motors or electrical switches can cause them to jam, and could cause switch or motor failure.
- The vehicle can be wiped down with a soft, dry cloth.
DO NOT wipe vehicle with wax.
DO NOT wash the vehicle with soap and water or spray the vehicle with a hose. Water or moisture in the motors or electrical switches can cause them to corrode, and could cause switch or motor failure.
- DO NOT make modifications to this vehicle. When conducting maintenance, do not revise the vehicle's circuit and structure.
- ONLY use the battery and charger specified by the manufacturer.
- In the unstable supply voltage region, it is recommended to install a voltage stabilizer to protect the battery.

(J) TROUBLESHOOTING GUIDE

Problem	Possible Solutions
The vehicle does not move	<ul style="list-style-type: none"> • Charge the battery. (Charge battery after each use.) NOTE: vehicle will be cut off from electricity when charging. • Check all electrical connections. • Check if all switches are in the "on" position. • Check if foot pedal or manual button is stuck down so that it cannot be pressed. • The fuse may have been activated due to excessive weight or rough driving conditions. Wait approximately 10~20 seconds, and the vehicle will reset itself. • Check if there is debris blocking the wheels.
The vehicle begins to run slow	<ul style="list-style-type: none"> • Charge the battery. (Charge battery after each use.) • Only allow one rider at a time. DO NOT exceed child weight limit: 40kg total • Drive on level ground. • Battery may be old or not accepting a full charge. The battery will last from 1 to 3 years depending on care, use and environment. Replace with 6 Volt 7Ah battery only. • Check if there is debris blocking the wheels.
The vehicle runs erratically	<ul style="list-style-type: none"> • There may be a problem with the fuse, or you may have a damaged battery.
The charger feels warm when in use	<ul style="list-style-type: none"> • This is normal.
The gears sound very loud and/or are making a grinding noise.	<ul style="list-style-type: none"> • The gears may be broken.

(K) OPERATION AND FUNCTION

OPERATION

Forward-Reverse Switch:

- To move the vehicle forward, make sure the button is in forward position, then press down the foot pedal.
- To move the vehicle reverse, make sure the button is in reverse position, then press down the foot pedal.

High/Low speed switch:

- The switch operates the vehicle to move in low or high speed.

Foot Pedal:

- To move the vehicle, press down the pedal. To stop the vehicle, remove your foot from the pedal.

Function:

- The vehicle has light, engine start sound and horn function, Please connect the plug on steering wheel to car. Details please refer below pictures.

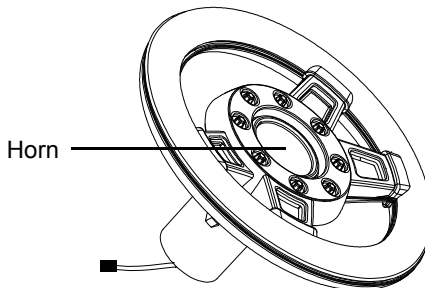
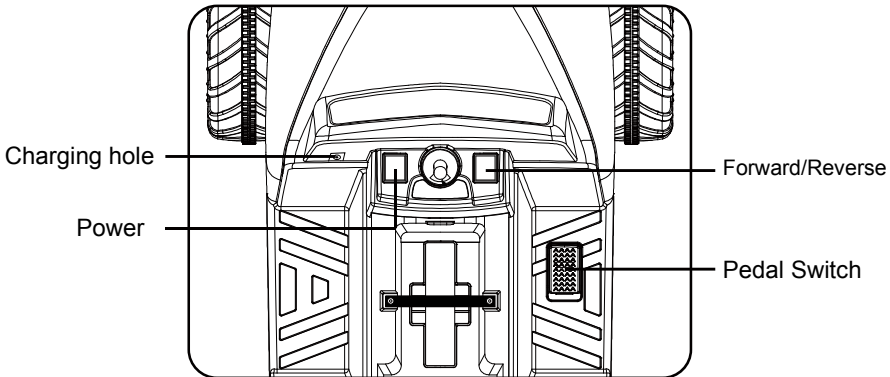

WARNING!

DO NOT mix old and new batteries.

DO NOT mix alkaline, standard (carbon-zinc), or rechargeable (nickel- cadmium) batteries.

Non-rechargeable batteries are not to be recharged

Batteries are to be inserted with the correct polarity.

Exhausted batteries are to be removed from the toy.

The supply terminals are not to be short-circuited.

Rechargeable batteries are only to be charged under adult supervision.

Rechargeable batteries are to be removed from the toy before being charged.

(M) SERVICE & WARRANTY

Our goods come with guarantees that cannot be excluded under the Australian Consumer Law. You are entitled to a replacement or refund for a major failure and for compensation for any other reasonably foreseeable loss or damage. You are also entitled to have the goods repaired or replaced if the goods fail to be of acceptable quality and the failure does not amount to a major failure.

This product is warranted against defective materials for 12 months from the date of purchase. Where a failure does not amount to a major failure, we are entitled to choose between providing you with a repair, replacement or refund. To obtain compensation, you would need to provide documentary evidence of the loss or damage suffered, and documentary evidence that such loss or damage was a reasonably foreseeable consequence of a failure by us to comply with a consumer guarantee under the Australian Consumer Law. Such evidence may include photographs, statutory declarations, receipts or reports (e.g. from your doctor), depending on the loss or damage.

In addition to all rights and remedies to which you may be entitled under the Competition and Consumer Act 2010 (Commonwealth) and any other relevant legislation, the manufacturer warrants this product to be free from defects in materials or workmanship for a period as stated on the packaging from the date of purchase.

In order to claim under this warranty, you will need to bring the product to the store of purchase, along with proof of purchase (typically this will be a receipt). Any cost incurred by you in bringing the product to the service desk will be borne by you. We will then, at our option, either repair or replace the product, or refund your money and take back the product.

Our liability under this manufacturer's warranty is subject to us being satisfied that a defect was caused by defective workmanship or materials, and was not caused by or substantially contributed to by other factors, or circumstances beyond our control, including (but not limited to) defective installation, maintenance or repair, alteration or modification of the product in any manner not recommended by the manufacturer or any neglect, misuse or excessive use.

The benefits conferred by this manufacturer's warranty are in addition to all rights and remedies conveyed by the Competition and Consumer Act 2010 (Commonwealth), and any other statutory rights to which you may already be entitled, and this warranty does not exclude, restrict or modify any such rights or remedies that are implied by law.

HUNTER PRODUCTS

Level 2, 424 Warrigal Road Moorabbin 3189

Ph: 1800 224 094

Email: enquiries@hunterproducts.com.au