

6Volt Ride On

Please read a manual in detail before using



- Maxium user weight:30kg
- Item No.1974
- Model No.:B06
- Continuous adult supervision required when using this product.
- Suitable for age 3+ years.
- Always wear helmet when riding.
- Your new vehicle requires adult assembly.
- Charging the battery can only be operated by adult all times.
- Before each use, charge the battery for at least 10 hours.
Charging of battery should only be done by an adult.
- Please keep this manual for future reference as it contains.
- Please note that this item does not have any sound functions.

Table of contents

1. Table of contents	-----
2. The Specification	-----
3. Parts	-----
4. Cautions for safety	-----
5. Parts Diagram	-----
6. Assembly Steps	-----
7. How to operate the vehicle	-----
8. Fuse	-----
9. Charging The Vehicle	-----
10. Maintaining Your Vehicle	-----
11. Trouble Shooting Guide	-----
12. Disposal Of Battery	-----

2.The Specification

Suitable age:	3+ Years	Battery:	6V 10AH *1
Load Capacity:	Under 30kg	Size of car:	112*75*58CM
Speed:	3~5KM/H	Power way:	Charging type
Charge:	Input:AC240V Output: DC 6V1000mA	Average battery life:	Approximately 300 times
Charge time:	8-12 Hours	Fuse	10A

PLEASE NOTE: IN CASE OF PRODUCT FAULT DO NOT RETURN THIS PRODUCT TO STORE.
PLEASE CONTACT HUNTER PRODUCTS CUSTOMER SERVICE TOLL FREE NUMBER: 1800 224 094

3.Parts list



1.Vehicle Body X1



2.Steering Wheel X1



3. Side mirrors X2



4.Armrest X2



5.Armrest clamp X2



6. Armrest cap covers X2



7. Seat X1



8.WingX1



9. Driving Wheel X1



10. Rear Wheel X1



11. Front Wheel X2



12.Gear box with motor X1



13. Assembly packageX1
(Cover x4
Spanner x1)



14.Charger X1

**PLEASE NOTE: IN CASE OF PRODUCT FAULT DO NOT RETURN THIS PRODUCT TO STORE.
PLEASE CONTACT HUNTER PRODUCTS CUSTOMER SERVICE TOLL FREE NUMBER: 1800 224 094**

4. Cautions for safety

1. While riding, adult supervision is required at all times.
2. Always wear a helmet when riding.
3. Do not drive near roads or on the footpath.
4. It is not recommended to ride this vehicle on sandy or soft surfaces.
5. It is not recommended to drive the vehicle on wet surfaces or slopes greater than 15 degrees.
6. Do not use this vehicle outdoors when it is raining.
7. Make sure you come to a complete stop before changing directions from forward to back.
8. Don't allow children to operate the charger or play with the battery.
9. Clean the vehicle with a dry cloth only.
10. Please follow the correct weight and age limits allowed to drive this vehicle.
11. It is prohibited to change the circuit or add other electric parts.
12. Adults must teach their children about safe driving procedures.
13. Please cut off the power when stop driving.
14. Check the seat. Whether it has been fitted and secured with a bolt before driving.
15. Inspect wires and connections of the vehicle periodically.
16. Charging the battery should only be done by adults.
17. Charging plug is located underneath the seat.
Check all wire plugs and connections periodically.
18. In order to avoid accidents, please ensure the vehicle is safe before riding.
19. Do not let any child touch the wheels or be near them when the car is moving .
20. It is recommended that your product be stored inside. If you need to **store** outdoors, please ensure that the item is fully covered by a tarp to avoid damage to the body and electrical components.

**PLEASE NOTE: IN CASE OF PRODUCT FAULT DO NOT RETURN THIS PRODUCT TO STORE.
PLEASE CONTACT HUNTER PRODUCTS CUSTOMER SERVICE TOLL FREE NUMBER: 1800 224 094**

4. Parts diagram

Note : some parts shown are assembled on both sides of vehicle

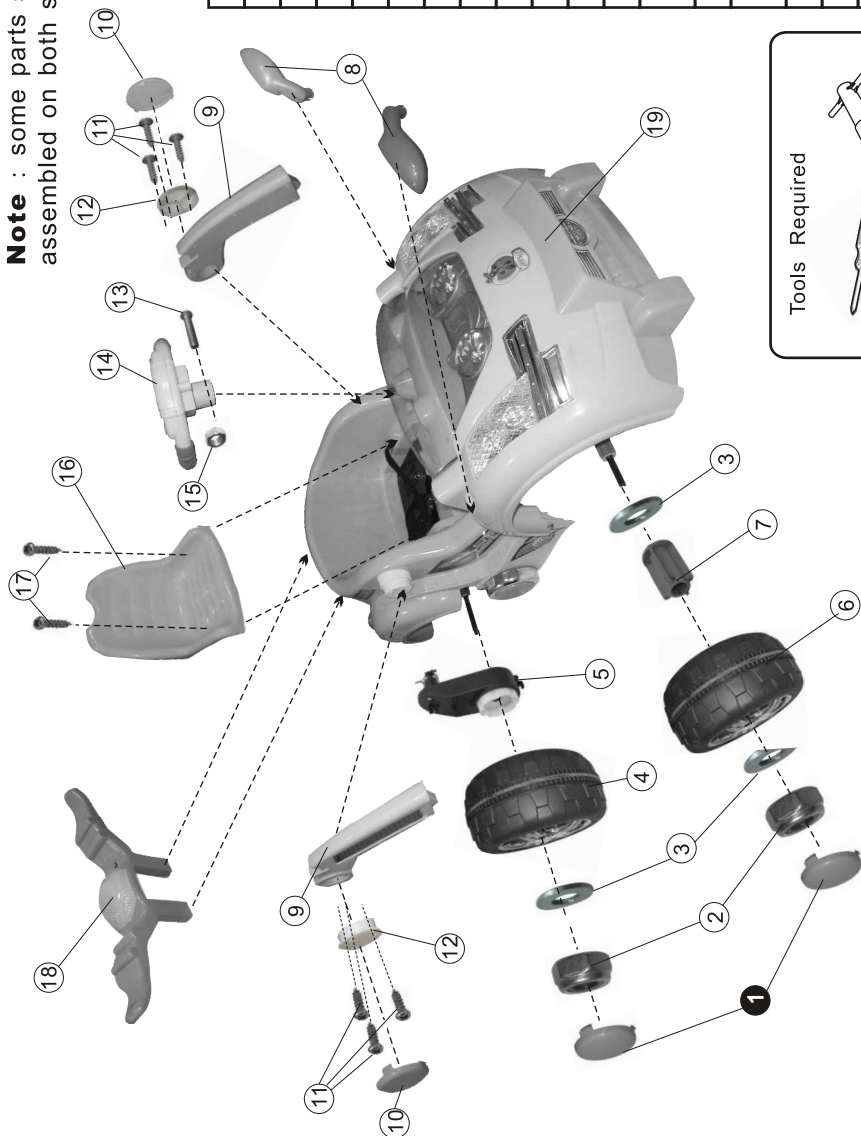

Tools Required

- Screwdriver (not included)
- Spanner

PLEASE NOTE: IN CASE OF PRODUCT FAULT DO NOT RETURN THIS PRODUCT TO STORE. PLEASE CONTACT HUNTER PRODUCTS CUSTOMER SERVICE TOLL FREE NUMBER: 1800 224 094

6. Assembly Steps

WARNING: Choking Hazard

Plastic bags can be dangerous. To avoid danger of suffocation. Keep this bag away from babies and children.

Please identify all parts before assembly and save all packaging material until assembly is complete to ensure that no parts are discarded.

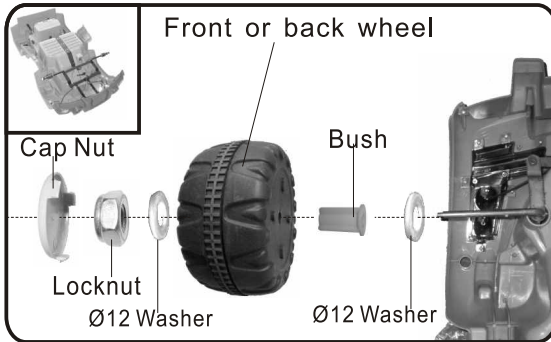

1. Assembly of the front & back wheels

- First turn the vehicle body over.
- Screw off the nut from the axle, take the Ø12 washer and round bushing out (leave on 1 washer)
- Slide the round bush (ring end first) onto the axle.
- Slide the wheel onto the axle.
- Slide the Ø12 washer onto the axle.
- Fasten the locknut using a spanner. Then place on the wheel cap cover. Then continue this for the other 2 wheels not including the rear driving wheel.

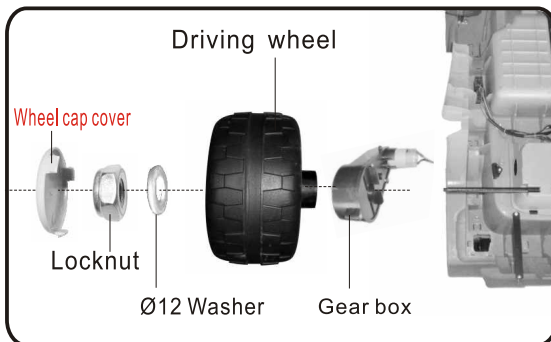

2. Assembly of the rear driving wheel

- Slide the gear box onto the rear axle.
- Slide the driving wheel onto the rear axle. Ensure the driving wheel inserts onto the pins of the gear box.
- Slide the 12 washer onto the rear axle
- Fasten the locknut with a spanner. Lastly insert the cap cover onto the wheel.

**PLEASE NOTE: IN CASE OF PRODUCT FAULT DO NOT RETURN THIS PRODUCT TO STORE.
PLEASE CONTACT HUNTER PRODUCTS CUSTOMER SERVICE TOLL FREE NUMBER: 1800 224 094**

Battery Safety Information

- Do not mix old and new batteries or batteries of different types: alkaline, standard (carbon-zinc) or rechargeable (nickel-cadmium).
- Insert batteries as indicated inside the battery compartment.
- Remove batteries during long periods of non-use. Always remove exhausted batteries from the product.
- Never short-circuit the battery terminals.
- Non-rechargeable batteries are not to be recharged.
- Use only batteries of the same or equivalent type as recommended.
- Do not charge non-rechargeable batteries.
- Remove rechargeable batteries from the product before charging.
- If removable rechargeable batteries are used, they are only to be charged under adult supervision.

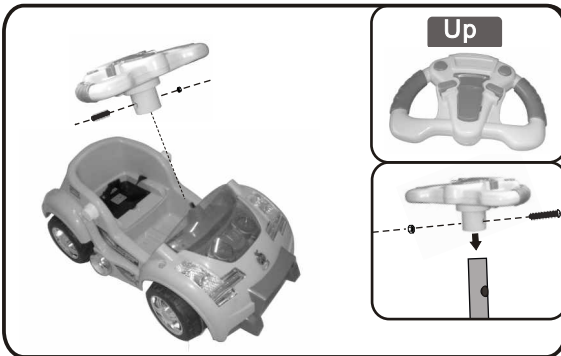

4 Assembly of the steering wheel

- Screw off the nut from the steering wheel. Fit the steering wheel onto the end of the steering column.
- Pay attention to the steering wheel front and back.
- Insert the bolt through the steering wheel and steering column, tighten the nut using a spanner.

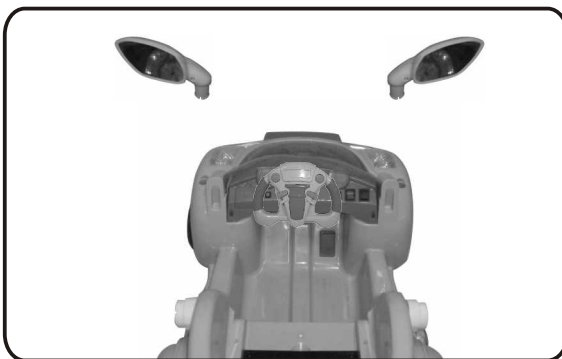

5 Assembly of the side mirrors

- Fit the tabs on the side mirrors into the slots on the front on the body of the vehicle.
- Push these in until you hear them click into place.

**PLEASE NOTE: IN CASE OF PRODUCT FAULT DO NOT RETURN THIS PRODUCT TO STORE.
PLEASE CONTACT HUNTER PRODUCTS CUSTOMER SERVICE TOLL FREE NUMBER: 1800 224 094**

6. Assembly of armrest

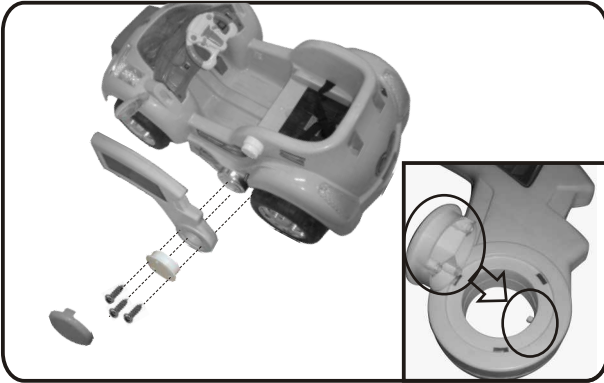

- Fit the armrest to the vehicle body .
- Fit the armrest clamp flute to the armrest.
- Insert three screws through the armrest clamp and into the armrest. Tighten the screws.
- Insert the arm rest covers into the armrest.
- Follow the same steps for the other side.

7 Connecting battery wires(1)

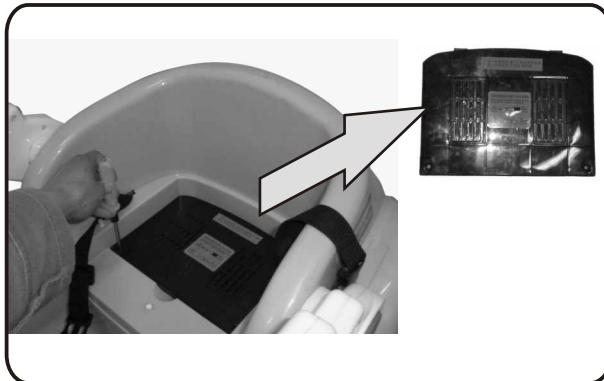

- Screw off the five screws from battery cover, remove it.

7 Connecting battery wires(2)

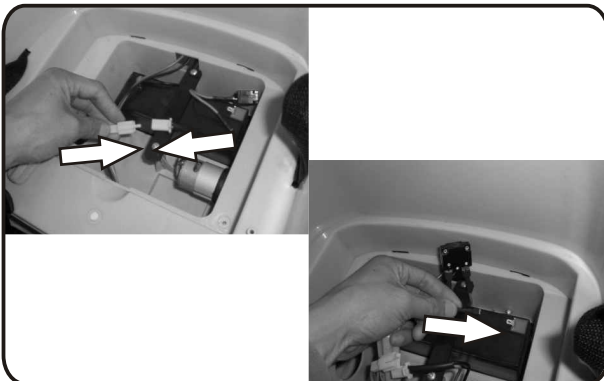

- Plug the power connector into battery terminal (red to red, black to black).
- Place the battery cover at the homologous position on the vehicle body. Insert two screws using a screwdriver.

**PLEASE NOTE: IN CASE OF PRODUCT FAULT DO NOT RETURN THIS PRODUCT TO STORE.
PLEASE CONTACT HUNTER PRODUCTS CUSTOMER SERVICE TOLL FREE NUMBER: 1800 224 094**

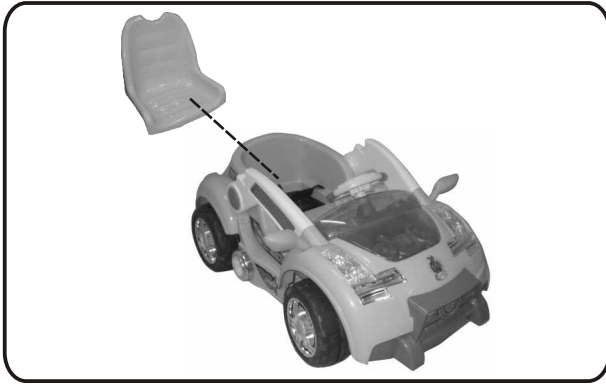

8 Assembly of the seat

- Place the seat on as per the image..
- Insert 2 screws and secure using a screwdriver.

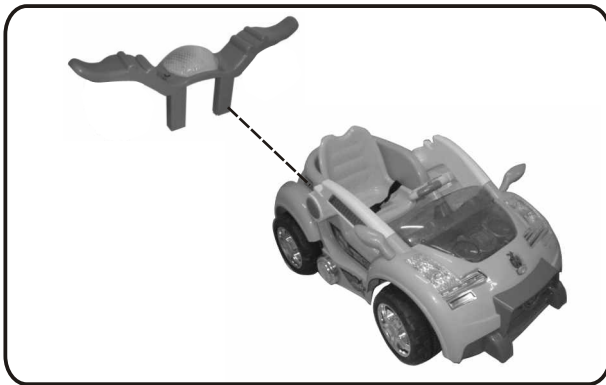

9 Assembly of the empennage

- Attach the tabs on the empennage into the slots on the back of the body of the vehicle.
- Push the empennage in until you hear it click into place.

**PLEASE NOTE: IN CASE OF PRODUCT FAULT DO NOT RETURN THIS PRODUCT TO STORE.
PLEASE CONTACT HUNTER PRODUCTS CUSTOMER SERVICE TOLL FREE NUMBER: 1800 224 094**

7. How To Operate The Vehicle

Once assembled ensure that the below is done:

- That the battery is installed well and that the power is working through this.
- That the battery has been charged for at least ten hours.
- That all screws are secure.
- Teach the appropriate safety rules to your child/children before allowing operation of this vehicle.

To reduce the risk of injury:

- Always wear a helmet when riding.
- Direct adult supervision required.
- Always sit on the seat.
- Always wears shoes.
- Never allow more than 1 rider and ensure that the rider is under maximum weight of 30 kg
- Keep Children within Safe Riding Areas:
Never use in roadway, near motor vehicles, on or near steep inclines or steps, swimming pools or other bodies of water;
- Use the toy only on flat surfaces. such as inside your house, garden or playground.
- Never use in the dark. A child could encounter unexpected obstacles and have an accident. Operate the vehicle only in the daytime or a well-lit area
- This vehicle has adjustable play seat belts. please instruct children how to tie the safety belt before using.

Use operation (refer to the sketch map of function)

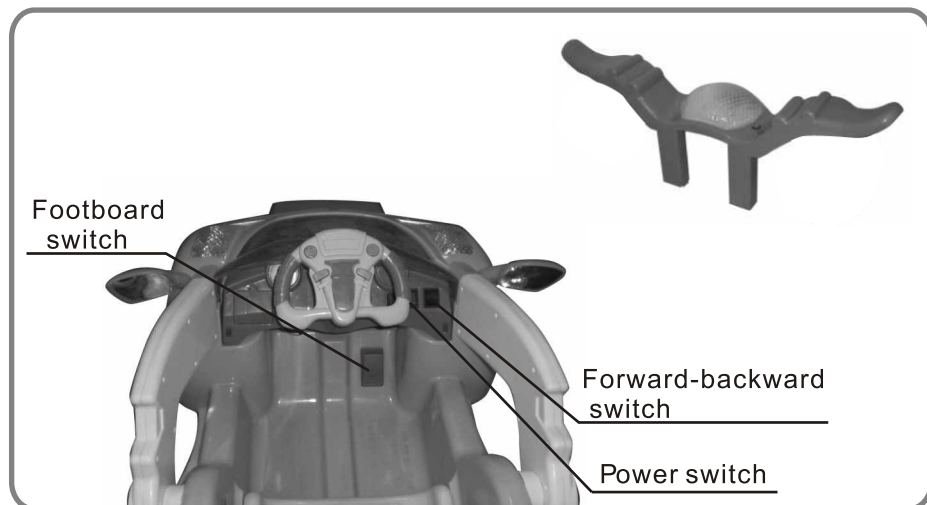

**PLEASE NOTE: IN CASE OF PRODUCT FAULT DO NOT RETURN THIS PRODUCT TO STORE.
PLEASE CONTACT HUNTER PRODUCTS CUSTOMER SERVICE TOLL FREE NUMBER: 1800 224 094**

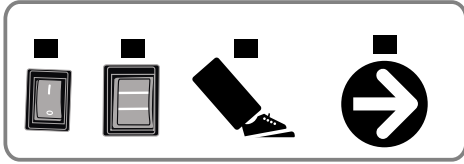

FORWARD

1. turn on the power switch
2. Press the "Forward-Reverse switch" button on the "Forward".
3. Press the accelerator pedal.
4. The vehicle goes forward.

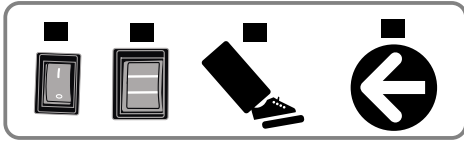

BACKWARD

1. Turn on the power switch.
2. Press the "Forward-Reverse switch" button on the "Reverse".
3. Press the accelerator pedal.
4. The vehicle will reverse.

NOTOCE:

- Ensure to teach child/children to wait until the vehicle is stopped before changing the direction or changing forward to reverse.
- Changing suddenly from forward and reverse can damage the vehicle or gurt the rider.

8. Fuse

The vehicle is equipped with a self-resetting fuse. When the vehicle is overloaded or operated incorrectly; the fuse will be cut off for 15-20 seconds before normal.

The self-resetting fuse is under the seat (Refer to the picture.)



**PLEASE NOTE: IN CASE OF PRODUCT FAULT DO NOT RETURN THIS PRODUCT TO STORE.
PLEASE CONTACT HUNTER PRODUCTS CUSTOMER SERVICE TOLL FREE NUMBER: 1800 224 094**

To avoid electric shock, follow these guidelines:

DO NOT overload the vehicle, Maximum weight allowed: 30kg

DO NOT tow any thing behind the vehicle.

DO NOT drive up steep slopes.

DO NOT drive into fixed objects, which may cause the wheels to spin, causing the motor to overheat.

DO NOT drive in very hot weather, components may overheat.

DO NOT allow water or other liquids to come in contact with the battery or other electric components.

DO NOT tamper with the electric system. Doing so may create a short circuit, causing the fuse to trip.

9. Charging The Vehicle

- The charging socket is on the back of the vehicle as per the image.
- Power must be turned off on the vehicle before charging.
- Before the first use, you should charge the battery for 8-10 hours. Do not recharge the battery for more than 20 hours to avoid overheating the charger.
- When the vehicle runs slowly, recharge the battery.
- After each use or once a month minimum recharge for 8 to 12 hours, 20 hours at most.

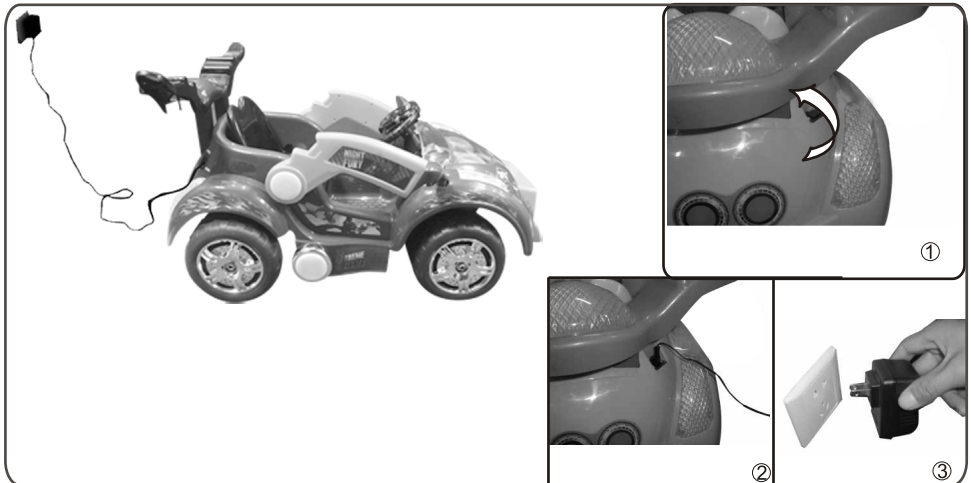

- 1 Open the cover of the socket (the socket on the back of vehicle).
- 2 Plug the charger plug into the socket.
- 3 Plug the charger plug into a wall outlet. The battery will begin charging.

**PLEASE NOTE: IN CASE OF PRODUCT FAULT DO NOT RETURN THIS PRODUCT TO STORE.
PLEASE CONTACT HUNTER PRODUCTS CUSTOMER SERVICE TOLL FREE NUMBER: 1800 224 094**

To recharge the battery:

- Battery charging must be done by adults only. Never allow children to charge the battery. A child could be injured by the electricity involved in charging the battery.
- Do not short circuit the battery.
- The charger and the battery are not a toy. Do not allow children to play with the charger and the battery.
- Only use the battery and charger specified by the manufacturer.
- Do not mix different types of batteries. Do not mix old and new battery.
- Do not open the battery and charger.
- Always secure the battery with the bracket. Battery can fall out and injure a child if vehicle tips over,
- The battery must be handled by adults only. The battery is heavy and contains sulfuric acid (electrolyte). Dropping the battery could result in serious injury.
- Do not allow the battery to drain completely, recharge the battery after each use or once a month if not used regularly.
- Before charging the battery check for wear or damage to the battery, charger, the connectors and other parts. If any damage is found, charger should be repaired or replaced immediately. Do not use a damaged charger.
- It is normal for the adaptor to feel warm during charging, but if the charger feels very hot, stop charging and check the battery and adaptor.

11. Troubleshooting Guide

Problem	Possible Cause
(1). The 6-Volt battery will not recharge	<ol style="list-style-type: none"> 1. Motor connector or adapter connector is loose. Make sure the motor connector and the adapter connector is firmly plugged. 2. The 6-volt battery will not recharge. Make sure the charger is plugged into a 240 V wall outlet and the power flow to the outlet is on. 3. Charger is not plugged in. Make sure the charger is plugged into a 240V wall outlet and the power flow to the outlet is on.
(2). The vehicle does not run	<ol style="list-style-type: none"> 1. The battery may be low on power. After each use, or once a month minimum, charge the battery for a "full" 10 hours. DO NOT leave the battery on the charger for more than 20 hours.

**PLEASE NOTE: IN CASE OF PRODUCT FAULT DO NOT RETURN THIS PRODUCT TO STORE.
PLEASE CONTACT HUNTER PRODUCTS CUSTOMER SERVICE TOLL FREE NUMBER: 1800 224 094**

<p>(3). The vehicle does not run</p>	<p>2. Wheel nuts are loose. If the wheel nuts with a wrench.</p> <p>3. Motor connector or wires are loose. Make sure the motor connector is firmly plugged into the battery.</p> <p>4. Battery is dead. Have you properly maintained the battery according to the directions? Is the battery old? Your battery may need to be replaced.</p> <p>5. Electrical system is damaged. Water may have corroded the system, or loose dirt, gravel or sand might have jammed the switch. Check.</p> <p>6. Motor is damaged. Please contact Hunter products Customer Service.</p>
<p>(4). The vehicle does not run Very long.</p>	<p>1. Battery may be undercharged. You may not be charging the battery long enough. After each use, or once a month minimum, charge the battery for a "full" 10 hours. DO NOT leave the battery on the charger for more than 20 hours.</p> <p>2. Battery is old. The 6-volt battery will eventually lose the ability to hold a charge. Depending on the amount of use, and varying conditions, the battery should operate for one to three years. Replace the battery with a new 6-volt battery.</p>
<p>(5). Battery buzzes or gurgles when charging.</p>	<p>1. This is normal and not a cause for concern. It may also be silent when charging, which is also normal.</p>
<p>(6). The vehicle runs sluggishly or beeping occurs.</p>	<p>1. Battery needs recharging. After each use, or once a month minimum, charge the battery for a "full" 10 hours. Never charge the battery longer than 20 hours.</p> <p>2. Battery is old. The 6-volt battery will eventually lose the ability to hold a charge. Depending on the amount of use, and varying conditions, the battery Should operate for one to three years. Replace the battery with a new 6-volt battery.</p> <p>3. Vehicle is overloaded. Maximum weight is 30 kg. DO NOT overload the vehicle. DO NOT tow anything behind the vehicle. ONLY one rider at a time.</p>

**PLEASE NOTE: IN CASE OF PRODUCT FAULT DO NOT RETURN THIS PRODUCT TO STORE.
PLEASE CONTACT HUNTER PRODUCTS CUSTOMER SERVICE TOLL FREE NUMBER: 1800 224 094**

11. Maintaining Your Vehicle

- It is the parents responsibility to check main parts of the toy before using. Must regularly examine for potential hazards such as the battery, charger, cable or cord of charger, screws are fastened. The toy must not be used until that damage has been properly removed or fixed.
- Occasionally use a lightweight oil to lubricate moving parts such as wheels and the steering linkages.
- Do not over turn or incline the vehicle. The vehicle should be stored indoors or if left in outdoor conditions it should be covered by a tarp to protect it from the outside weather elements. It is recommended if possible to keep indoors to reduce colour fading of the vehicle or any damages to the electric component.
- This toy should be kept away from fire. Keep the vehicle away from sources of heat, such as stoves and heaters. Plastic parts may melt. While charging, do not leave near open flames.
- ADULTS ONLY: recharge the battery after each use. Recharge the battery at least once a month when the vehicle is not being used.
- The vehicle can be wiped down with a soft, dry cloth.
- DO NOT use chemical liquid to clean the plastic surface of the toy.
- DO NOT wash the vehicle with soap and water.
- DO NOT drive the vehicle in rainy or snowy weather. Water will damage the motor, electric system and battery.
- When not using, all the electrical source should be cut off. Turn power switch to off position.
- Please do not change the structure of this product and circuit system by yourself. It must go on under the guidance of technical staff or by professional personnel to maintain. Please contact Hunter products Customer service.
- Do not use the toy for other purpose except riding.

**PLEASE NOTE: IN CASE OF PRODUCT FAULT DO NOT RETURN THIS PRODUCT TO STORE.
PLEASE CONTACT HUNTER PRODUCTS CUSTOMER SERVICE TOLL FREE NUMBER: 1800 224 094**

Our goods come with guarantees that cannot be excluded under the Australian Consumer Law. You are entitled to a replacement or refund for a major failure and for compensation for any other reasonably foreseeable loss or damage. You are also entitled to have the goods repaired or replaced if the goods fail to be of acceptable quality and the failure does not amount to a major failure.

Where a failure does not amount to a major failure, we are entitled to choose between providing you with a repair, replacement or refund. To obtain compensation, you would need to provide documentary evidence of the loss or damage suffered, and documentary evidence that such loss or damage was a reasonably foreseeable consequence of a failure by us to comply with a consumer guarantee under the Australian Consumer Law. Such evidence may include photographs, statutory declarations, receipts or reports (e.g. from your doctor), depending on the loss or damage.

In addition to all rights and remedies to which you may be entitled under the Competition and Consumer Act 2010 (Commonwealth) and any other relevant legislation, the manufacturer warrants this product to be free from defects in materials or workmanship for a period as stated on the packaging from the date of purchase.

In order to claim under this warranty, you will need to bring the product to the store of purchase, along with proof of purchase (typically this will be a receipt). Any cost incurred by you in bringing the product to the service desk will be borne by you. We will then, at our option, either repair or replace the product, or refund your money and take back the product.

Our liability under this manufacturer's warranty is subject to us being satisfied that a defect was caused by defective workmanship or materials, and was not caused by or substantially contributed to by other factors, or circumstances beyond our control, including (but not limited to) defective installation, maintenance or repair, alteration or modification of the product in any manner not recommended by the manufacturer or any neglect, misuse or excessive use.

The benefits conferred by this manufacturer's warranty are in addition to all rights and remedies conveyed by the Competition and Consumer Act 2010 (Commonwealth), and any other statutory rights to which you may already be entitled, and this warranty does not exclude, restrict or modify any such rights or remedies that are implied by law.

HUNTER PRODUCTS

Level 2, 424 Warrigal Road Moorabbin 3189

Ph: 1800 224 094

Email: enquiries@hunterproducts.com.au

**PLEASE NOTE: IN CASE OF PRODUCT FAULT DO NOT RETURN THIS PRODUCT TO STORE.
PLEASE CONTACT HUNTER PRODUCTS CUSTOMER SERVICE TOLL FREE NUMBER: 1800 224 094**

12. Disposal Of Battery

Disposal of Battery



- Your sealed lead-acid battery must be recycled or disposed of in an environmentally sound manner.
- Do not dispose of your lead-acid battery in a fire. The battery may explode or leak.

PLEASE NOTE:
IN CASE OF PRODUCT FAULT
DO NOT RETURN THIS PRODUCT
TO STORE. PLEASE CONTACT
Hunter Products Customer Service
TOLL FREE NUMBER:
1800 224 094

FOR CUSTOMER SERVICE OR PRODUCT ENQUIRIES
PLEASE CONTACT **Hunter Products Customer Service**
TOLL FREE NUMBER: 1800 224 094
MADE IN CHINA

040114

PLEASE NOTE: IN CASE OF PRODUCT FAULT DO NOT RETURN THIS PRODUCT TO STORE.
PLEASE CONTACT **HUNTER PRODUCTS CUSTOMER SERVICE TOLL FREE NUMBER: 1800 224 094**