



LIGHTNING MCQUEEN 6V OWNER'S MANUAL

Age: 18-36 months

Maximum weight: 20KG

Speed: 0-3 Km/h

Battery: 6 volt

⚠ WARNING!

This manual contains important safety and use information. Keep this manual for future reference.

- An adult must read this entire manual
- Adult supervision is required at all times
- The vehicle must be assembled by an adult who has read and understood the instructions in this manual.
- Rechargeable batteries are only to be charged under adult supervision.

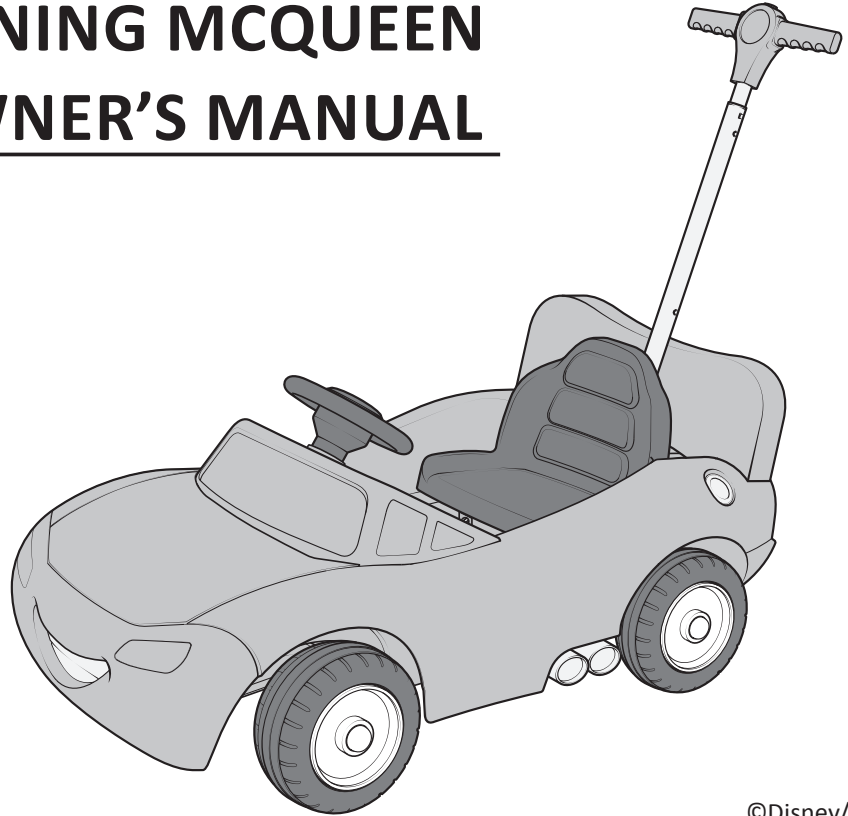

©Disney/Pixar

**FOR ANY PRODUCT ENQUIRIES OR ISSUES PLEASE CONTACT HUNTER PRODUCTS AT WWW.ELECTRICRIDEON.COM.AU
OR TOLL FREE HELP LINE 1800 224 094.**

Table Of Contents

1. About Your New Ride On
2. Safety
3. Parts
4. Assembly
5. Use

6. Maintenance
7. Troubleshooting Guide
8. Maintaining Your Vehicle
9. Service
10. Disposal Of Battery

① About Your New Ride On

Thank you for your purchasing our products, we want your child to enjoy this product for years to come. Keep these points in mind as you read this guide:

Suitable age:	18-36 mth	Battery:	6V 4.5Ah * 1
Load Capacity:	20Kg	Size of car:	90*51.5*42 cm
Speed:	0-3 Km/h	Carton size:	92*51*27 cm
Charger:	Input: AC 240V 50HZ	Charging time:	8-12h, no more than 16 hours
	Output: 8V 500mA	Fuse:	Self-resetting
Optimum Temperature:	Below 40°C		

2 Safety

WARNING!

FAILURE TO FOLLOW THE SAFETY INSTRUCTIONS LISTED BELOW MAY RESULT IN SERIOUS INJURY OR DEATH. The owner's manual contains assembly, use and maintenance instructions.

PARENTAL AND ADULT RESPONSIBILITY AND SUPERVISIONS NECESSARY. Parents and/or adults supervising children must read and understand this entire manual before allowing any child to use this product. Failure to do so could result in serious injury.

Assembly Warnings

- The vehicle must be assembled by an adult who has read and understood the instructions in this manual.
- Choking hazard to children under the age of 3 years This product contains small parts that are for adult assembly only. Keep small children away when assembling.
- Remove and dispose of all protective material and poly bags and all packaging material before assembly.

Child Safety Warnings

- Parents and/or responsible adults are best to evaluate their own children's ability to safely use this vehicle.
- Never leave child unattended. Continuous adult supervision required.

- Body parts such as hands, legs, hair and clothing can get caught in moving parts. Never place a body part near a moving part or wear loose clothing while using the vehicle.
- Always wear shoes when using the vehicle.
- Not to be used by children under 18 months of age or over 36 months of age.

Safe Riding Warnings

Before using the vehicle the child should understand the controls and safety issues. They must also demonstrate the capability to handle the vehicle and operate its controls. It is the responsibility of the adult to educate the child and supervise the vehicle use. Read the following safety warnings to any child using the vehicle before riding.

- Always use common sense and safe practices when using the vehicle.
- Always use the vehicle in a safe, secure environment with continuous adult supervision.
- Always sit in the seat when using the vehicle.
- Only one rider is allowed to ride at a time.

3 Parts

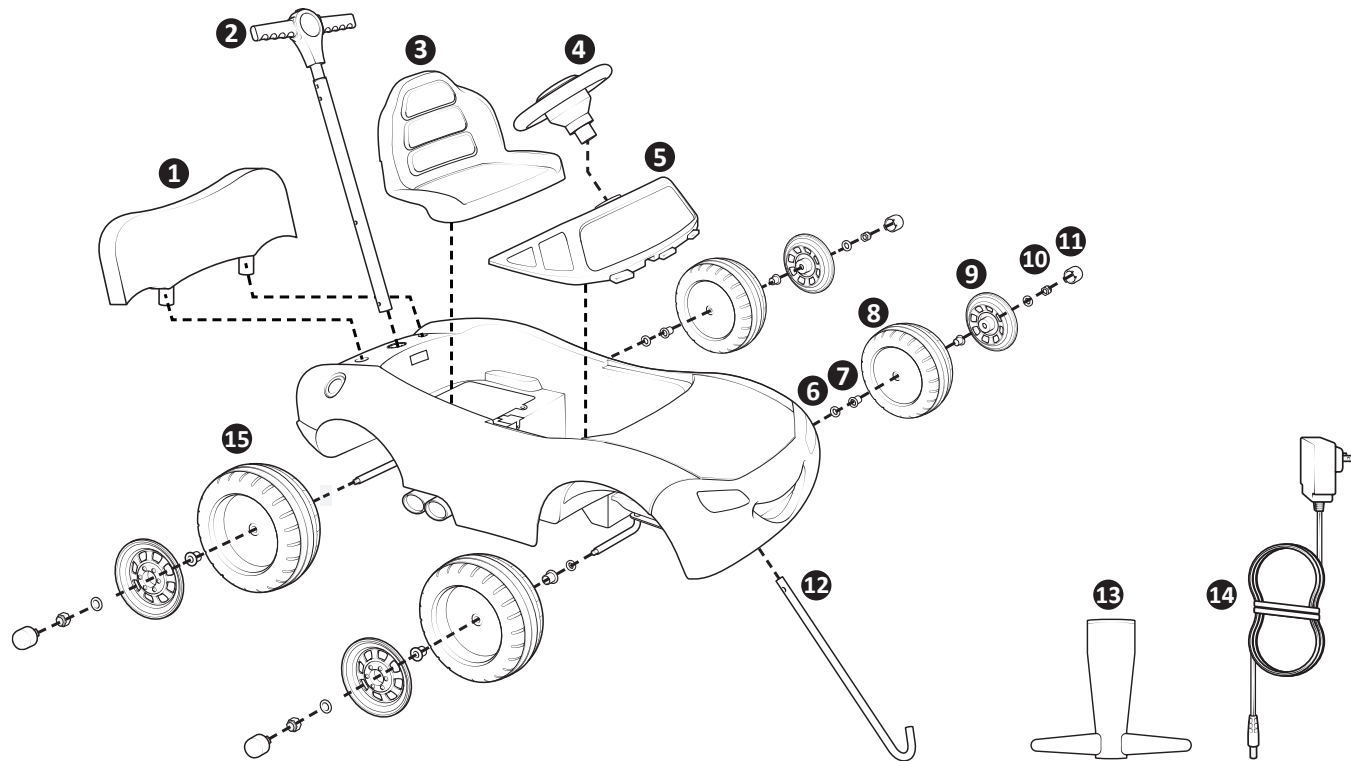

Parts List

#	Part name	Quantity
1	Spoiler	1
2	Assist bar	1
3	Seat	1
4	Steering Wheel	1
5	Dashboard	1
6	Wheel washer	7
7	Wheel Insert	7
8	Wheel	3
9	Hubcap	4
10	Wheel nut	4
11	Wheel snap cap	4
12	Steering rod	1
13	Wrench	2
14	Charger	1
15	Drive Wheel	1

Before beginning assembly, check to ensure that the parts are present. **Some hardware is already fitted to the vehicle.**

Hardware (actual size)

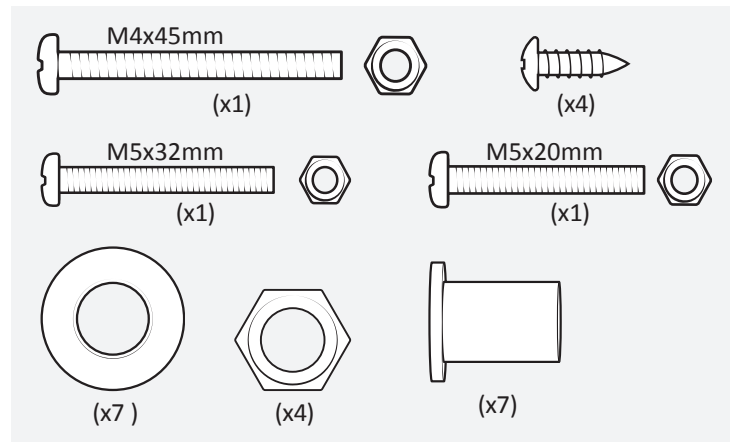

Tools Required

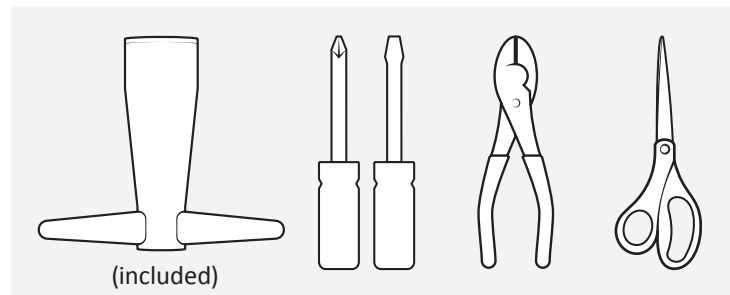

4 Assembly

Attach the Dashboard

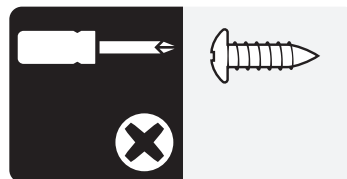
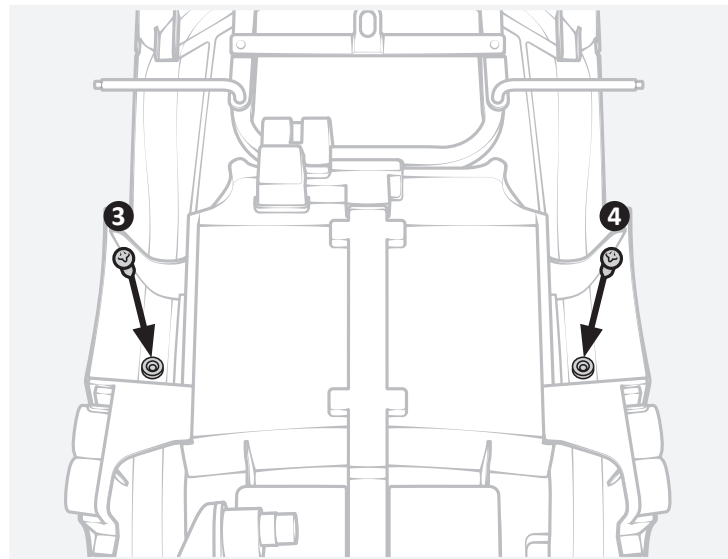
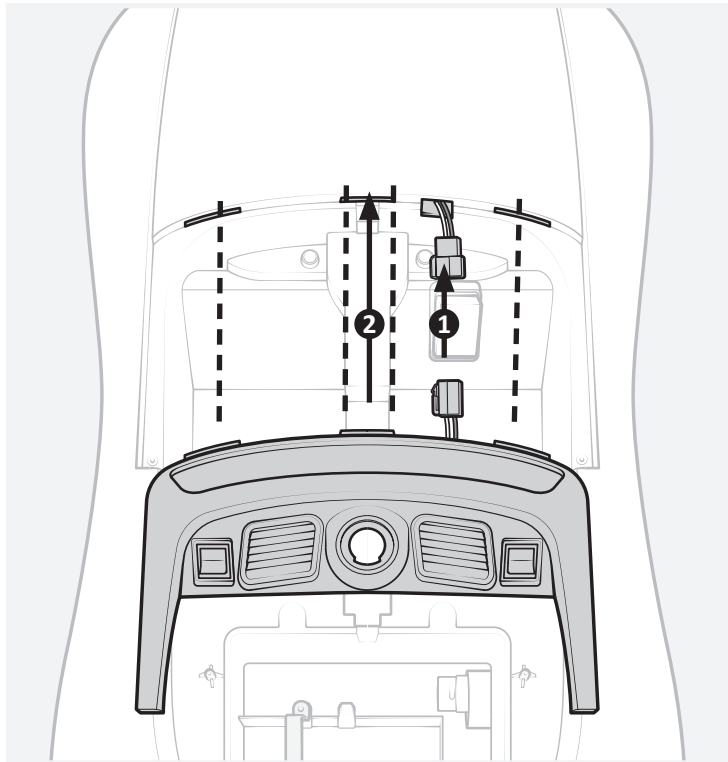

TIP!

Carefully turn the body over onto a soft surface such as cardboard so you don't scratch the surface.

Attach the Steering Wheel

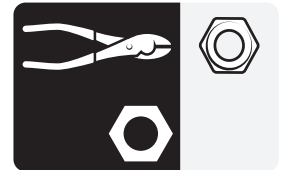
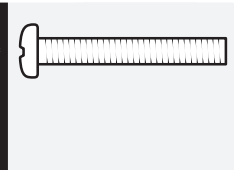
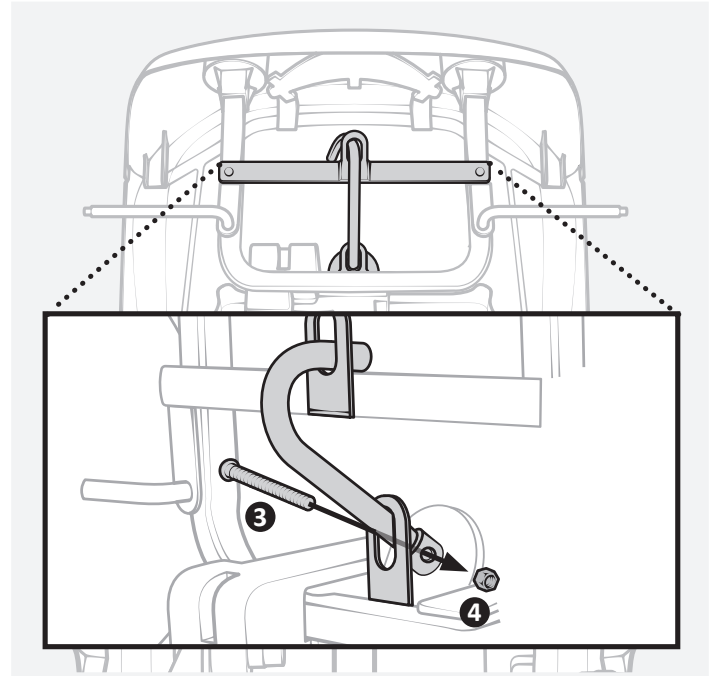
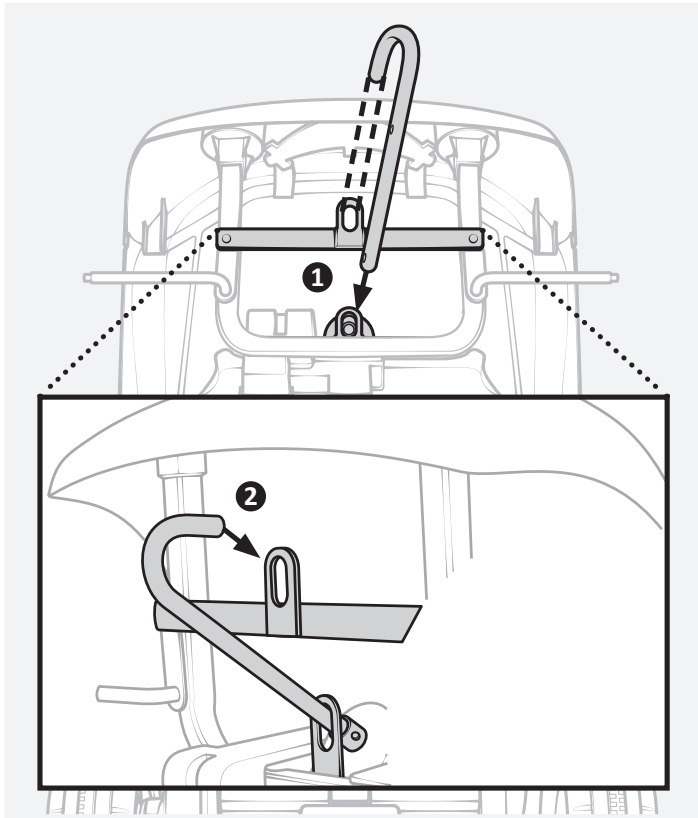

⚠ WARNING!

- Do not mix old and new batteries
- Do not mix alkaline, standard (carbon-zinc), or rechargeable (nickel-cadmium) batteries.



📖 Note

You will need to remove the steering wheel bolt and the nut from the steering wheel before placing the steering wheel onto the steering rod.

💡 TIP!

You may need to push up on the steering rod from underneath the car to align the holes to fit the steering wheel bolt.

Battery Connection

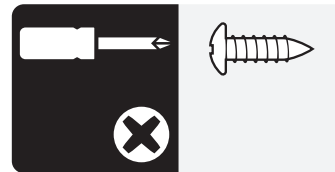
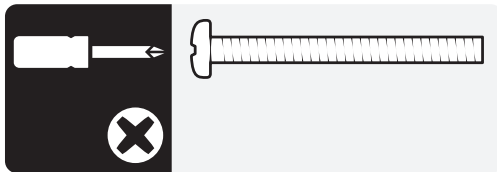
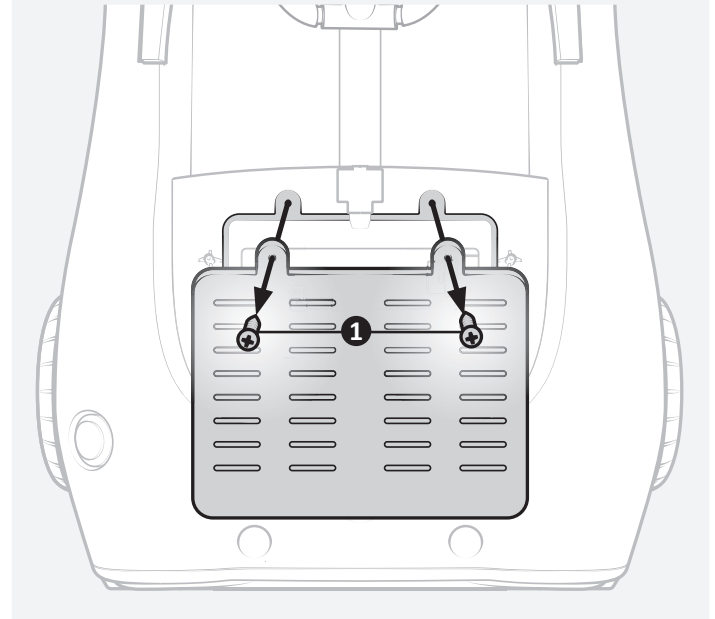
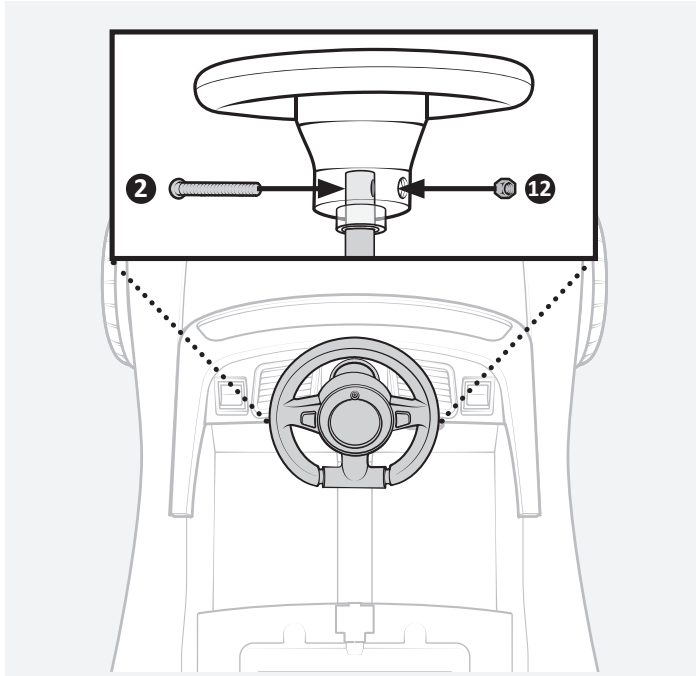

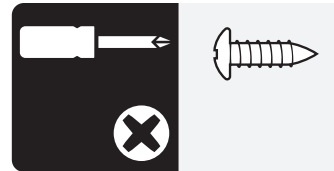
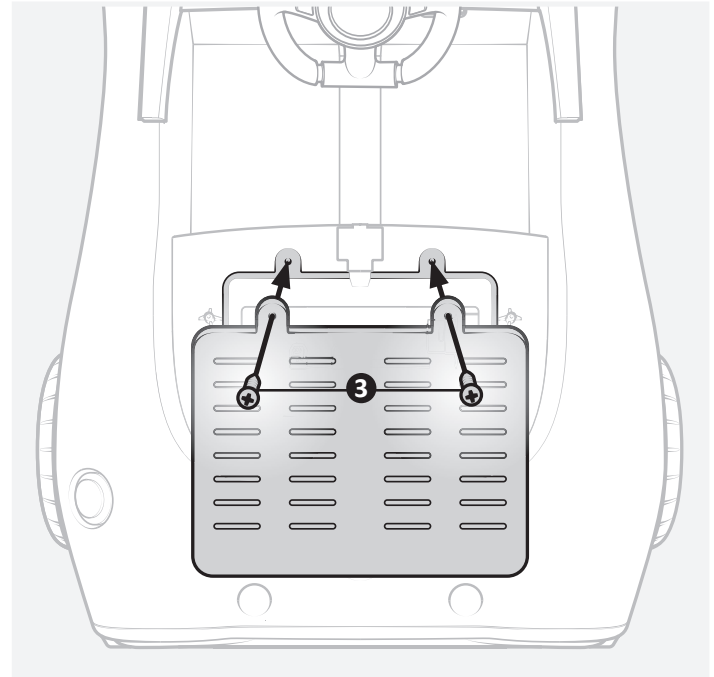
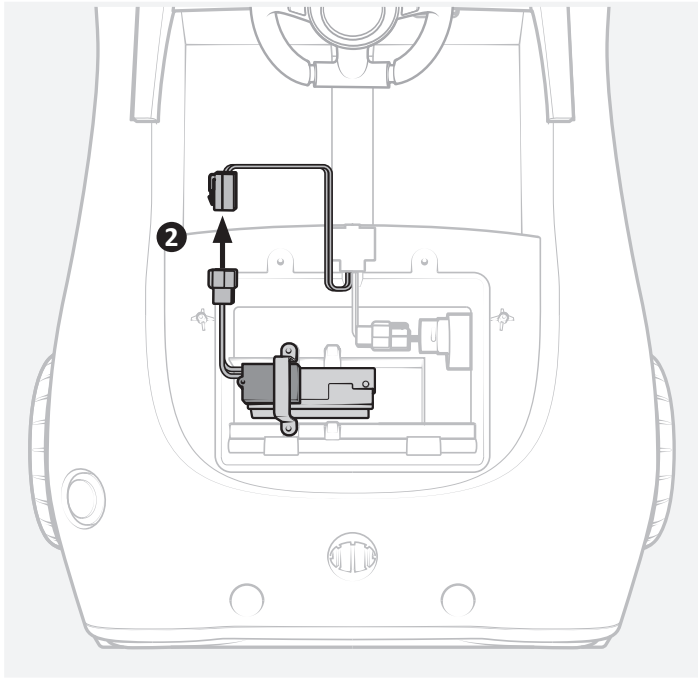

Wheel Assembly

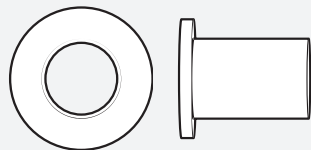
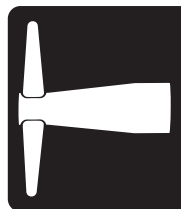
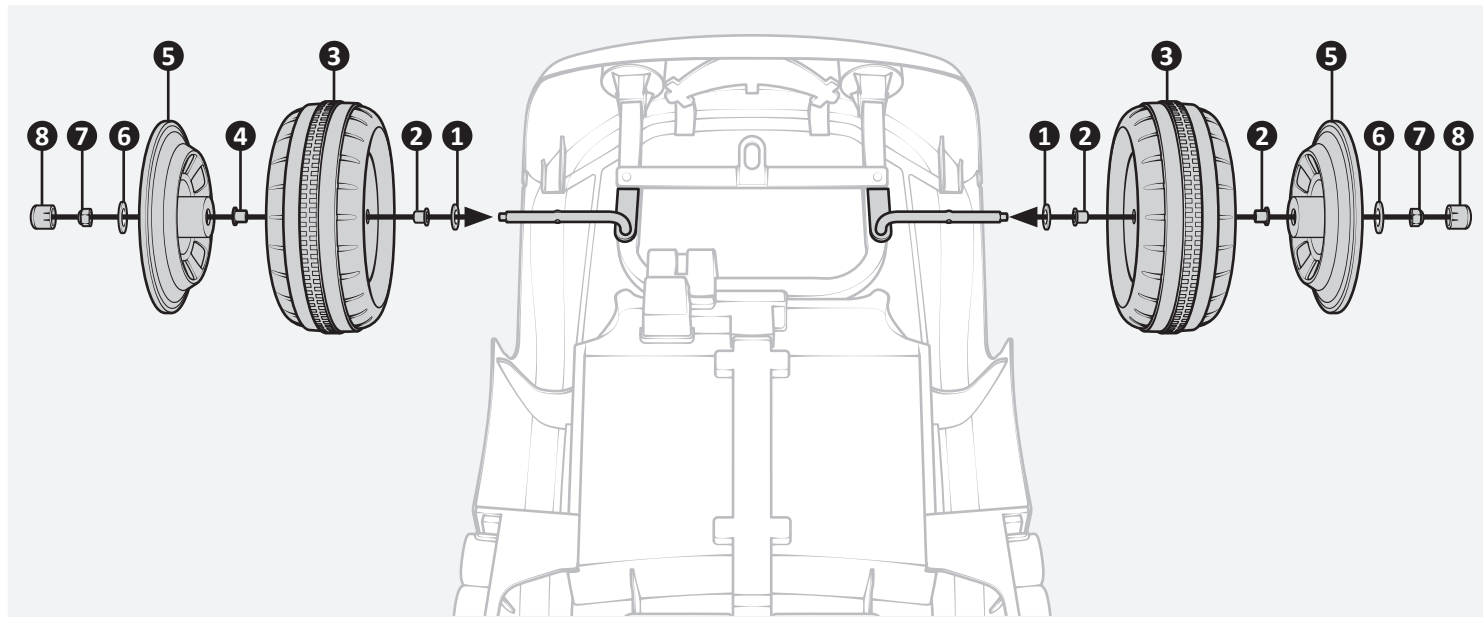

Note

Place the insert (step 2, step 4, step 10 and step 12) into the wheel before sliding the wheel onto the axle.

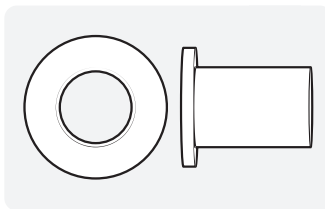
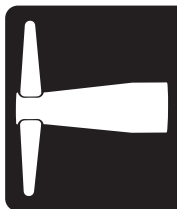
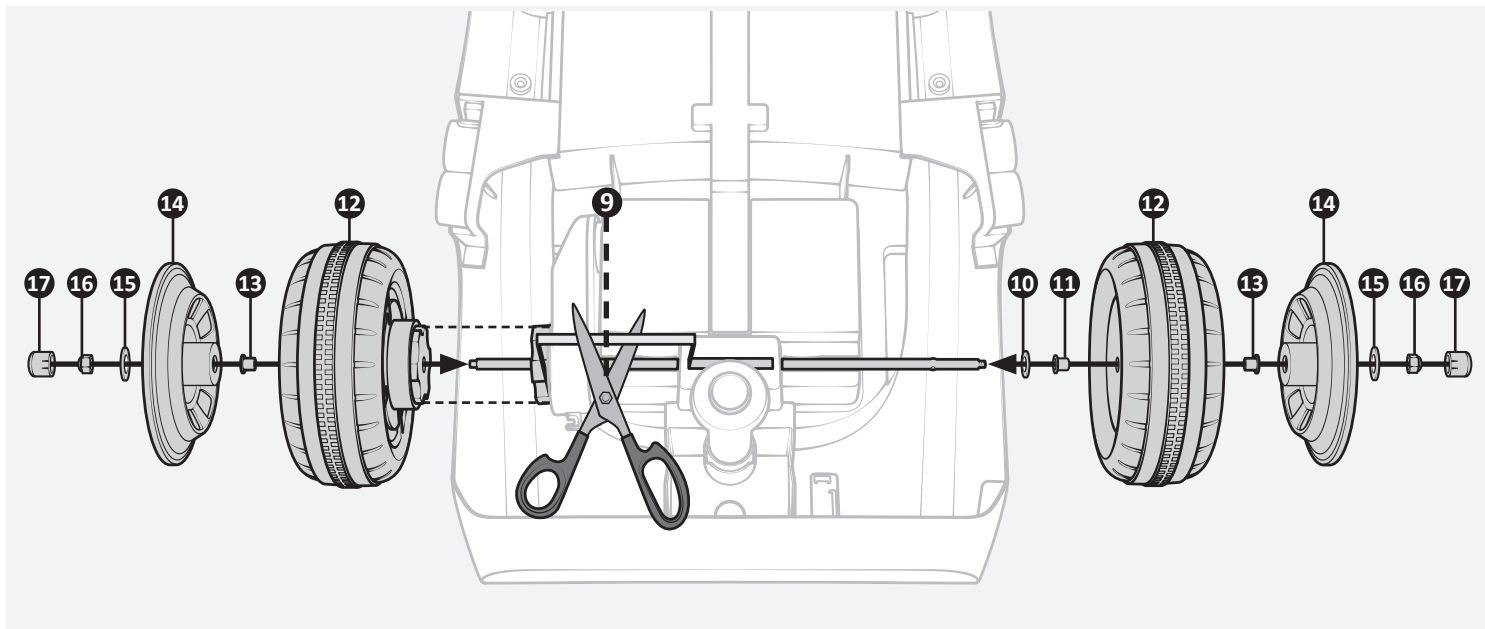

TIP!

When you tighten the nuts (step 16), if you attempt to tighten one nut at a time the axle will spin preventing the nut from properly tightening. Instead tighten both nuts simultaneously to ensure that all hardware is locked into place.

Seat Assembly

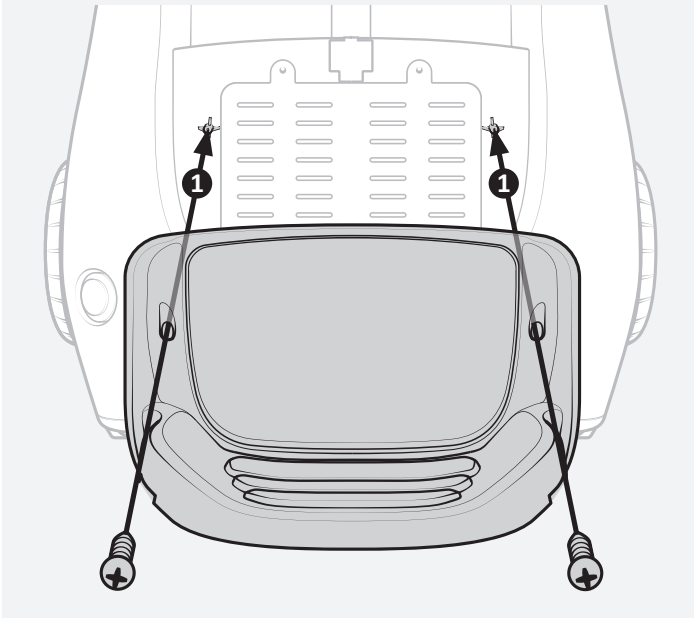

Spoiler Assembly

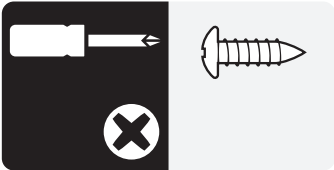
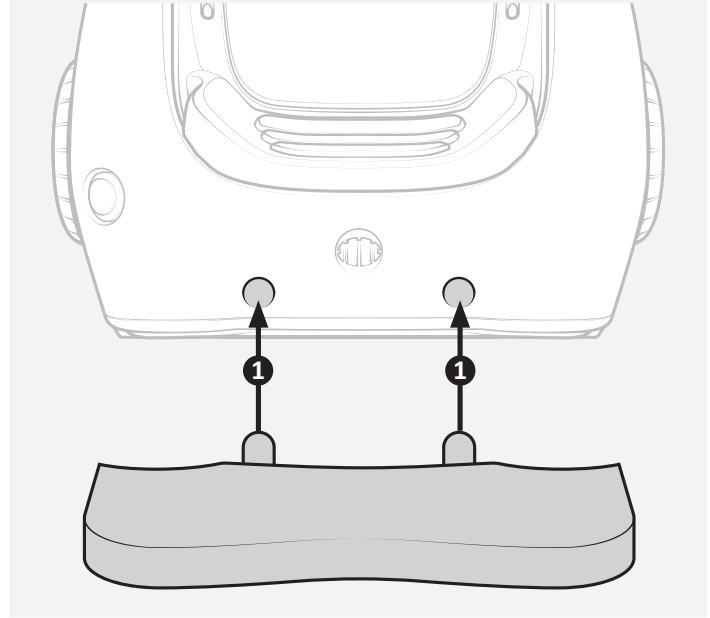

WARNING!

Battery Warnings

The following safety hazards may result in serious injury or death to the user of the vehicle:

- Battery posts, terminals and related accessories contain lead and lead compounds (acids) chemicals known to cause cancer, reproductive harm, and are toxic and corrosive. Never open the battery.
- Use of a battery or charger other than the supplied 6V rechargeable battery and charger may cause a fire or explosion. Only use the supplied 6V rechargeable battery and charger with the vehicle.
- Using the 6V rechargeable battery and charger for any other product may result in overheating, fire or explosion. Never use the 6V rechargeable battery and charger with another product.
- Explosive gases are created during charging. Charge the battery in a well ventilated area. Do not charge the battery near heat or flammable materials.
- Contact between the positive and negative terminals may result in fire or explosion. Avoid direct contact between the terminals. Picking up the battery by the wires or charger can cause damage to the battery and may result in a fire. Always pick up the battery by it's case or handles.
- Plug wall charger directly into a wall outlet. Do not use an extension cord with charging
- Liquids on the battery may cause fire or electric shock. Always keep all liquids away from the battery and keep the battery dry.
- Contact or exposure to battery leakage (lead acid) may cause serious injury. If contact or exposure occurs immediately call your physician. If the chemical is on the skin or in the eyes, flush with cool water for 15 minutes. If the chemical was swallowed, immediately give the person water or milk. Do not give water or milk if the patient is vomiting or has a decreased level of alertness. Do not induce vomiting.
- Tampering or modifying the electric circuit system may cause a shock, fire or explosion and permanently damage the system. Exposed wiring, circuitry in the charger may cause electric shock. Always keep the charger housing closed.

Charging the Battery

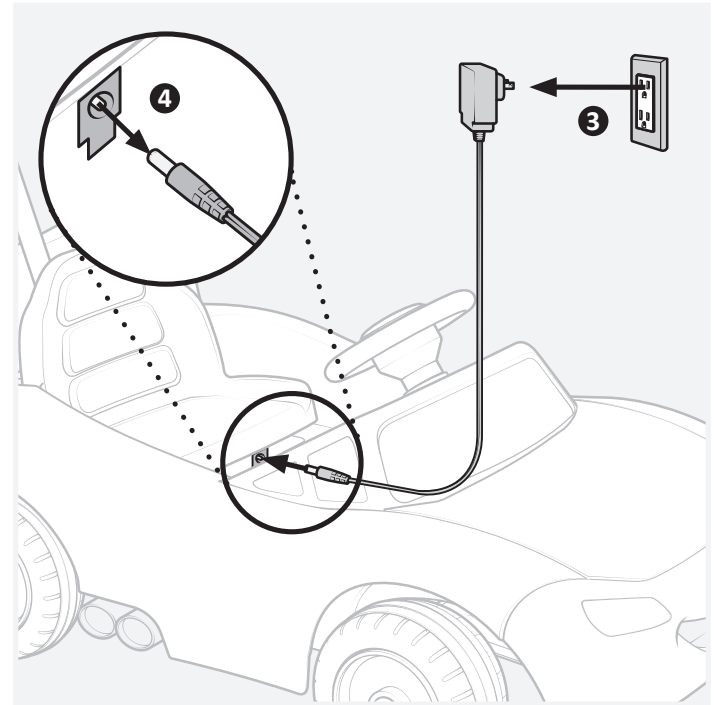
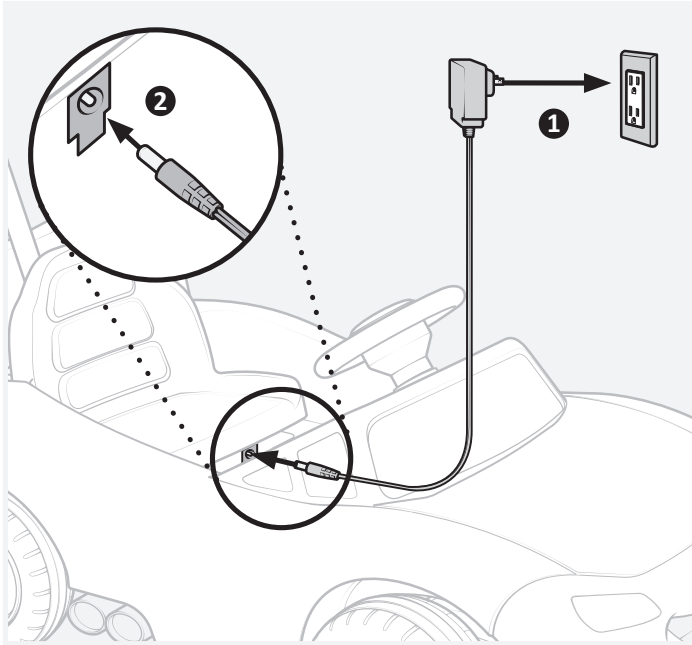

Charge the battery
for 12 hours
before first use



Do not charge the
battery for more
than 16 hours



TIP!

The product will not turn on while plugged into the charger.
Remove from charger prior to turning on.

Attach the Assistance bar (optional)

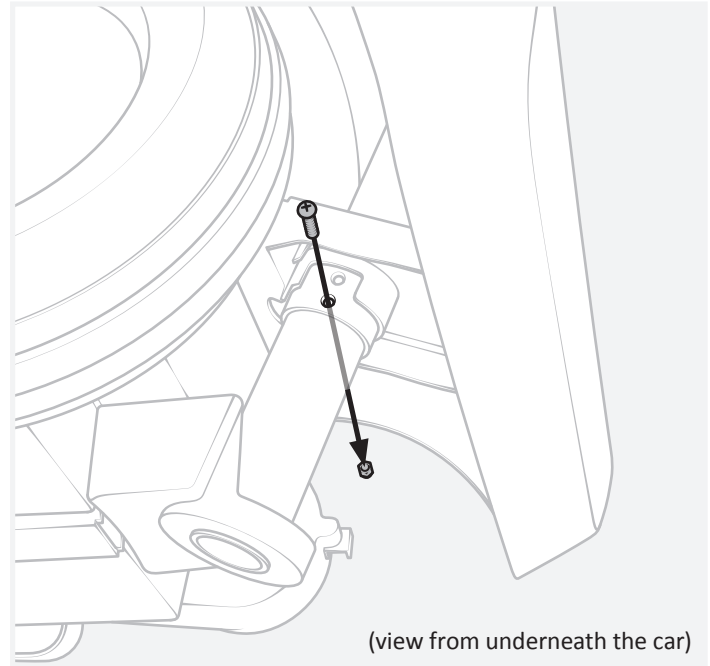
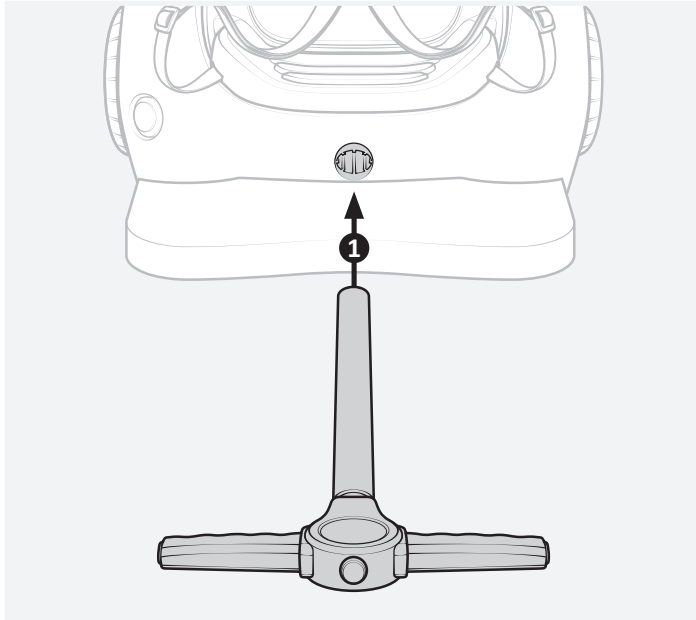



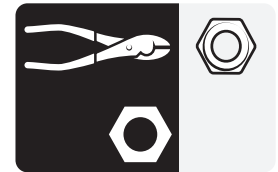
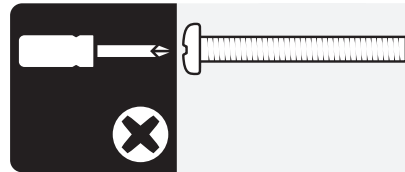

Note

Optional parent assist bar can be used to aid the rider in steering.



5 Use

Controls & Functions

-  On/Off button
-  Forward/Reverse switch
-  Press accelerator with foot to drive.
-  Lift foot off pedal accelerator to stop
-  Assistance bar

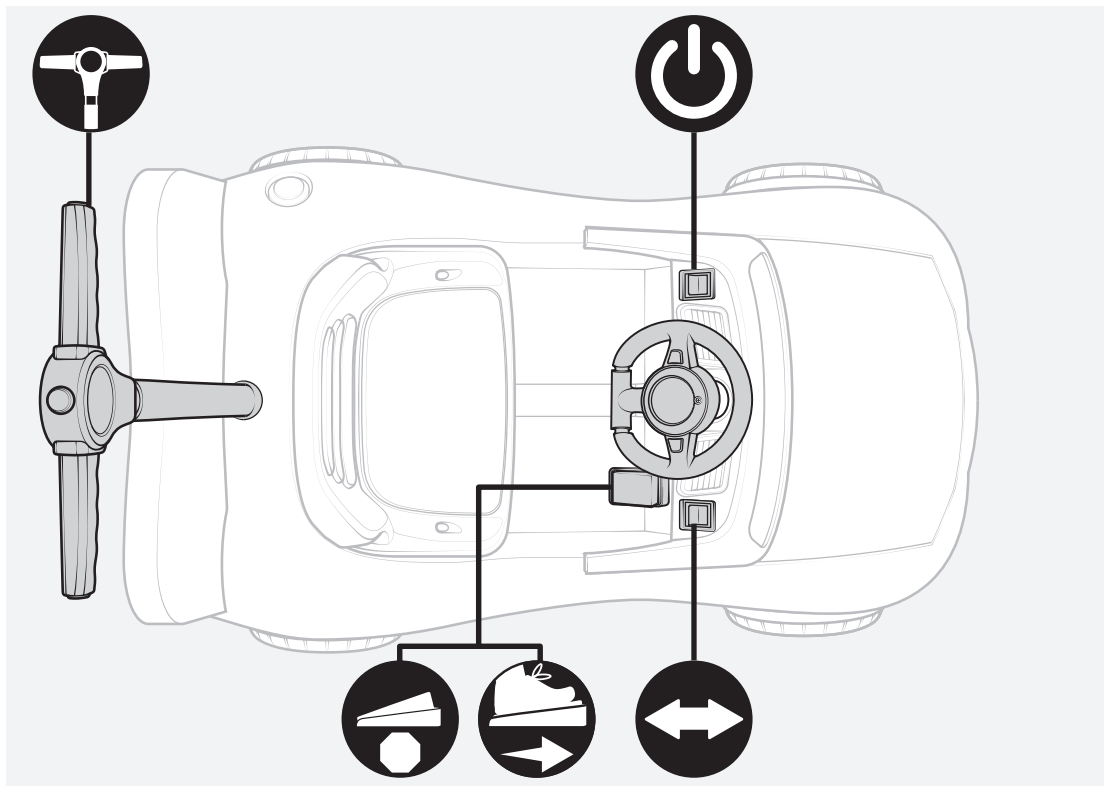

Note

Maximum Speed: 2 KM/H

Using the Assistance Bar

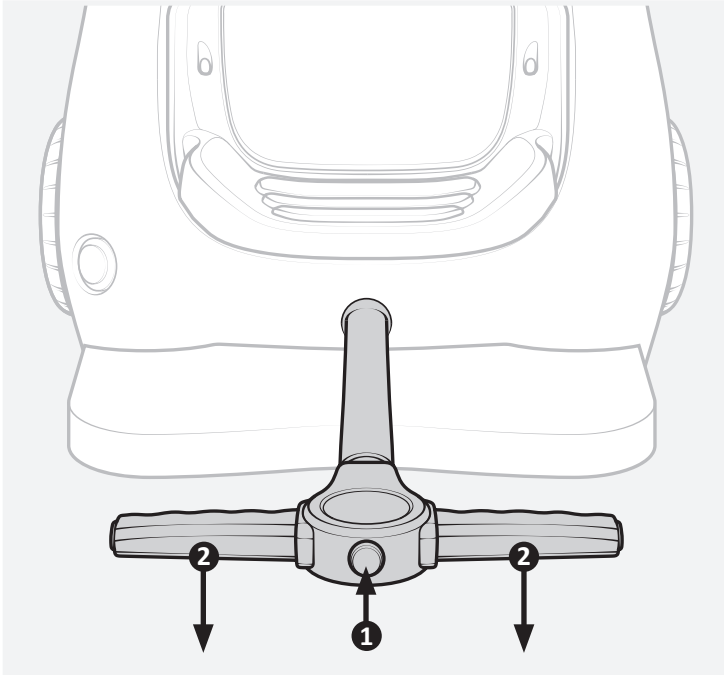

Note

By pressing the button on the parent assist handle and pulling up, you can extend the height of the handle.

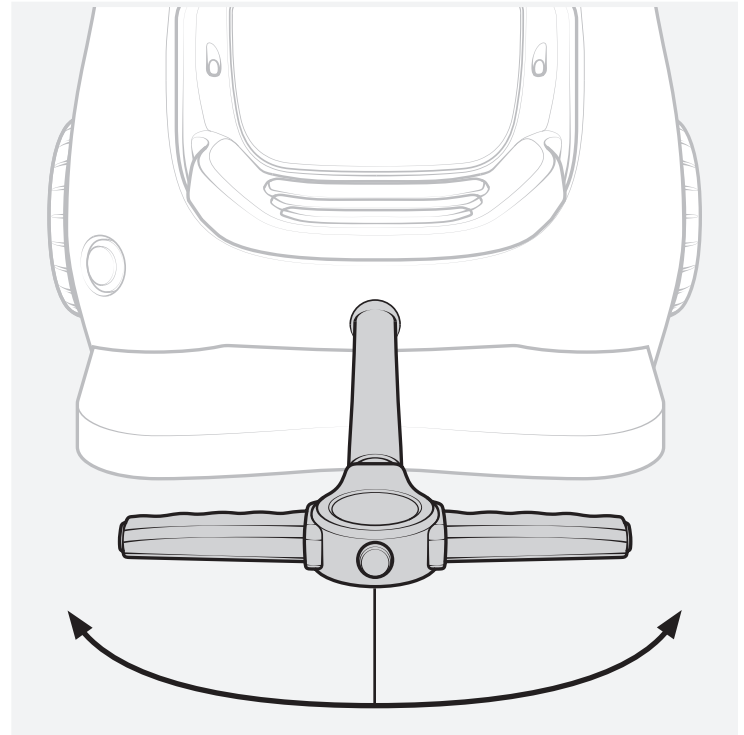

Note

Assist bar can be used to aid the rider in steering

Change to Push / Electric Mode

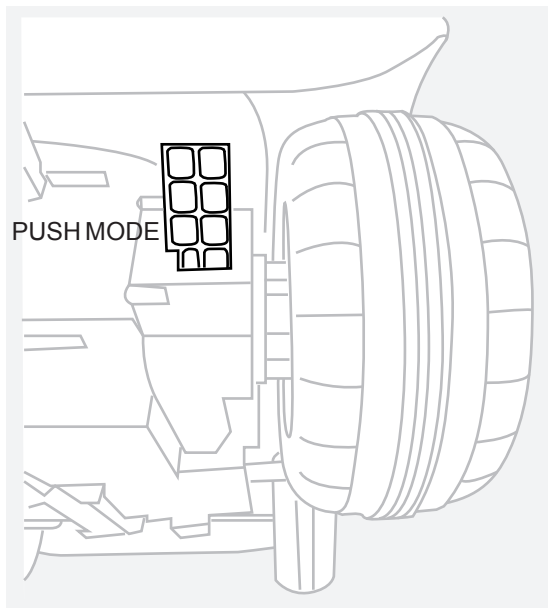

Note

By pushing the switch up, this car changes to Push Mode, in this mode, car cannot run if your children hit the pedal switch. Please make sure the "ON-OFF" button is "OFF"

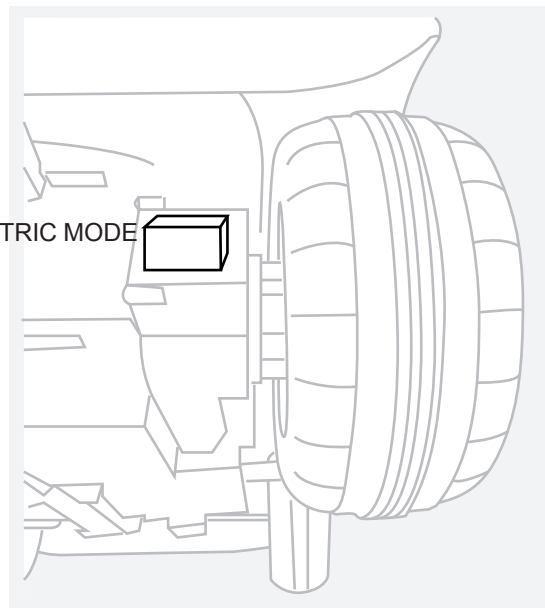

Note

By pushing the switch down, this changes the car into electric drive mode. The foot pedal and forward/reverse switch is now active. Please make sure the "ON-OFF" button is "ON"

6 Maintenance

Battery Replacement and Disposal

The battery will eventually lose the ability to hold a charge. Depending on the amount of use, and varying conditions, the battery should operate for one to three years. Follow these steps to replace and dispose the battery.

Important! Recycle the dead battery responsibly. The battery contains lead acid (electrolyte) and must be disposed of properly and legally. It is illegal in most areas to incinerate lead acid batteries or dispose of them in landfills. Take it to a federal or state-approved lead acid battery recycler, such as an authorized service center or your local automotive battery retailer. Do not throw the battery away with your regular household trash!

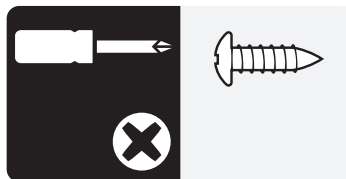
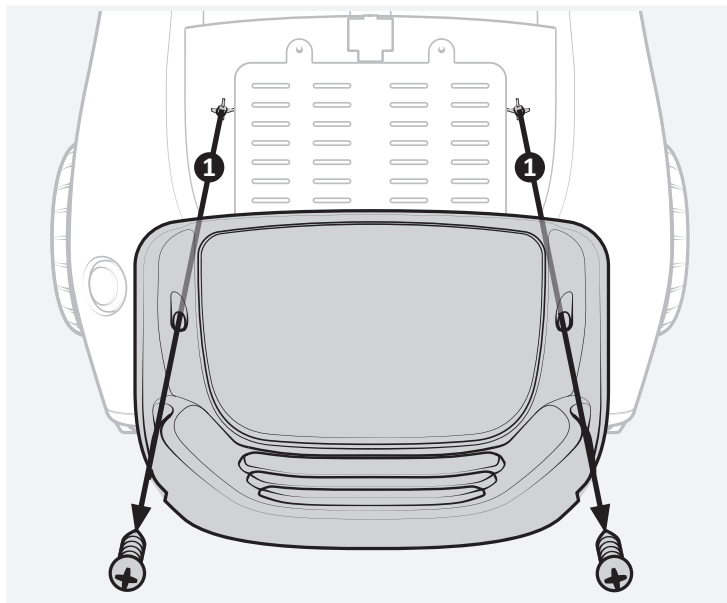

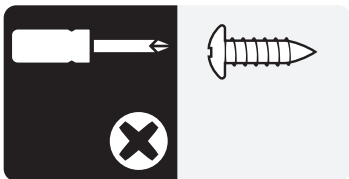
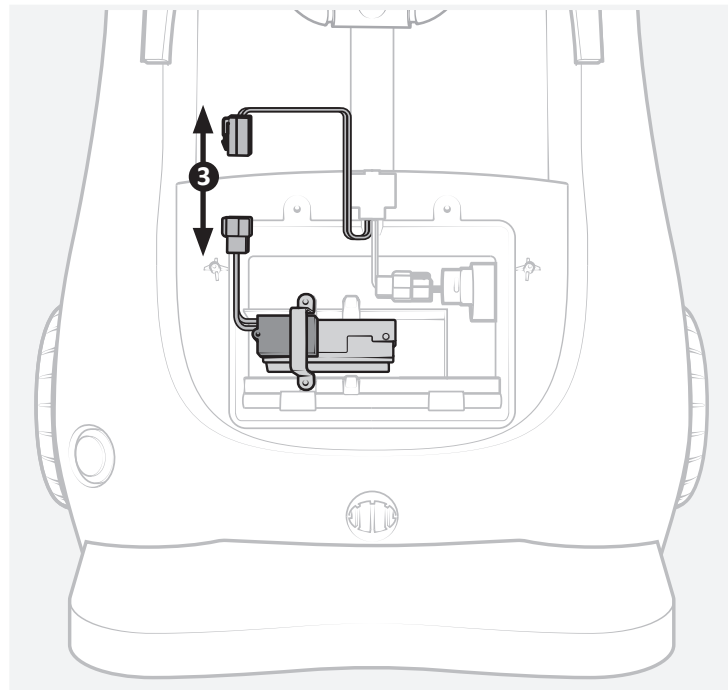
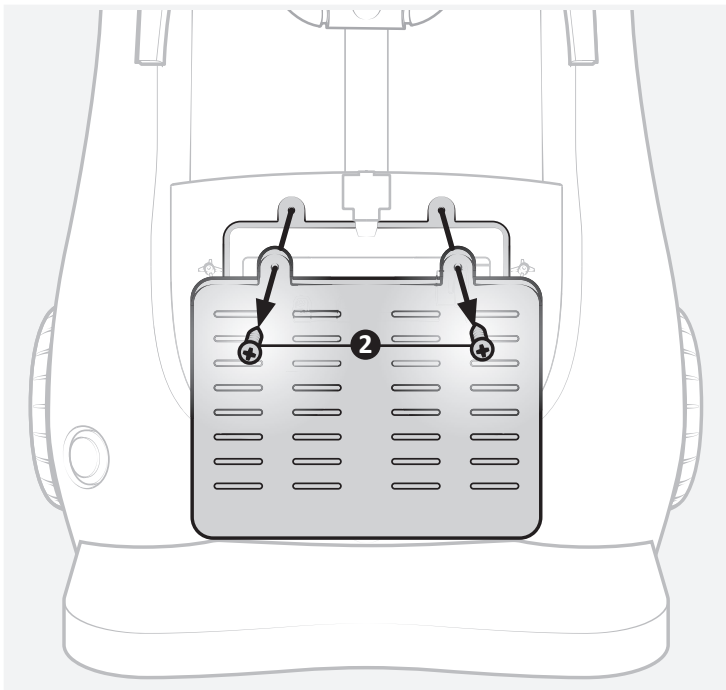

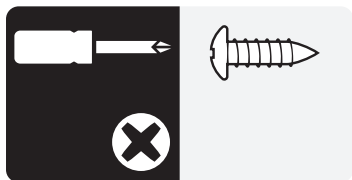
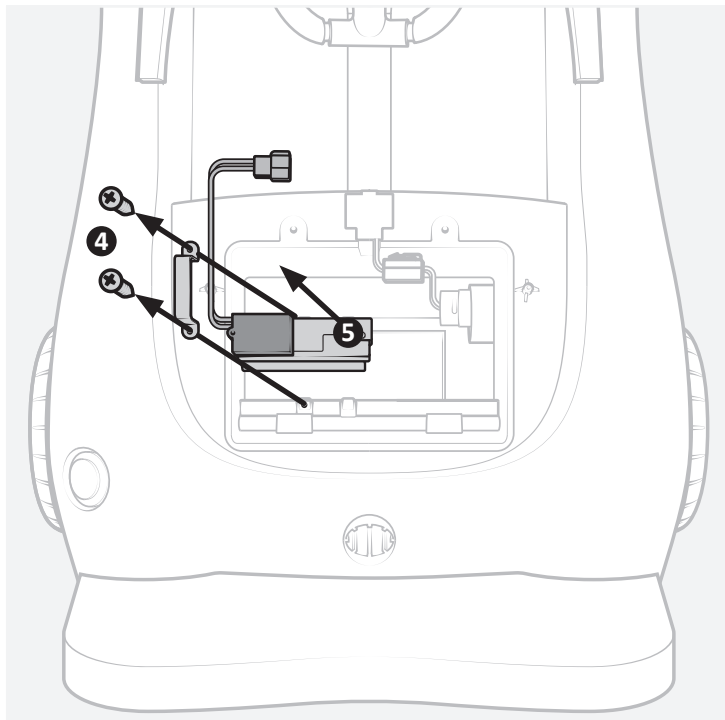

The vehicle should be checked for damage, missing or badly worn parts before each use.

- Check the tightness of the fasteners before each use.
- Check the tightness of the wheels before each use.
- Ensure the battery is securely in place before each use.
- Clean the vehicle with a soft, dry cloth. To restore shine to plastic parts, use a non-wax furniture polish. Do not use car wax, abrasive cleaners or wash the vehicle with soap and water. Water will damage the motor, electrical system and battery.

Note

- Store the vehicle indoors or cover it with a tarp to protect it from the wet weather. Keep it away from sources of heat, such as stoves and heaters.
- Do not leave the vehicle in the sun for long periods of time or fading may occur. Store in shade or cover with tarp.
- Do not wash the vehicle with a hose.
- Do not wash the vehicle with soap and water.

7 Troubleshooting Guide

■ **PROBLEM: The vehicle does not run very long.**

POSSIBLE CAUSE: Battery may be undercharged.

You may not be charging the battery long enough. After each use, or once a month minimum, charge the battery for 8 to 12 hours. Do not leave the battery on the charger for more than 16 hours.

POSSIBLE CAUSE: Battery is old.

The battery will eventually lose the ability to hold a charge. Depending on the amount of use, and varying conditions, the battery should operate for one to three years. Replace the battery with a new One.

■ **PROBLEM: Battery buzzes or gurgles when charging.**

This is normal and not a cause for concern. It may also be silent when charging, which is also normal.

■ **PROBLEM: Charger feels warm when recharging battery.**

This is normal and not a cause for concern.

⑧ Maintaining Your Vehicle

- It is parents' responsibility to check main parts of the toy before using, Must regularly examine for potential hazard, such as the battery, charge, cable or cord, plug, screws are fastening enclosure of other parts and that in the event of such damage, the toy must not be until that damage had been properly removed.
- Make sure the plastic parts of the vehicle are not cracked or broken.
- Occasionally use a lightweight oil to lubricate moving parts such as wheels.
- Park the vehicle indoors or cover it with a tarp to protect it from wet weather.
- Keep the vehicle away from sources of heat, such as stoves and heaters. Plastic parts may melt.
- Recharge the battery after each use. Only an adult can handle the battery. Recharge the battery at least once a month when the vehicle is not being used.
- Do not wash the vehicle with a hose. Do not wash the vehicle with soap and water. Do not drive the vehicle in rainy or snowy weather. Water will damage the motor, electric system and battery.
- Clean the vehicle with a soft, dry cloth. To restore shine to plastic parts, use a non-wax furniture polish. Do not use car wax. Do not use abrasive cleaners.
- Do not drive the vehicle in loose dirt, sand or fine gravel which could damage moving parts, motors or the electric system.
- When not using, all the electrical source should be turn off. Turn off the power switch and disconnect the battery connection.

9 Service

Our goods come with guarantees that cannot be excluded under the Australian Consumer Law. You are entitled to a replacement or refund for a major failure and for compensation for any other reasonably foreseeable loss or damage. You are also entitled to have the goods repaired or replaced if the goods fail to be of acceptable quality and the failure does not amount to a major failure.

Where a failure does not amount to a major failure, we are entitled to choose between providing you with a repair, replacement or refund. To obtain compensation, you would need to provide documentary evidence of the loss or damage suffered, and documentary evidence that such loss or damage was a reasonably foreseeable consequence of a failure by us to comply with a consumer guarantee under the Australian Consumer Law. Such evidence may include photographs, statutory declarations, receipts or reports (e.g. from your doctor), depending on the loss or damage.

In addition to all rights and remedies to which you may be entitled under the Competition and Consumer Act 2010 (Commonwealth) and any other relevant legislation, the manufacturer warrants this product to be free from defects in materials or workmanship for a period as stated on the packaging from the date of purchase.

In order to claim under this warranty, you will need to bring the product to the store of purchase, along with proof of purchase (typically this will be a receipt). Any cost incurred by you in bringing the product to the service desk will be borne by you. We will then, at our option, either repair or replace the product, or refund your money and take back the product.

Our liability under this manufacturer's warranty is subject to us being satisfied that a defect was caused by defective workmanship or materials, and was not caused by or substantially contributed to by other factors, or circumstances beyond our control, including (but not limited to) defective installation, maintenance or repair, alteration or modification of the product in any manner not recommended by the manufacturer or any neglect, misuse or excessive use.

The benefits conferred by this manufacturer's warranty are in addition to all rights and remedies conveyed by the Competition and Consumer Act 2010 (Commonwealth), and any other statutory rights to which you may already be entitled, and this warranty does not exclude, restrict or modify any such rights or remedies that are implied by law.

HUNTER PRODUCTS

Level 2, 424 Warrigal Road Moorabbin 3189

Ph: 1800 224 094

Email: enquiries@hunterproducts.com.au

10 Disposal Of Battery

Disposal Of Battery



- Your sealed lead-acid battery must be recycled or disposed of in an environmentally sound manner.
- Do not dispose of your lead-acid battery in a fire. The battery may explode or leak.
- Do not dispose of a lead-acid battery in your regular, household trash. The incineration, land filling or mixing of sealed lead-acid batteries with household trash is prohibited by law.
- Return an exhausted battery to your local approved lead-acid battery recycle, such as a local seller of automotive batteries.
- Contact your local waste management officials for other information regarding the environmentally sound recycling and disposal of lead-acid batteries.

PLEASE NOTE:

IN CASE OF PRODUCT FAULT

PLEASE CONTACT

Hunter Products Customer Service

TOLL FREE NUMBER:

1800 224 094

OR VISIT WWW.ELECTRICRIDEON.COM.AU

FOR CUSTOMER SERVICE OR PRODUCT ENQUIRIES

PLEASE CONTACT Hunter Products Customer Service

TOLL FREE NUMBER: 1800 224 094

OR VISIT WWW.ELECTRICRIDEON.COM.AU

MADE IN CHINA